



**PORTERS ESTATE AGENTS**  
RESIDENTIAL SALES, LETTINGS & MANAGEMENT

**ANDREW CROFT & CO**  
SOLICITORS & NOTARY PUBLIC



240 Balham High Road  
London SW17 7AW  
Tel: 020 8772 1004  
[www.portersbalham.com](http://www.portersbalham.com)  
[info@portersbalham.com](mailto:info@portersbalham.com)  
DX: 41604 Balham



## NETHERFIELD ROAD, SW17

Approx. Gross Internal Floor Area

876 Sq. ft/81.38 Sq. m

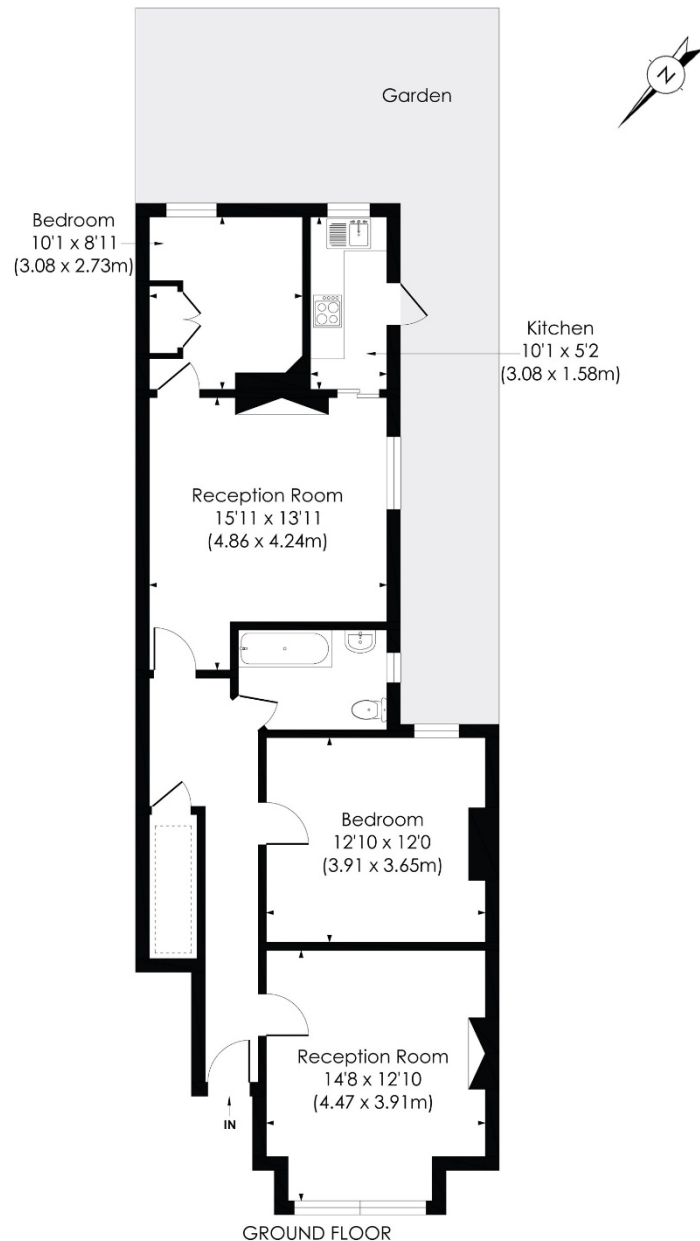

# 23 Netherfield Road Tooting Bec SW17 8AZ

An exciting opportunity to acquire this spacious two/three-bedroom garden flat requiring modernisation. This ground floor maisonette benefits from separate reception room, two/three bedrooms, fitted kitchen to the rear and private rear garden.

Netherfield Road is located off Tooting Bec Road, within a short walk of Tooting Bec tube (Northern line), and Tooting Common.

- Ground Floor Purpose Built Flat
- Two/three Bedrooms
- Separate Reception Room
- Kitchen
- Spacious Bathroom
- Private Rear Garden
- No Chain
- Requires Modernisation
- Exciting Opportunity
- No chain involved
- Council Tax Band D - Wandsworth