

PRICE GUIDE
£625,000 -£650,000



House - Semi-Detached (EPC Rating: D)

28 VALLEY DRIVE, LONDON, KINGSBURY,
NW9 9NP
Price Guide
£625,000



HAYMILLS
Expertise Experience Engagement



3



1



1



D

3 Bedroom House - Semi-Detached located in London

£625,000 - £650,000 price guide - LOOKING FOR A PROJECT! Rare chance to buy a house IN NEED OF MODERNISING on one the best and much sought after roads in Kingsbury. 3 bedroom semi with through lounge and with a garage approached via own drive. Ideal to extend to side, rear and loft! The property has a through lounge, guest cloakroom, family bathroom and a good size rear garden. To be sold as seen and with no upper chain. Keys in office for immediate viewings.



Valley Drive NW9

Approximate Gross Internal Area
1668 sq ft - 155 sq m

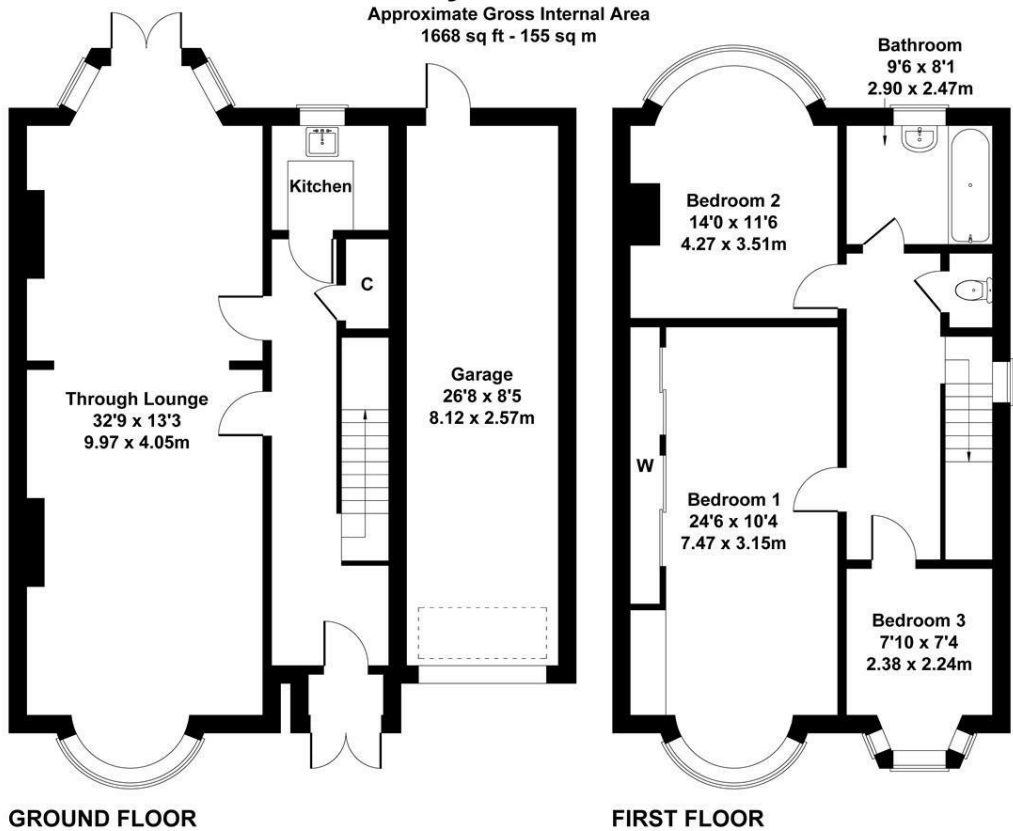

Not to Scale. Produced by The Plan Portal 2025
For Illustrative Purposes Only.

Council Tax Band

E

Energy Performance Graph

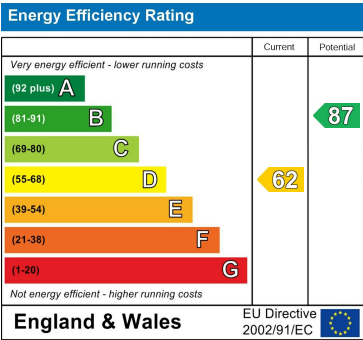

Call us on
0208 904 8822
info@haymills.uk

Agents Note: Whilst every care has been taken to prepare these particulars, they are for guidance purposes only. All measurements are approximate and are for general guidance purposes only and whilst every care has been taken to ensure their accuracy, they should not be relied upon and potential buyers are advised to recheck the measurements.



HAYMILLS
Expertise Experience Engagement