



## 14 Bailey Close

Kibworth Harcourt, Leicester, LE8 0XG

Asking Price £300,000

Situated in the desirable Harcourt Gardens development in Kibworth Harcourt, this attractive three-bedroom semi-detached home combines modern comfort with the charm of village living. Built in 2018 by the acclaimed Mulberry Homes, creating an excellent opportunity for first-time buyers or those looking to move up the property ladder. Quietly positioned in a tucked-away cul-de-sac, the property features a light and airy open-plan living and dining space with French doors that open onto a west-facing garden, a sleek kitchen/diner fitted with high-gloss cabinetry, quality Bosch appliances and a four-ring gas hob, along with a contemporary family bathroom and a ground floor WC. The enclosed rear garden offers both a patio and lawn for easy outdoor enjoyment, while a driveway for two cars, side access and a part-boarded loft add to the home's practicality. This is a property that blends style, convenience and location in perfect harmony. This property is also available on a 50% Shared ownership basis.

- Ideal first time purchase
- Ideally situated
- Built by Mulberry homes
- Three good sized bedrooms
- Stylish Property
- No Chain
- Must be seen

### Viewing

Please contact our Berkley Leicester Office on 0116 2544755 if you wish to arrange a viewing appointment for this property or require further information.



3



1



1



B



Floor Plan

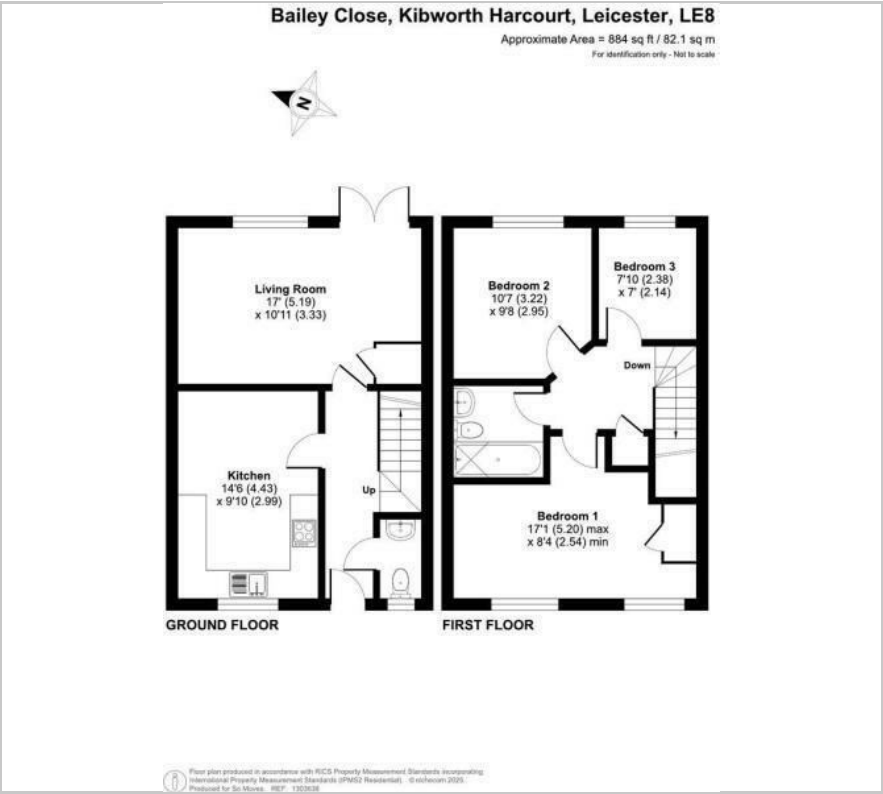

Area Map



Energy Efficiency Graph

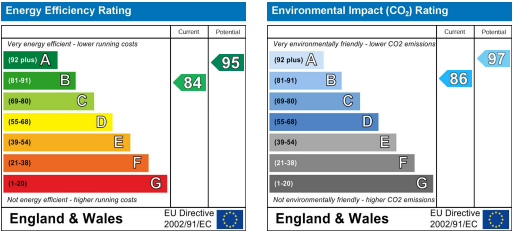

These particulars, whilst believed to be accurate are set out as a general outline only for guidance and do not constitute any part of an offer or contract. Intending purchasers should not rely on them as statements of representation of fact, but must satisfy themselves by inspection or otherwise as to their accuracy. No person in this firms employment has the authority to make or give any representation or warranty in respect of the property.