



This detached bungalow is situated within a popular location and benefits from a spacious living room, kitchen/breakfast room, 2 bedrooms, en-suite to main bedroom and a bathroom, along with an enclosed garden.

Available: 25th October 2025

Furnishing: Unfurnished

Council Tax: C

Holding Deposit: £195.00

Damage Deposit: £978.00

No pets

No smokers

Situation:

North Walsham is a historic market town and is known for its rich heritage, dating back to Anglo-Saxon times, and its proximity to both the Norfolk Broads and the North Norfolk coast. The town offers a variety of shops, restaurants and cafes together with both primary and secondary schools.

Directions:

From the Market Place on foot, walk down Market Street and proceed straight over at the crossroads onto Cromer Road. The property will be found after a short distance on the right hand side.

EPC rating: D/60

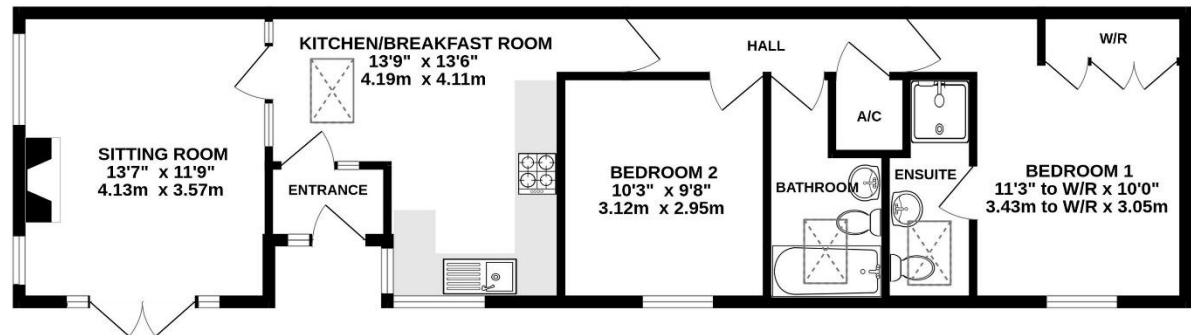

TOTAL FLOOR AREA: 720 sq.ft. (66.9 sq.m.) approx.

Whilst every attempt has been made to ensure the accuracy of the floorplan contained here, measurements of doors, windows, rooms and any other items are approximate and no responsibility is taken for any error, omission or mis-statement. This plan is for illustrative purposes only and should be used as such by any prospective purchaser. The services, systems and appliances shown have not been tested and no guarantee as to their operability or efficiency can be given.
Made with Metropix ©2025

Dereham Office

37 Quebec Street, Dereham, NR19 2DJ

01362 696895

post@parsonsandcompny.co.uk

PARSONS
&
COMPANY

Reepham Office

Market Place, Reepham, NR10 4JJ

01603 870473

info@parsonsandcompny.co.uk