

PARSONS  
COMPANY



9 The Street, Bintree, Norfolk., NR20 5AH  
£325,000



## 9 The Street, Bintree, Norfolk., NR20 5AH

**£325,000**

A spacious 4 bedroom detached house situated in the sought after village location of Bintree. The property boasts a separate entrance hall, living room with double doors that open onto a separate dining room. Further on, there is a fitted kitchen that is complemented with an adjacent utility room. No onward chain!

Upstairs, there are the 4 bedrooms that are serviced by a family bathroom, with bedroom one benefitting from a en-suite shower room.

Outside to front is a shared driveway leading to a garage with power & lighting. To the rear, is a generous L-shaped plot with laid to lawn grass and patio area.

This property is offered with no onward chain.

For room measurements please click on the floor plan option.

### Situation

Bintree is a small, attractive village located just 9 miles from the market town of Fakenham, 15 miles from Norwich and within approximately 30 minutes' drive from the popular North Norfolk



## Description



## Situation



null

Council Tax Band: D

Available:

# Floor Plans

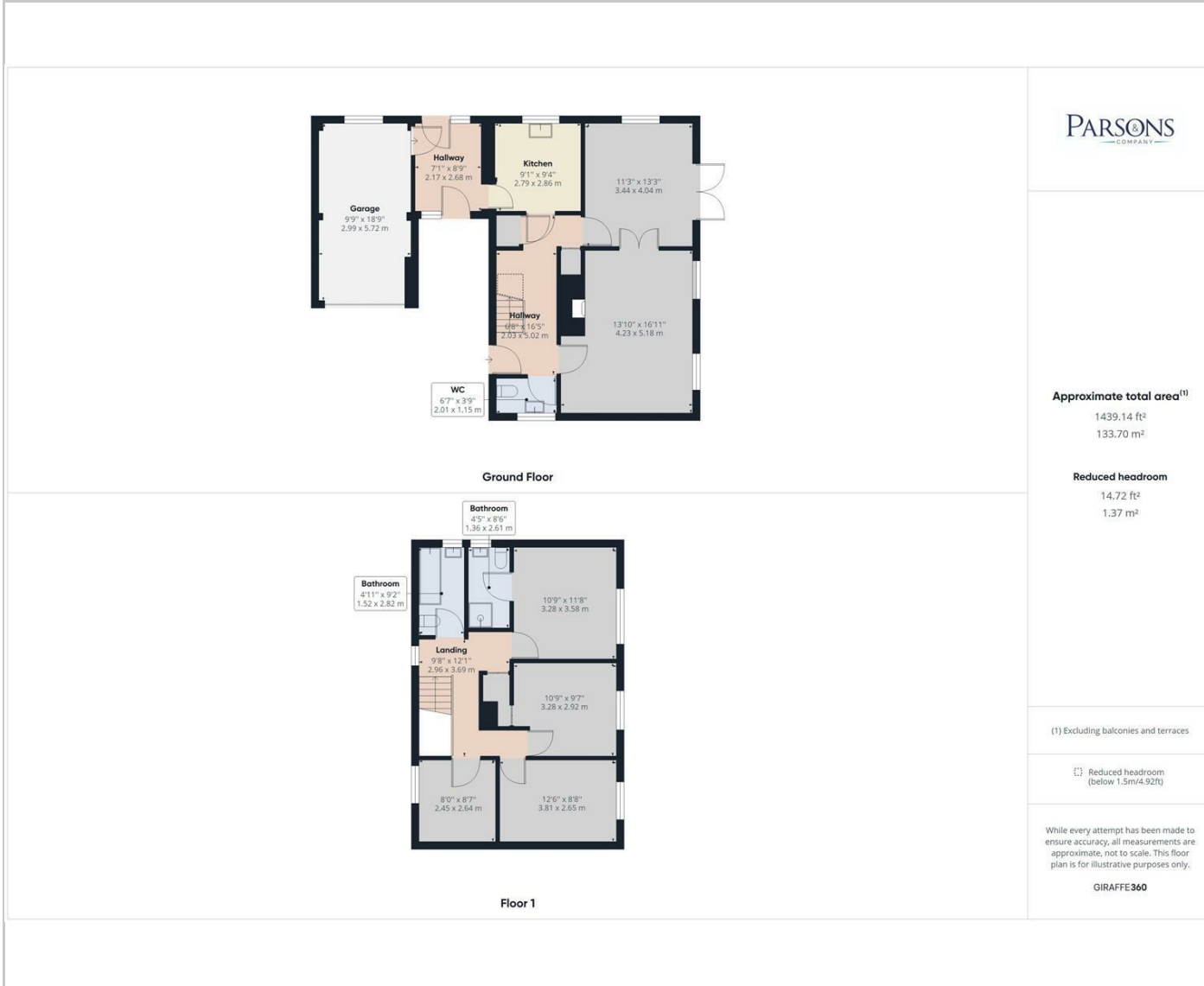

# Area Map

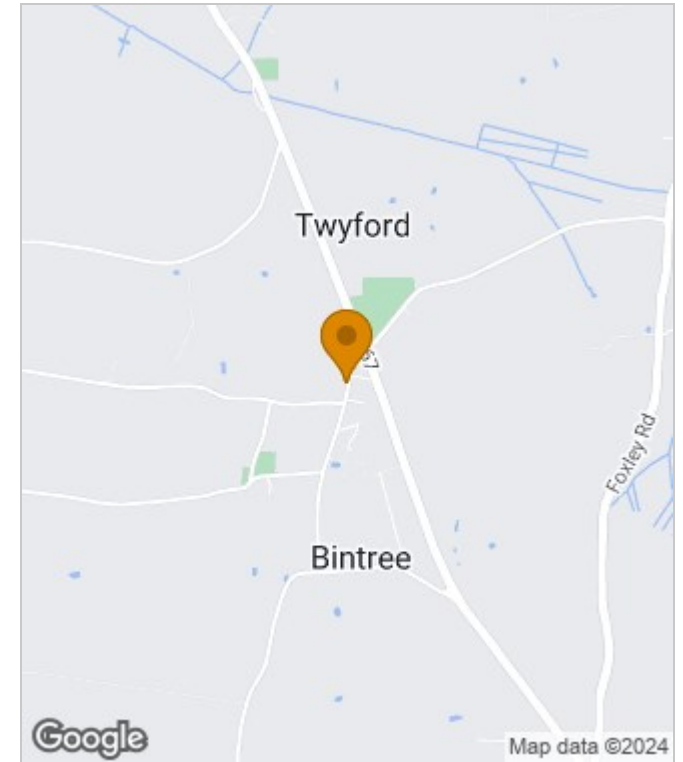

# Energy Performance Graph

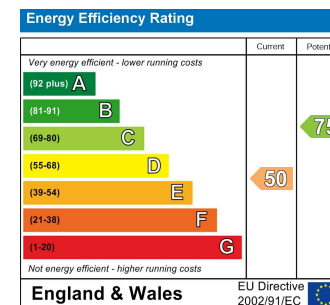

These particulars, whilst believed to be accurate are set out as a general outline only for guidance and do not constitute any part of an offer or contract. Intending purchasers should not rely on them as statements of representation of fact, but must satisfy themselves by inspection or otherwise as to their accuracy. No person in this firm's employment has the authority to make or give any representation or warranty in respect of the property.

Market Place Reepham, Norfolk, NR10 4JJ  
Tel: 01603 870473 Email: info@parsonsandcompany.co.uk parsonsandcompany.co.uk