



Stirling House Skylon Central, Hereford, Herefordshire, HR2 6JH

£7,840 (From) Per Calendar Month

jackson
property

- Modern Ground Floor Office Suite - 560 square feet
- Approximately 3.5 miles South East of Hereford City Centre
- Access off B4399 The Straight Mile
- M50 Approx 12 miles via A49
- Offices are Fully Fitted and Decorated
- Electric Car Charging Points & Air Conditioning
- CCTV, Alarm and Access Control System
- Designated Parking and Visitor Spaces

Location

Centenary Park is a scheme of brand new high specification office suites adjacent to the existing Skylon Park, part of Hereford's Enterprise Zone, situated approximately 3.5 miles south east of Hereford City Centre. The M50 Motorway is approximately 12 miles distance via the A49.

Enterprise Zone

Centenary Park is located on a 100 acre Enterprise Zone named Skylon Park. For further information regarding the potential benefits of being located within the zone or to discuss any potential help that your business may require, please visit: www.skylonpark.co.uk

Accommodation

Suite 7 is situated on the ground floor, having a road facing frontage. The shape of the suite is rectangular with window on the one side.

Specification

- / Fully fitted and decorated
- / Solar reflective glazing
- / LED+ Lighting
- / Air conditioning providing heating and cooling
- / Ceiling heights up to 2700mm
- / Designated parking and visitor spaces
- / Electric car charging points
- / Covered Cycle storage
- / CCTV, Alarm and Access Control System
- / EPC Rating B

Services

Mains electricity, water and drainage are to be provided to each block together with ducts for telephone and broadband. Superfast broadband has been provided across Skylon Park and interested parties should check with the relevant provider to confirm broadband speeds.

Service Charge

The service charge is £3.22 per square foot per annum and is payable to the management company.

The service charge covers internal and external maintenance such as cleaning, decoration, waste management, landscaping, building repairs, along with communal staff costs and communal electricity.

Further details are available via the agents.

Business rates

Business rates are to be checked on an individual basis.

VAT

All prices quoted are subject to the addition of VAT.

Important Notice

1. Particulars: These particulars are not an offer or contract, nor part of one. You should not rely on statements by Harris Lamb and

Jackson Property in the particulars or by word of mouth or in writing ("information") as being factually accurate about the property, its condition or its value. Neither Harris Lamb and Jackson Property nor any other agent has any authority to make any representations about the property, and accordingly any information given is entirely without responsibility on the part of the agents, seller(s) or lessor(s).
 2. Photos etc.: The photographs show only certain parts of the property as they appeared at the time they were taken. Areas, measurements and distances given are approximate only.
 3. Regulations etc.: Any reference to alterations to, or use of, any part of the property does not mean that any necessary planning, building regulations or other has been obtained. A buyer or lessee must find out by inspection or in other ways that these matters have been properly dealt with and that all information is correct.





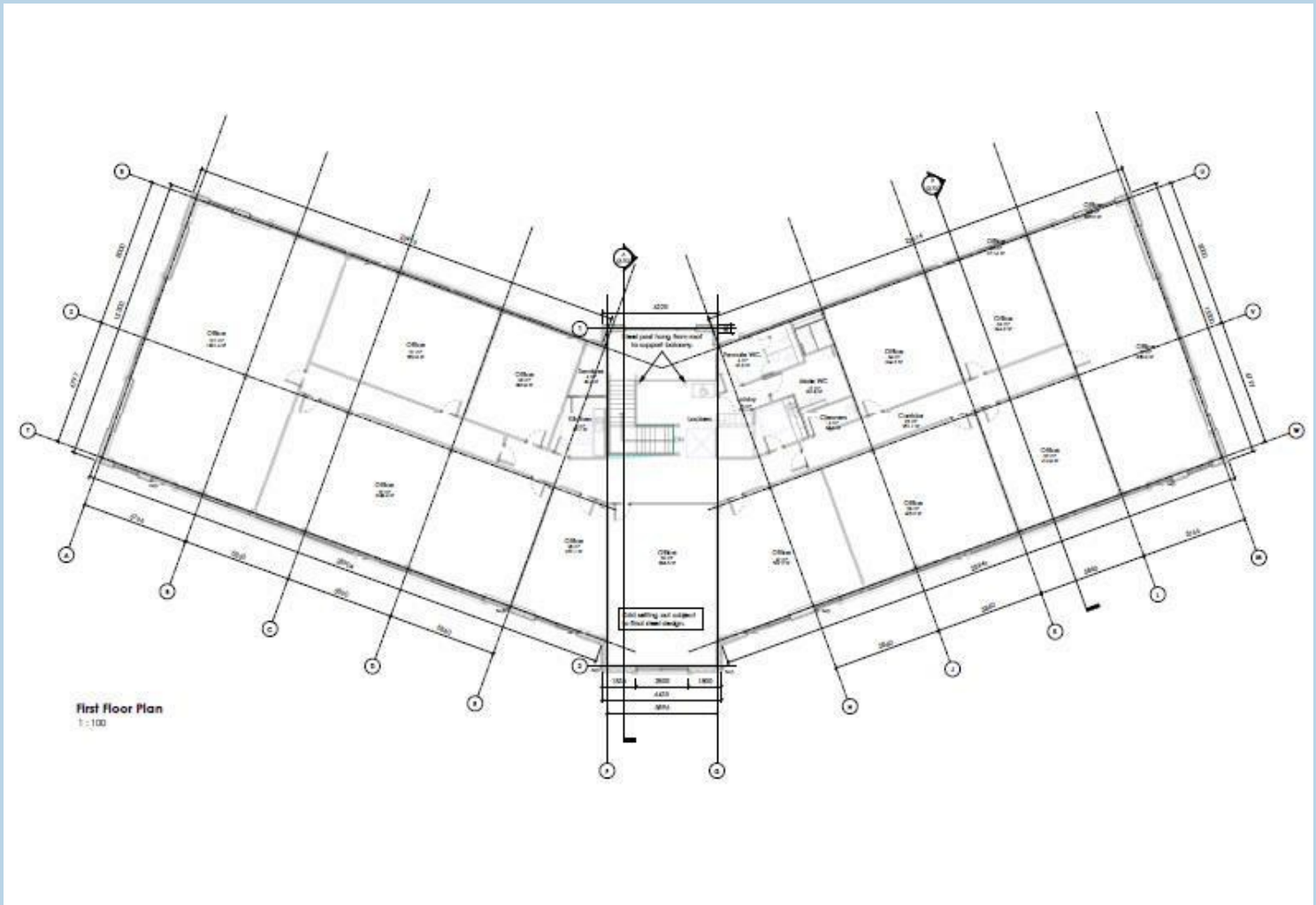

Energy Efficiency Rating		Environmental Impact (CO ₂) Rating	
	Current	Potential	
Very energy efficient - lower running costs			Very environmentally friendly - lower CO ₂ emissions
(92 plus) A			(92 plus) A
(81-91) B			(81-91) B
(69-80) C			(69-80) C
(55-68) D			(55-68) D
(39-54) E			(39-54) E
(21-38) F			(21-38) F
(1-20) G			(1-20) G
Not energy efficient - higher running costs			Not environmentally friendly - higher CO ₂ emissions
England & Wales	EU Directive 2002/91/EC		England & Wales

Jackson Property may be entitled to commission from other services offered to the Client or a buyer including but not only the following services: Conveyancing, Mortgage, Financial advice, Surveys etc. An average referral fee is defined as £100+vat.