



43 Highhouse View, Auchinleck

Offers Over £180,000

🛏 3 🚿 1 🚗 1



- Modern Detached Bungalow
- Three Double Bedrooms
- Practical Utility Room
- Versatile Conservatory
- Convenient Single-Level Living
- Private Wraparound Gardens
- Walk-in Condition
- Driveway
- EPC Band C (75)
- Council Tax Band D



Exceptionally well-presented, three-bedroom detached bungalow situated in a popular modern residential development in Auchinleck.

Step inside to discover a welcoming entrance hall providing access to all accommodation. The bright and spacious living room creates an inviting space for relaxation and entertaining, while the modern fitted kitchen offers excellent storage solutions and workspace for everyday family life.

The property boasts three well-proportioned bedrooms, all benefiting from built-in wardrobes providing optimal storage solutions. A contemporary family bathroom completes the internal accommodation with modern fixtures and fittings.

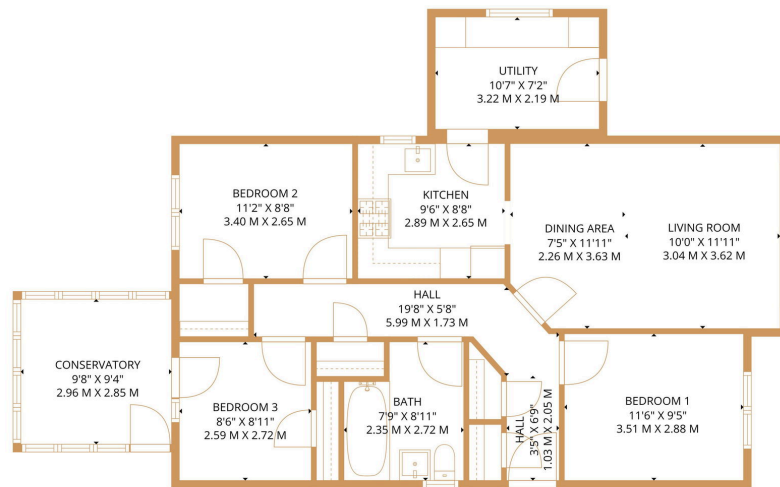

TOTAL: 915 sq. ft. 85 m2
1st floor: 915 sq. ft. 85 m2
EXCLUDED AREAS: UTILITY: 76 sq. ft. 7 m2, WALLS: 84 sq. ft. 8 m2
SIZES AND DIMENSIONS ARE APPROXIMATE. ACTUAL MAY VARY. © FLOOR WALLS MEDIA

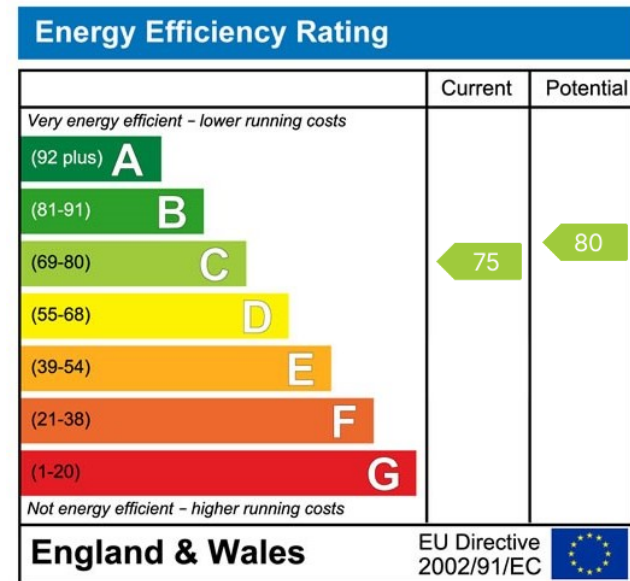

01292 437 045
office@belmontproperty.com
24 Dalmellington Road, Ayr, KA7 2PZ

belmontproperty.com

Agents Note: Whilst every care has been taken to prepare these sales particulars, they are for guidance purposes only. All measurements are approximate and for general guidance purposes only and whilst every care has been taken to ensure their accuracy, they should not be relied upon and potential buyers are advised to recheck the measurements