



Wilberforce Road, N4 2SP

Asking Price Of £550,000
Share of Freehold



Wilberforce Road

Asking Price Of £550,000

Share of Freehold

A very well presented and spacious two-bedroom apartment with lots of natural light and high ceilings. This first-floor period conversion has been beautifully presented and maintained to high specifications.

It comprises a bright reception room, good size kitchen with integrated appliances, two double bedrooms, family bathroom and ample storage, including a built-in attic space and fitted units off the entrance hallway. Large bay windows offer plenty of light, while maintaining a high level of privacy not overlooked by other properties. It comes with highly sought after off-street parking, and is sold chain free with a Share of Freehold.

Wilberforce Road is a desirable, quiet and well-located street in close proximity to shops and eateries. It is minutes' walk to Highbury Barn, Stoke Newington and four local parks. It is served by unparalleled access to Zone 2 Victoria/Piccadilly lines, Overground and National Rail and regular bus routes.

- Two Double Bedrooms
- Allocated Parking Space
- 554sqft / 51.5sqm
- Period Conversion
- Very Well Presented
- Great Location
- Share of Freehold
- Close to Good Transport Links







Wilberforce Road, N4

Approximate Gross Internal Area = 554 sq ft / 51.5 sq m

DAVID ANDREW

your most valuable asset

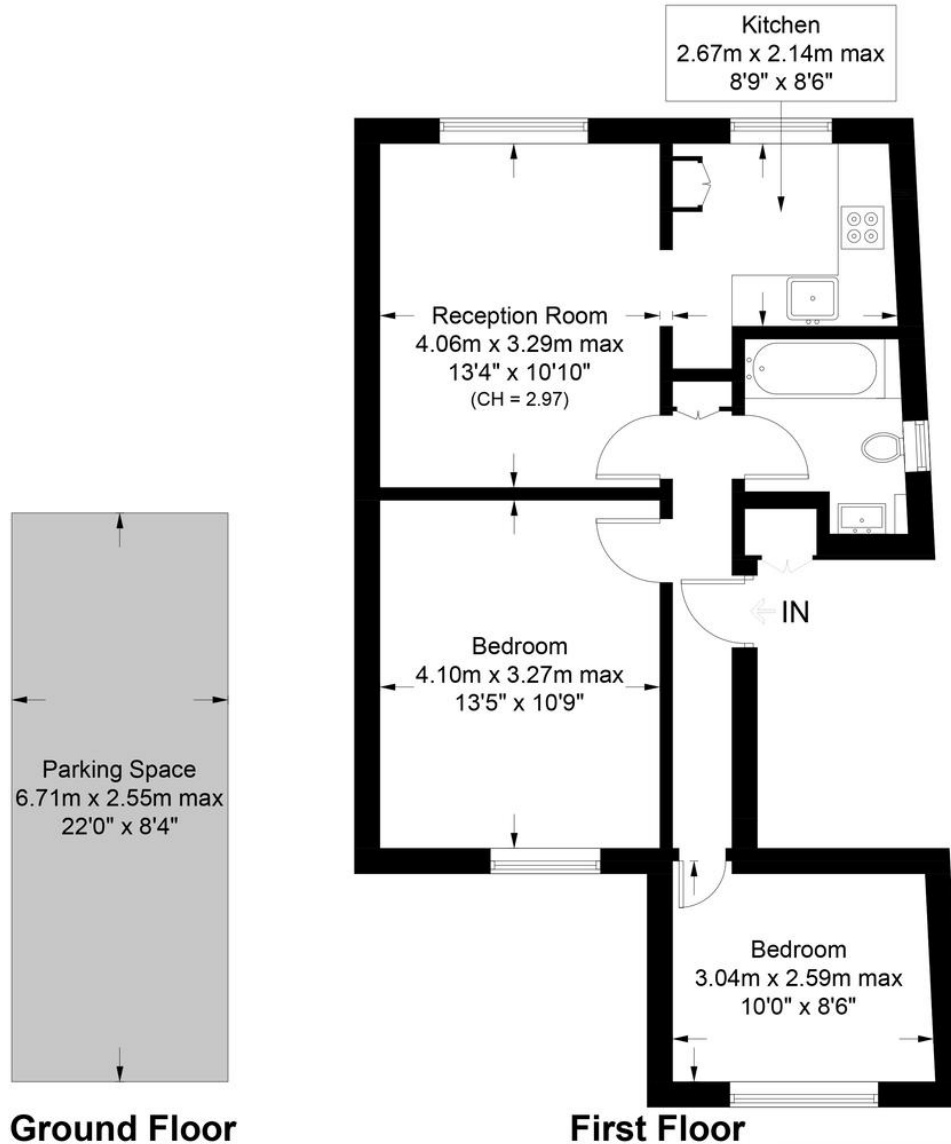

Archway Office

671 Holloway Road
London, N19 5SE

T (0)20 7619 3750

Highbury Office

90 Highbury Park
London N5 2XE

T (0)20 7354 9111

Stroud Green Office

167 Stroud Green Road
London N4 3PZ

T (0)20 7281 2000

General Contact

E info@davidandrew.co.uk



Score	Energy rating	Current	Potential
92+	A		
81-91	B		
69-80	C		75 C
55-68	D	67 D	
39-54	E		
21-38	F		
1-20	G		

Agent's Note:

Whilst Care has been exercised in the preparation of these sales particulars, statements about the property must not be relied upon as representations of statements or fact. Prospective purchasers must make and rely upon their own enquiries and those of professional representatives. The company accept not liability for any error contained in these particulars.



Certified Property Measurer

This plan is for layout guidance only. Not drawn to scale unless stated. Windows and door openings are approximate. Whilst every care is taken in the preparation of this plan, please check all dimensions, shapes and compass bearings before making any decisions reliant upon them. (ID1057141)

DAVID ANDREW your most valuable asset

