

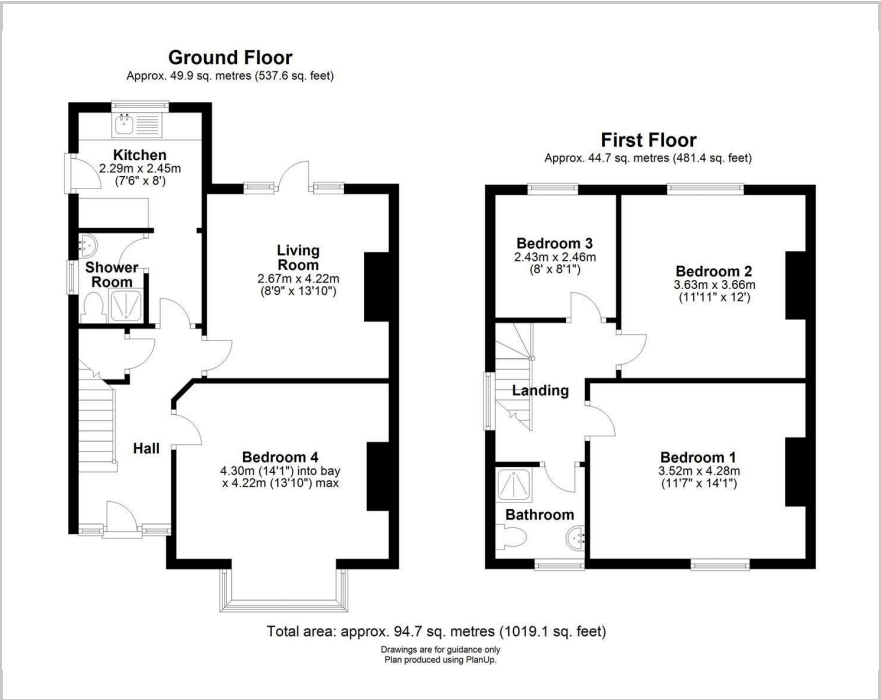

46 Leys Avenue, Cambridge, CB4 2AW
£1,950 Per month



Floor Plan



Area Map

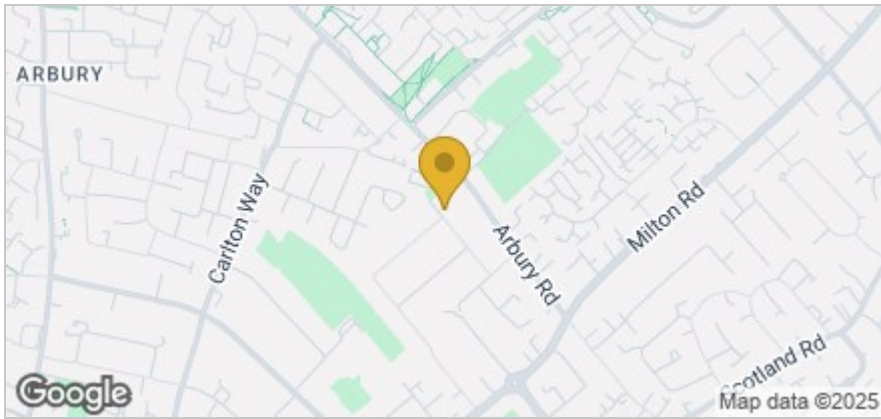

These particulars, whilst believed to be accurate are set out as a general outline only for guidance and do not constitute any part of an offer or contract. Intending purchasers should not rely on them as statements of representation of fact, but must satisfy themselves by inspection or otherwise as to their accuracy. No person in this firms employment has the authority to make or give any representation or warranty in respect of the property.

154-156 Victoria Road, Cambridge, CB4 3DZ
Tel: 01223 439 888 Email: theteam@grayandtoynbee.com

Accommodation

- Perfect for sharers
- Four double bedrooms
- Unfurnished
- Off-road parking

A substantial four-bedroom semi-detached house, perfect for a group of sharers, located in a quiet street on the north side of Cambridge offering easy access to the Science and Business parks.

On the ground floor is a large double bedroom/reception room to the front, a dining room with doors opening to the rear garden, a downstairs shower room with a toilet, and kitchen with side access. On the first floor are three further bedrooms, all doubles, and another shower room.

Further, the property benefits from off-roading parking to the front and a large garden to the rear laid predominantly to lawn.

Available unfurnished.

Council tax band D. EPC rating D

///itself.transmitted.vocal

Viewing

Please contact our Gray & Toynbee - Cambridge Office on 01223 439 888 if you wish to arrange a viewing appointment for this property or require further information.

Energy Efficiency Graph

