



124 Sedgwick Street, Cambridge, CB1 3AL
£1,950 Per month



Floor Plan

Ground Floor
Approx. 34.1 sq. metres (367.1 sq. feet)



First Floor
Approx. 28.9 sq. metres (311.0 sq. feet)



Second Floor
Approx. 12.0 sq. metres (129.5 sq. feet)

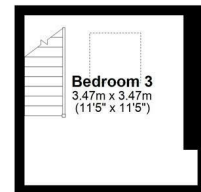

Total area: approx. 75.0 sq. metres (807.6 sq. feet)

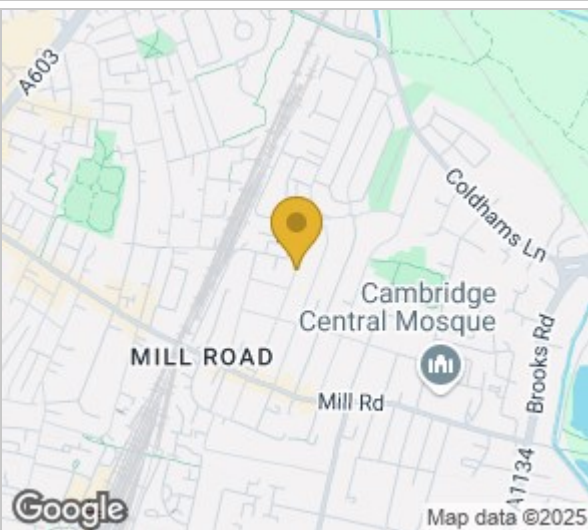

Energy Efficiency Rating		
	Current	Potential
Very energy efficient - lower running costs		
(92 plus) A		
(81-91) B		
(69-80) C		
(55-68) D		
(39-54) E		
(21-38) F		
(1-20) G		
Not energy efficient - higher running costs		
England & Wales	EU Directive 2002/91/EC	

Accommodation

- City centre location
- Unfurnished
- Available immediately
- Fantastic garden

A charming three-bedroom mid-terrace property situated in the heart of Mill Road, offering period features and an excellent opportunity for tenants seeking vibrant City Centre living.

Upon entry, there is a spacious open-plan living and dining area, freshly decorated while retaining character features such as oak flooring and a fireplace. The extended kitchen is well-equipped with a double oven, gas hob, dishwasher, washing machine, and integrated separate fridge and freezer units.

On the first floor, the property offers a generous primary double bedroom to the front, a single bedroom to the rear, and a well-appointed bathroom with a shower over the bath, heated towel rail, w/c, sink, and sash window.

The loft has been converted to provide a further double bedroom, complete with a skylight and built-in cupboard storage.

Externally, there is a large and well-maintained rear garden.

Available immediately on an unfurnished basis, the property is ideal for a couple or small family.

EPC Rating: E Council Tax Band: C

///pits.payer.expand



Cambridge Office: 154-156 Victoria Road, Cambridge, CB4 3DZ Waterbeach Office: 17 High Street, Waterbeach, CB25 9JU
Tel: 01223 439 888 Email: theteam@grayandtoynbee.com Tel: 01223 949 444 Email: waterbeach@grayandtoynbee.com

These particulars, whilst believed to be accurate are set out as a general outline only for guidance and do not constitute any part of an offer or contract. Intending purchasers should not rely on them as statements of representation of fact, but must satisfy themselves by inspection or otherwise as to their accuracy. No person in this firm's employment has the authority to make or give any representation or warranty in respect of the property.

GRAY TOYNBEE