

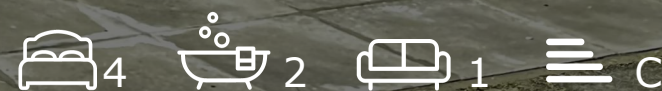

27 Priory Avenue, Cambridge, CB24 4RY
£1,795 Per month

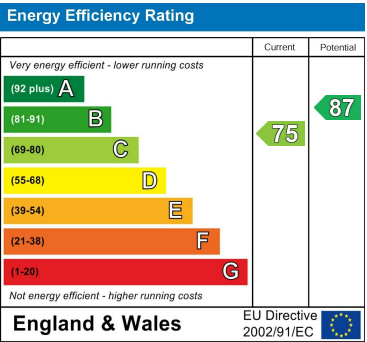

Floor Plan

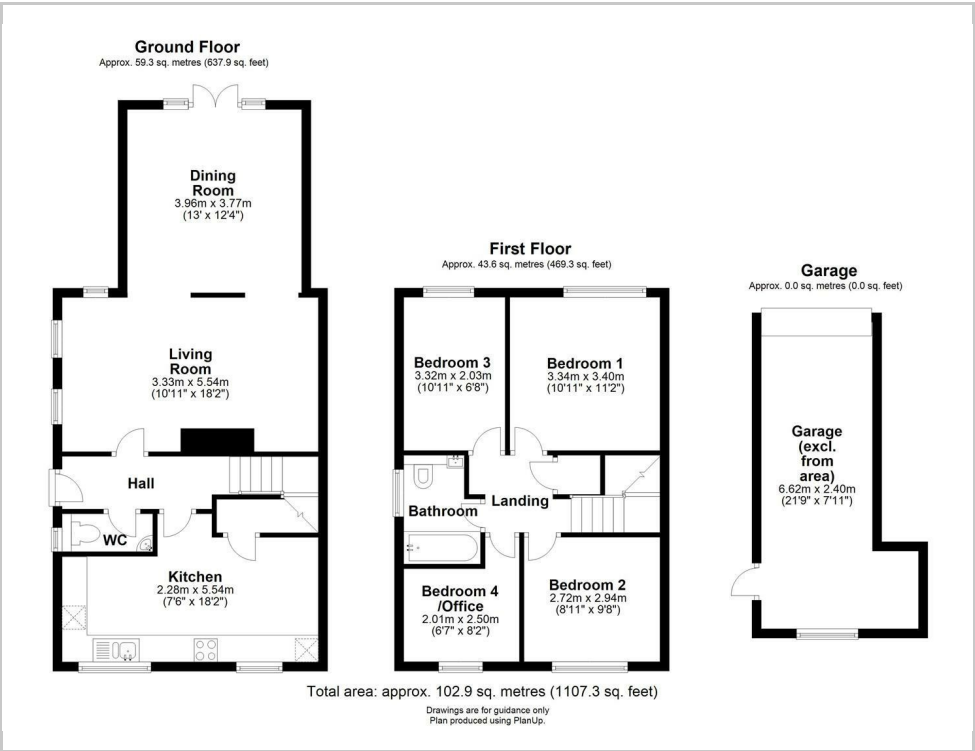

Accommodation

- Recently renovated
- Four bedrooms
- EPC rating C

A superbly renovated and extended four-bedroom, semi-detached property located in the highly desirable village of Swavesey.

On the ground floor, there is a large living and dining space, cleverly extended to offer two distinct spaces while maintaining a very light feel. There are doors directly to the garden from the dining area and a stylish electric fire in the living room.

The kitchen has been modernised and has handleless cupboards, a free-standing fridge freezer, dishwashing, a washer/dryer, an integrated gas hob, and an electric oven. There is plenty of storage as well as a pantry cupboard. There is also a downstairs cloakroom.

Upstairs, which has been newly decorated and carpeted throughout, has four bedrooms and a family bathroom. The primary bedroom is a large double, two bedrooms are doubles and the final single bedroom would make an excellent office or nursery.

Outside there is a low maintenance rear garden, partly paved to patio and partly lawn. There is a single garage perfect for additional storage, and at least two off-road parking spaces to the front of the property.

Swavesey is a very popular village with excellent primary and secondary schools and offers an easy commute to Cambridge.

Council tax band: D EPC: C

///refreshed.flickers.between

Viewing: Please contact our Gray & Toynbee - Cambridge Office on 01223 439 888 if you wish to arrange a viewing appointment for this property or require further information.



Cambridge Office: 154-156 Victoria Road, Cambridge, CB4 3DZ Waterbeach Office: 17 High Street, Waterbeach, CB25 9JU
Tel: 01223 439 888 Email: theteam@grayandtoynbee.com Tel: 01223 949 444 Email: waterbeach@grayandtoynbee.com

These particulars, whilst believed to be accurate are set out as a general outline only for guidance and do not constitute any part of an offer or contract. Intending purchasers should not rely on them as statements of representation of fact, but must satisfy themselves by inspection or otherwise as to their accuracy. No person in this firm's employment has the authority to make or give any representation or warranty in respect of the property.

