



26 Kings Court South

Chelsea Manor Gardens, London, , SW3 5EG

Asking Price Of £890,000

Property Summary

A beautiful and spacious two bedroom flat is located on the second floor in a well-maintained purpose-built block offering comfortable living space. The flat comprises a bright reception room, spacious master bedroom with king-size bed and ensuite shower room, further double guest bedroom, along with an additional separate WC/guest bathroom and modern fully



Kings Court South Chelsea, London SW3

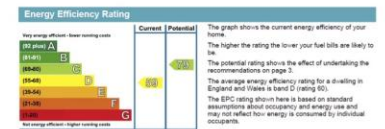
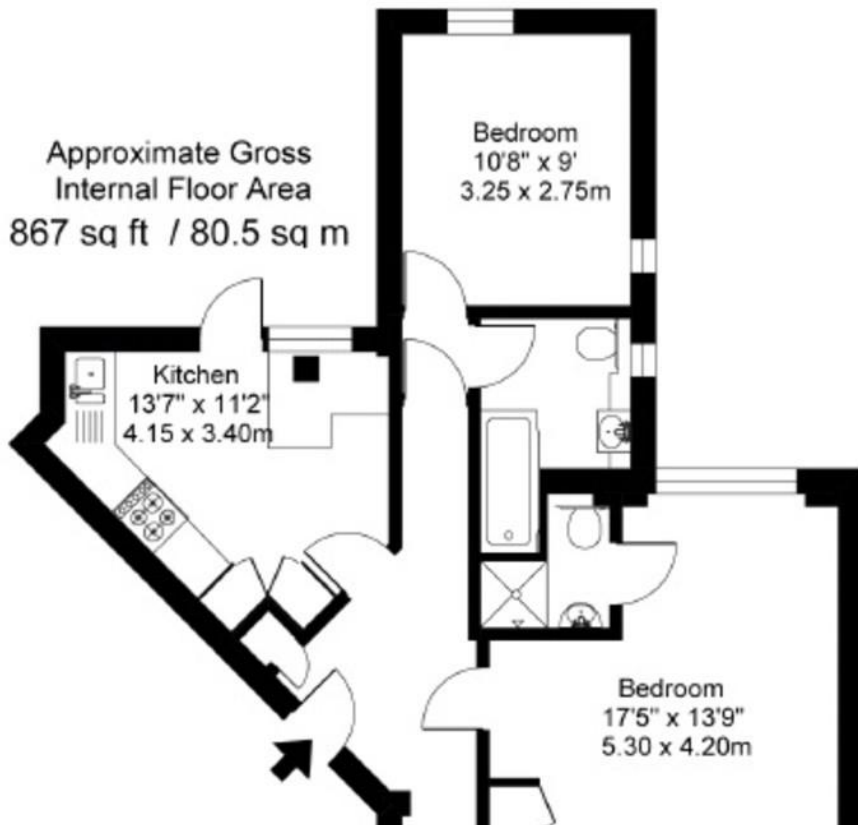

- Reception Room
- Kitchen
- Master bedroom
- En-Suite Master Bathroom
- 2nd Bedroom
- 2nd Bathroom
- Great Storage
- Caretaker
- Lift
- Communal Gardens

52 Grosvenor Gardens, London, SW1W 0AU E: info@primeportfolio.com

www.primeportfolio.com T: +44 20 7409 0209



These particulars and the descriptions and measurements herein do not constitute an offer or contract and whilst our best efforts have been made to ensure their accuracy, this cannot be guaranteed. Purchasers or lessees must satisfy themselves by inspection or otherwise as to the correctness of each of the statements contained in these particulars. No warranty is given by the Agents or the Vendors or Lessors in relation to these particulars.

Prime Portfolio Ltd Registered in England No. 05174897 Registered Office: 14a High Street, Reigate, Surrey RH2 9AY