

**157 Woolley Lane, Hollingworth, Via Hyde, SK14 8NN**



- NO VENDOR CHAIN
- Two DOUBLE Bedrooms
- Spacious Lounge with High Ceilings
- True Kitchen/Diner
- Front & Rear Courtyard
- Neutral Decor Throughout
- Local Amenities and Transport links
- Gas Central Heating & D/G
- Council Tax Band A
- Ideal First Time Buyers/Downsizers

# 157 Woolley Lane, Hollingworth, Via Hyde, SK14 8NN

## MAIN DESCRIPTION

### \*\*\*NO VENDOR CHAIN\*\*\*

This two-bedroom terrace on Woolley Lane offers well-proportioned accommodation in the heart of Hollingworth. The property features a forecourt garden, high ceilings, and two double bedrooms, with a spacious lounge and a true kitchen/diner on the ground floor. To the rear, there is a small private courtyard and access to a communal garden, providing additional outdoor space.

Hollingworth benefits from a range of local amenities, including the Gunn Inn, shops, cafés, and scenic walking routes. The property is well placed for local transport links to Glossop, Manchester, and surrounding towns, with the M67 and wider motorway network easily accessible for commuters.

Ideal for first-time buyers, downsizers, or investors, this home combines practical living spaces with a convenient location in a well-established village.





# 157 Woolley Lane, Hollingworth, Via Hyde, SK14 8NN

## VESTIBULE

External door leading into the vestibule with a ceiling light point and internal door through to the lounge.

## LOUNGE

13' 3" x 12' 5" (4.04m x 3.78m) A generous-sized lounge with high ceilings and a uPVC double-glazed window to the front elevation. Includes a wall-mounted radiator, ceiling-light point, stop tap and meter point cupboard, and an internal door leading through to the kitchen diner.

## KITCHEN/DINER

13' 3" x 9' 3" (4.04m x 2.82m) A true kitchen/diner with a range of high and low kitchen units with contrasting work surfaces and splash back tiling. Features include an integrated electric oven, gas hob with over hob extractor fan, wall-mounted combination boiler, stainless steel sink and drainer with mixer tap, and plumbing for an automatic washing machine. Wall-mounted radiator, ceiling spotlights, under-stairs storage cupboard and a uPVC double-glazed window and an external door to the rear elevation. Stairs lead to the first-floor accommodation.

## LANDING

Stairs from the ground floor to the first-floor landing with a ceiling-light point and internal doors to the first-floor rooms.

## MAIN BEDROOM

13' 3" x 12' 5" (4.04m x 3.78m) A generous double bedroom with a uPVC double-glazed window to the front elevation, wall-mounted radiator, ceiling-light point and built-in closet.

## SECOND BEDROOM

9' 4" x 8' 0" (2.84m x 2.44m) A further double bedroom with a uPVC double-glazed window to the rear elevation, wall-mounted radiator, and ceiling-light point.



# 157 Woolley Lane, Hollingworth, Via Hyde, SK14 8NN

## BATHROOM

6' 7" x 4' 5" (2.01m x 1.35m) A three-piece suite comprising a low-level WC, bath with over-bath shower, and sink with cabinet unit. Features splash back tiling, wall-mounted radiator, ceiling spotlights, and a uPVC double-glazed window to the rear elevation.



## EXTERNAL

The property benefits from a flagged forecourt with steps to the front door, and to the rear a small private courtyard with a wooden gate and access to a communal yard.

## DESCRIPTION

The vendor has advised the following:

Property Tenure - Leasehold

Annual Ground Rent - £1.50 p.a

Leasehold Term – 999 years from 1878 – 852 remaining

EPC Rate - C

Council Tax Band Rating - A

Council – Tameside Borough Council

157 Woolley Lane, Hollingworth, Via Hyde, SK14 8NN

---

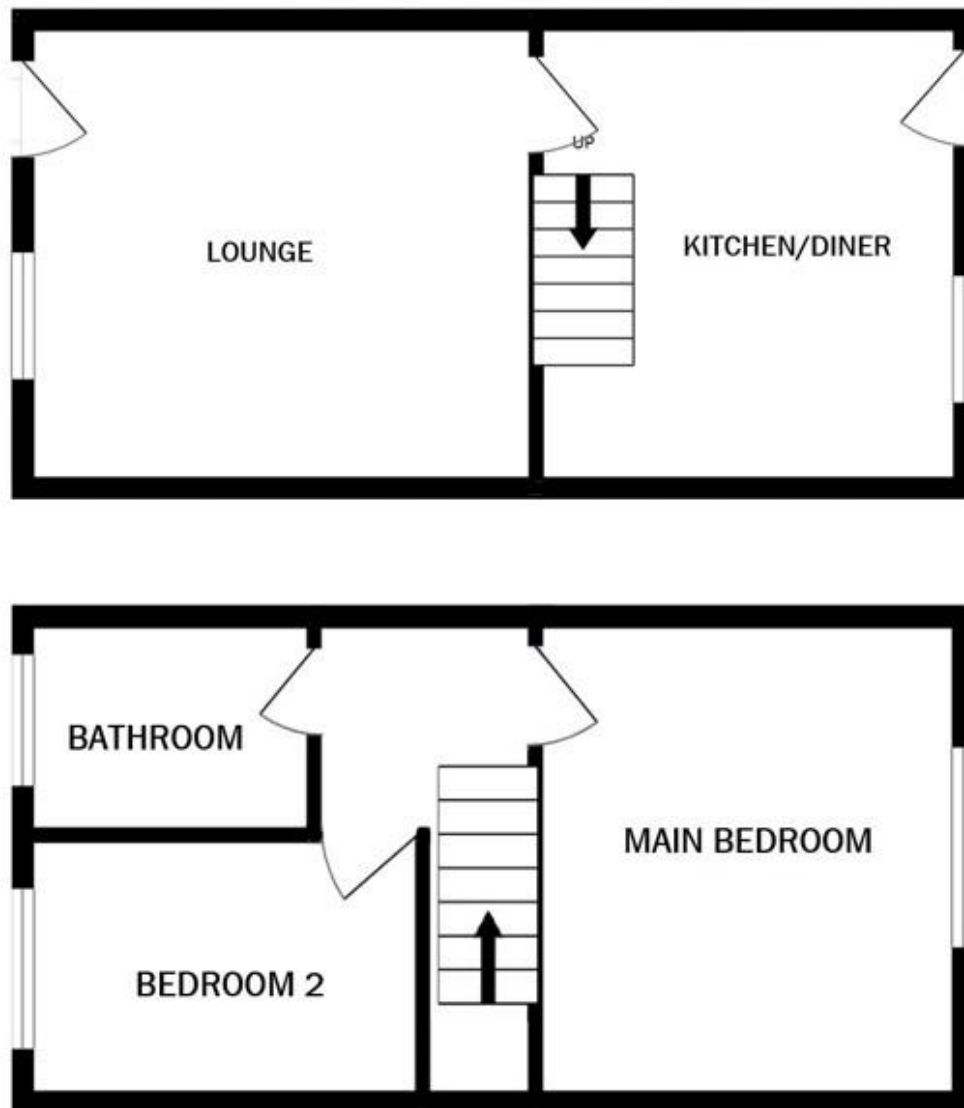

Agents Disclaimer: Stepping Stones Asset Management Ltd, their clients and employees 1: Are not authorised to make or give any representations or warranties in relation to the property either here or elsewhere, either on their own behalf or on behalf of their client or otherwise. They assume no responsibility for any statement that may be made in these particulars. These particulars do not form part of any offer or contract and must not be relied upon as statements or representations of fact. 2: Any areas, measurements or distances are approximate. The text, photographs and plans are for guidance only and are not necessarily comprehensive. It should not be assumed that the property has all necessary planning, building regulation or other consents and Stepping Stones Asset Management Ltd have not tested any services, equipment or facilities. Purchasers must make further investigations and inspections before entering into any agreement.

Purchaser information -The Money Laundering, Terrorist Financing and Transfer of Funds(Information on the Payer) Regulations 2017(MLR 2017) came into force on 26 June 2017. Stepping Stones Asset Management Ltd require any successful purchasers proceeding with a property to provide two forms of identification i.e. passport or photocard driving license and a recent utility bill or bank statement. We are also required to obtain proof of funds and provide evidence of where the funds originated from. This evidence will be required prior to Stepping Stones Asset Management removing a property from the market and instructing solicitors for your purchase.

Third Party Referral Arrangements - Stepping Stones Asset Management may have established professional relationships with third-party suppliers for the provision of services to Clients. As remuneration for this professional relationship, the agent may receive referral commission from the third-party companies. Details are available upon request.