



CLEMENTS
HABBA

For Sale

Mannock Field, Longhedge, Salisbury

£425,000

Freehold







Summary Description

New to the market is this four double bedroom detached home with a large garden, garage and off street parking, located in the popular Longhedge Village, 3 miles from Salisbury City Centre.

- Four/Five Double Bedroom House
- Downstairs Cloakroom & Utility Room
- Large Landscaped Garden
- Driveway (With Parking For Two Cars)
- EPC Rating B
- Two Bathrooms (one en-suite)
- Double Glazed Windows Throughout
- 6 Year NHBC Warranty
- Garage
- No Chain

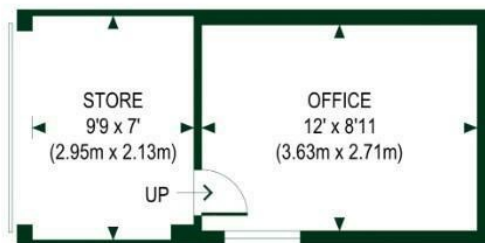

OFFICE / STORE



GROUND FLOOR



MANNOCK FIELD

APPROXIMATE GROSS INTERNAL AREA
 MAIN HOUSE = 1416 SQ FT / 131.57 SQ M
 OFFICE / STORE = 177 SQ FT / 16.39 SQ M
 TOTAL = 1593 SQ FT / 147.96 SQ M
 OUTBUILDINGS ARE NOT SHOWN IN CORRECT ORIENTATION OR LOCATION.

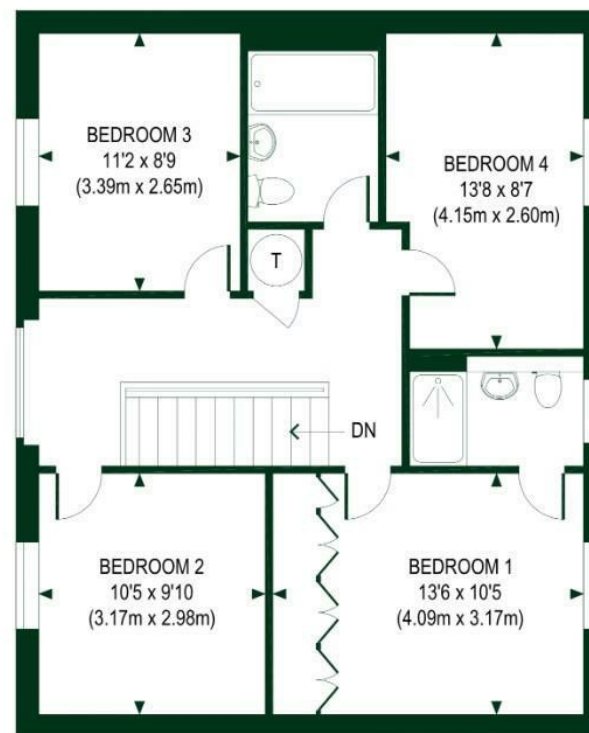

FIRST FLOOR



CLEMENTS
HABBA

FOR ILLUSTRATIVE PURPOSES ONLY
 THIS FLOOR PLAN SHOULD BE USED AS A GENERAL OUTLINE FOR GUIDANCE ONLY AND DOES NOT CONSTITUTE IN WHOLE OR IN PART AN OFFER OR CONTRACT.
 ANY INTENDING PURCHASER OR LESSEE SHOULD SATISFY THEMSELVES BY INSPECTION, SEARCHES, ENQUIRIES AND FULL SURVEY AS TO THE CORRECTNESS OF EACH STATEMENT.
 ANY AREAS, MEASUREMENTS OR DISTANCES QUOTED ARE APPROXIMATE AND SHOULD NOT BE USED TO VALUE A PROPERTY OR BE THE BASIS OF ANY SALE OR LET.



CLEMENTS
HABBA

Clements Habba Ltd.
 Building 3, Chiswick Park, 566 Chiswick High Rd,
 Chiswick, London W4 5YA