



CLEMENTS
HABBA

For Sale

Grantham Road, Chiswick, London

£1,100,000

Freehold



- Period Terrace Home
- Two Bathroom, Downstairs W.C.
- South Facing Garden
- Renovated and Extended in 2019
- Minutes from River Thames, Chiswick Rail and Bus Routes
- Four Bedroom
- Stunning Kitchen Diner
- Off Street Parking
- Garden Studio
- EPCC

THE PROPERTY

A beautifully presented four bedroom, two bathroom mid terrace Period home, with off street parking, South facing garden and a large garden studio, on a quiet residential street moments from the River Thames. EPC C

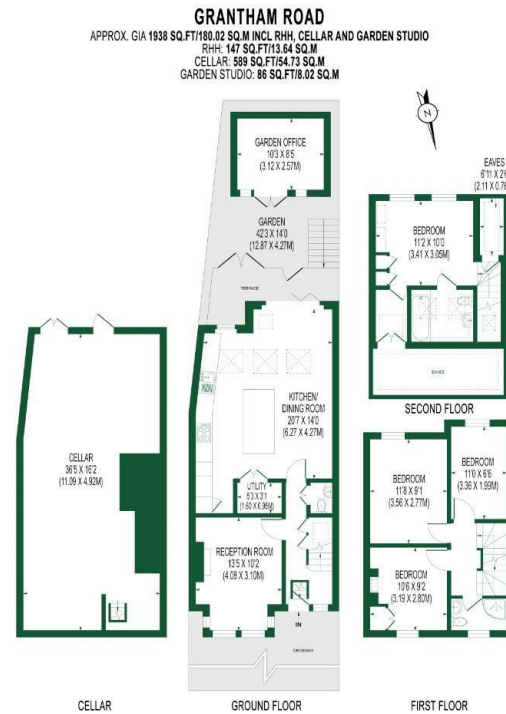

FOR ILLUSTRATION PURPOSES ONLY
THIS FLOOR PLAN SHOULD BE USED AS A GENERAL OUTLINE FOR GUIDANCE ONLY AND DOES NOT CONSTITUTE IN WHOLE OR IN PART AN OFFER OR CONTRACT.
ANY INTENDING PURCHASER OR LESSEE SHOULD VERIFY THESE FIGURES BY INSPECTION, MEASUREMENTS AND FULL SURVEY AS TO THE ACCURACY OF EACH STATEMENT.
ANY AREAS, MEASUREMENTS OR DISTANCES QUOTED ARE APPROXIMATE AND SHOULD NOT BE USED TO VALUE A PROPERTY OR BE THE BASIS OF ANY SALE OR LET.

**CLEMENTS
HABBA**



Clements Habba Ltd.
Building 3, Chiswick Park, 566 Chiswick High Rd,
Chiswick, London W4 5YA