



CLEMENTS
HABBA



For Sale

Hensler Drive, Bishopdown, Salisbury

£275,000

Freehold







Summary Description

Improved by the current owners to exacting standards, this two bedroom – two bathroom Freehold home with off street car parking is located in the sought-after Riverdown Park development, Salisbury.

- Two Bedroom Terraced House
- Downstairs Guest Cloakroom
- Designated Off Street Car Parking
- Private South West Facing Landscaped Garden
- EPC Rating B
- Two Bathrooms (One En-suite)
- Separate fully fitted Kitchen
- Large Living Room
- Rear Access
- Freehold

HENSLER DRIVE

APPROXIMATE GROSS INTERNAL AREA
TOTAL = 732 SQ FT / 68.01 SQ M

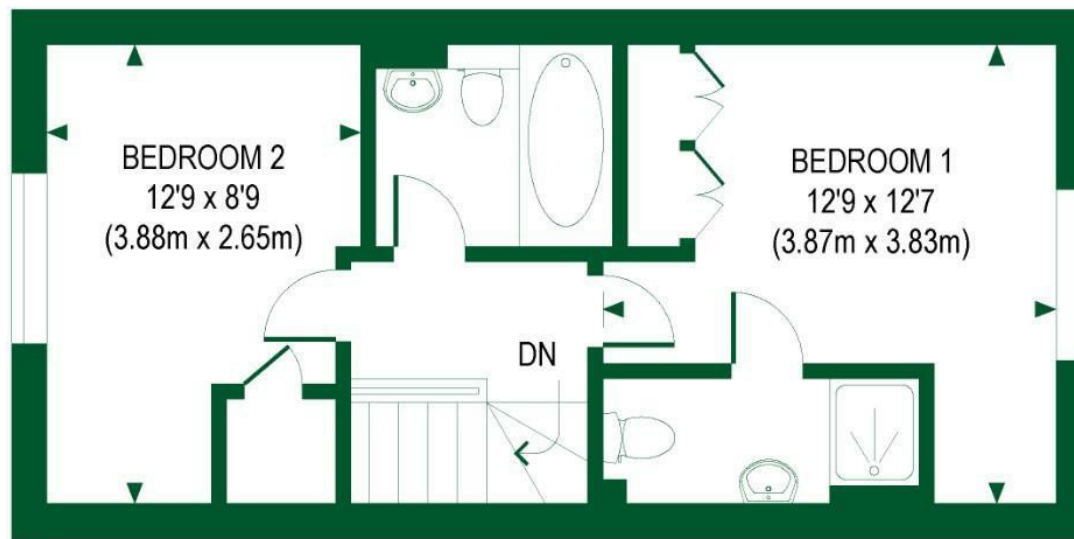

FIRST FLOOR

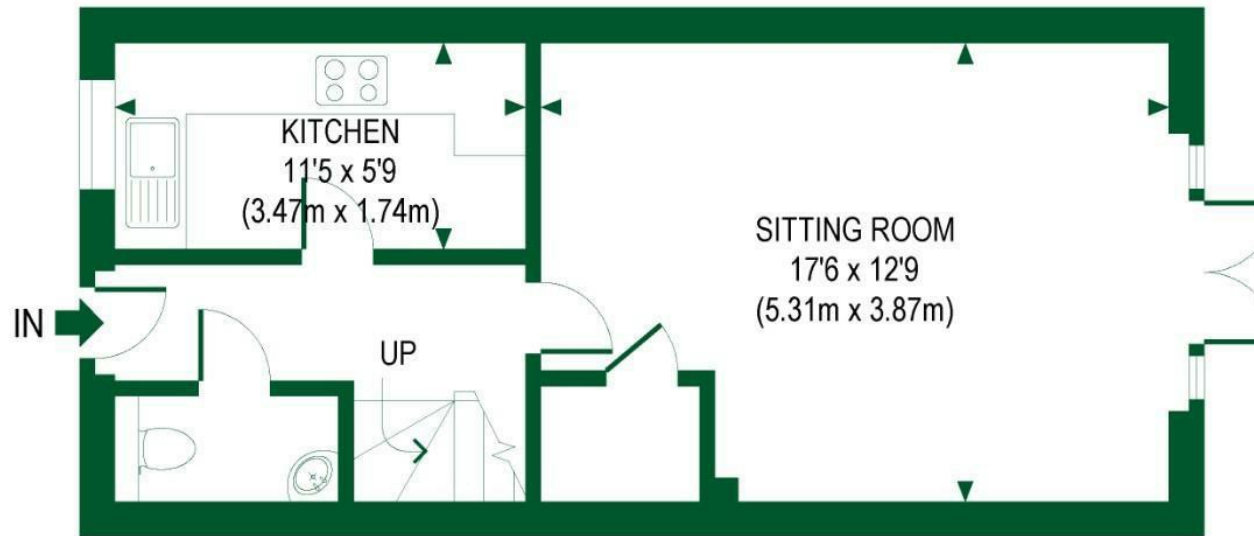

GROUND FLOOR

FOR ILLUSTRATIVE PURPOSES ONLY
THIS FLOOR PLAN SHOULD BE USED AS A GENERAL OUTLINE FOR GUIDANCE ONLY AND DOES NOT CONSTITUTE IN WHOLE OR IN PART AN OFFER OR CONTRACT.
ANY INTENDING PURCHASER OR LESSEE SHOULD SATISFY THEMSELVES BY INSPECTION, SEARCHES, ENQUIRIES AND FULL SURVEY AS TO THE CORRECTNESS OF EACH STATEMENT.
ANY AREAS, MEASUREMENTS OR DISTANCES QUOTED ARE APPROXIMATE AND SHOULD NOT BE USED TO VALUE A PROPERTY OR BE THE BASIS OF ANY SALE OR LET.