



CLEMENTS
HABBA



For Sale



Eastbury Grove, Chiswick, London

£800,000

Leasehold - Share of Freehold

- Newly Renovated Throughout
- Split Level Period Conversion
- West Facing Roof Terrace
- Private Entrance
- Share of Freehold
- Two Bedrooms, Two Bathrooms
- 982 Square Feet
- Desirable Central W4 Location
- 50 % Service Charge Liability
- EPC - D

THE PROPERTY

A beautifully presented and newly renovated, split level, two bedroom, two bathroom apartment with a sizeable west facing roof terrace and private entrance, enviably located within central Chiswick.

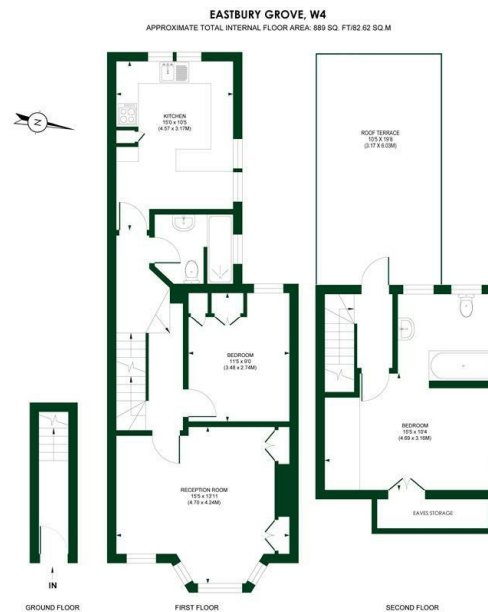

FOR ILLUSTRATION PURPOSES ONLY
THIS FLOOR PLAN SHOULD BE USED AS A GENERAL OUTLINE FOR GUIDANCE ONLY AND DOES NOT CONSTITUTE IN WHOLE OR IN PART AN OFFER OR CONTRACT.
ANY POTENTIAL PURCHASER OR LESSEE SHOULD SATISFY THEMSELVES BY INSPECTION, MEASUREMENTS AND FULL SURVEY AS TO THE CORRECTNESS OF EACH STATEMENT.
ANY AREAS, MEASUREMENTS OR DISTANCES QUOTED ARE APPROXIMATE AND SHOULD NOT BE USED TO VALUE A PROPERTY OR AS THE BASIS OF ANY LEGAL CLAIM.

