

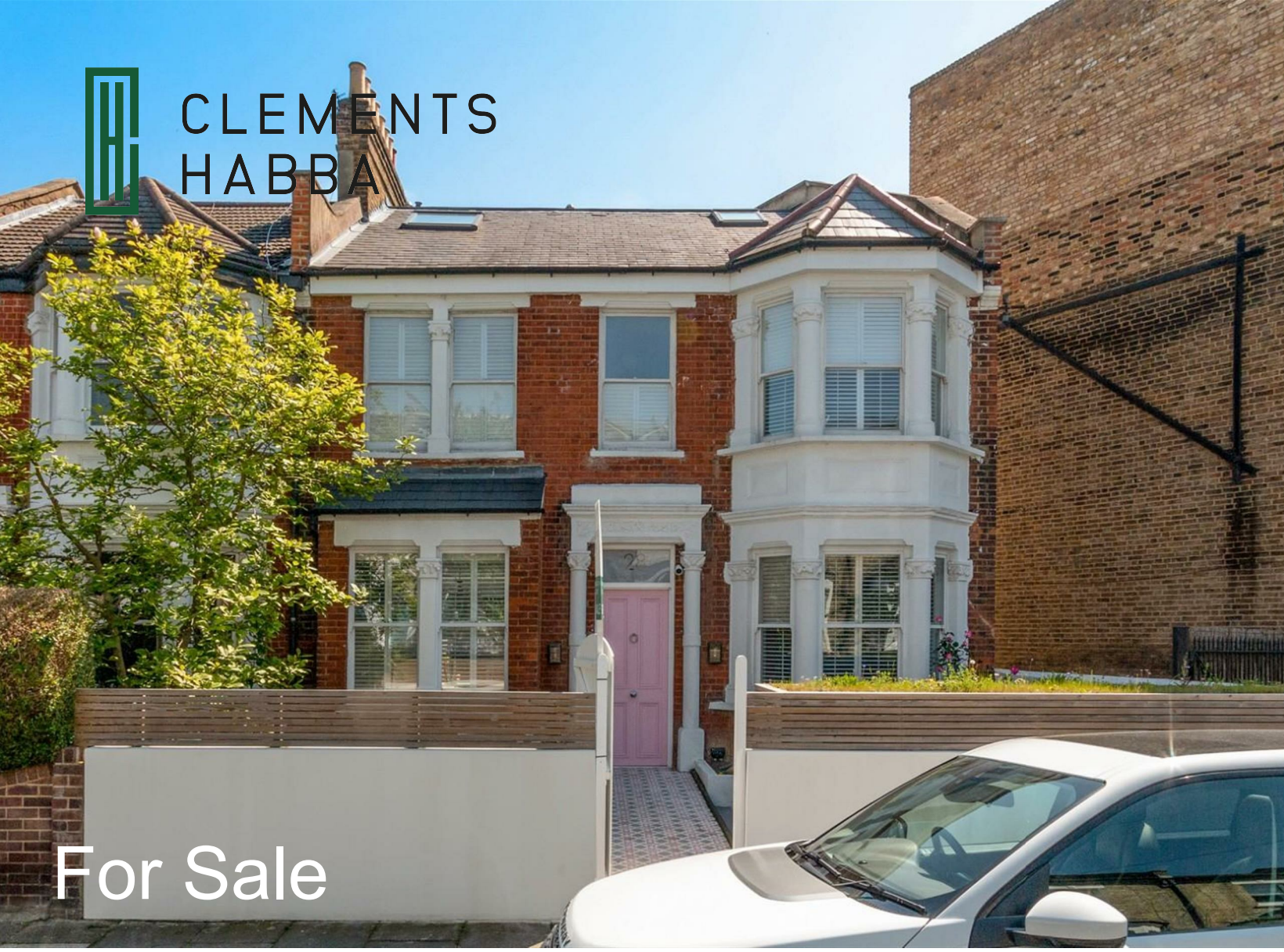

CLEMENTS  
HABBA



For Sale



Greenside Road, Ravenscourt Park, London

£1,675,000

Freehold









## Summary Description

Introducing a beautifully renovated, double fronted, four double bedroom period family home, offered in immaculate condition and showcasing innovative, thoughtful design throughout.

- Double Fronted Victorian Family Home
- Bespoke Fitted Kitchen/Dining Room
- Separate Study
- Freehold
- Council Tax Band F
- Four Bedrooms - Three bathrooms
- Front and Rear Gardens
- Utility Room
- EPC Rating D
- Ravenscourt Park

# GREENSIDE ROAD

APPROX. GIA 2081 SQ.FT/193.32 SQ.M INCL. EAVES

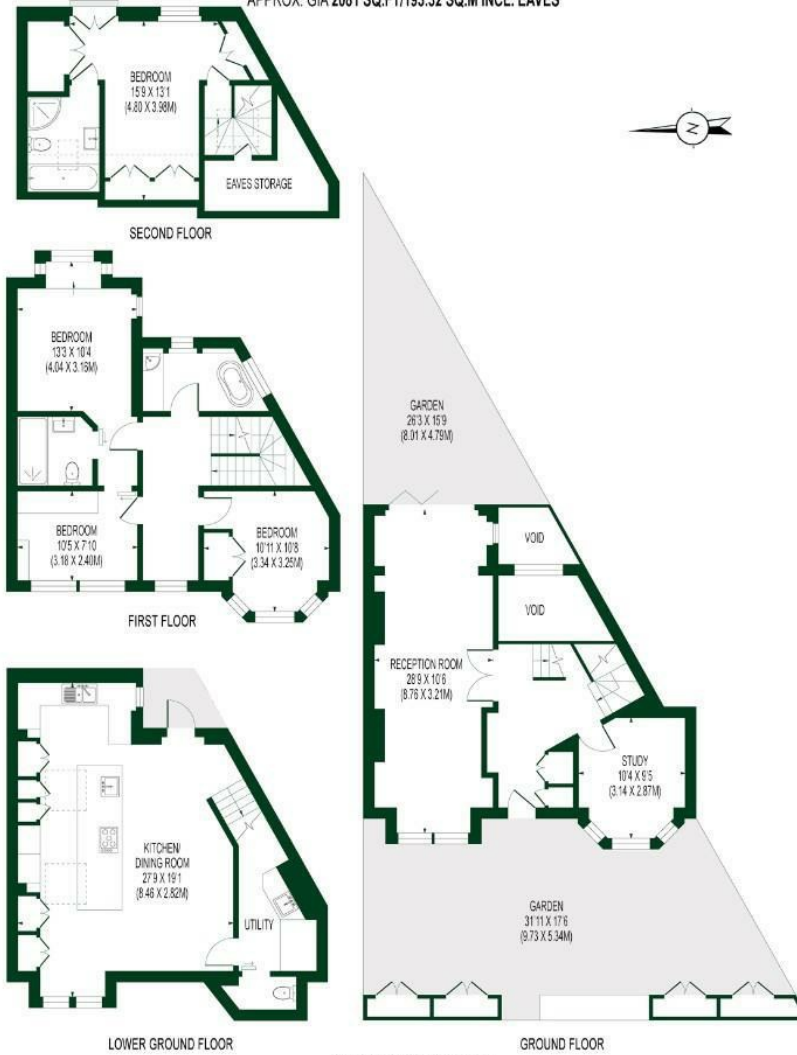

**FOR ILLUSTRATION PURPOSES ONLY**  
THIS FLOOR PLAN SHOULD BE USED AS A GENERAL OUTLINE FOR GUIDANCE ONLY AND DOES NOT CONSTITUTE IN WHOLE OR IN PART AN OFFER OR CONTRACT.  
ANY INTENDING PURCHASER OR LESSEE SHOULD SATISFY THEMSELVES BY INSPECTION, SEARCHES, ENQUIRIES AND FULL SURVEY AS TO THE CORRECTNESS OF EACH STATEMENT.  
ANY AREAS, MEASUREMENTS OR DISTANCES QUOTED ARE APPROXIMATE AND SHOULD NOT BE USED TO VALUE A PROPERTY OR BE THE BASIS OF ANY SALE OR LET.

