



# CLEMENTS HABBA



Victoria Grove Mews, Notting Hill Gate, London

**£1,550,000**

Freehold







- Two Double Bedroom Mews House
- Freehold
- Fully integrated Kitchen
- RBK&C - Residents Parking
- EPC Rating D
- 891 Sq' - 82 SqM
- Immaculate Condition
- Gas Central Heating
- No Chain
- Moments from Notting Hill Gate

## THE PROPERTY

An immaculately presented two bedroom Mews House located moments from Notting Hill Gate, Kensington Gardens and Portobello Road.

### VICTORIA GROVE MEWS

APPROX. GIA (INCL. REDUCED HEIGHT AREA): 891 SQ. FT./82.8 SQ.M

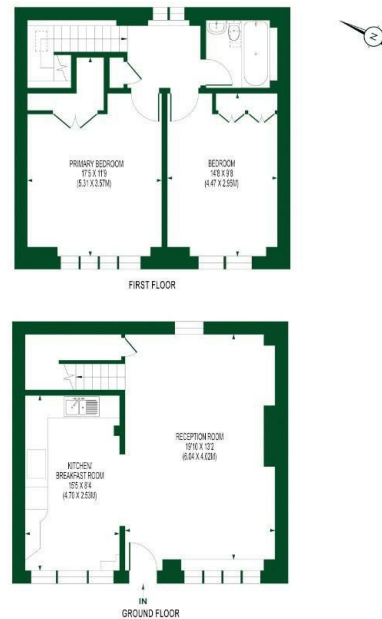

FOR ILLUSTRATION PURPOSES ONLY  
THIS FLOOR PLAN SHOULD BE USED AS A GENERAL OUTLINE FOR GUIDANCE ONLY AND DOES NOT CONSTITUTE IN WHOLE OR IN PART AN OFFER OR CONTRACT.  
ANY INTENDING PURCHASER OR LESSEE SHOULD SATISFY THEMSELVES BY INSPECTION, SEARCHES, ENQUIRIES AND FULL SURVEY AS TO THE CORRECTNESS OF EACH STATEMENT.  
ANY AREAS, MEASUREMENTS OR DISTANCES QUOTED ARE APPROXIMATE AND SHOULD NOT BE USED TO VALUE A PROPERTY OR BE THE BASIS OF ANY SALE OR LET.

**CLEMENTS  
HABBA**



Clements Habba Ltd.  
Building 3, Chiswick Park, 566 Chiswick High Rd,  
Chiswick, London W4 5YA