



Hare Pasture Farm  
Over Alderley

Andrew J Nowell  
& Company





## Hare Pasture Farm, Slade Lane, Over Alderley, SK10 4SF

A charming farmhouse with generous grounds extending to approximately 10.8 acres with superb equestrian facilities including stables and a menage.

- Five Bedrooms
- Generous Grounds
- Idyllic Location
- Unique Accommodation

Hare Pasture Farm is a charming individual farmhouse which blends the original characterful property with contemporary additions which create a bright and spacious family home, finished to a high standard.

Features of particular note on the ground floor include the stunning open sitting room, boasting floor to ceiling windows and bi-folding doors with picturesque views across the gardens and grounds and the large open living kitchen with shaker style units, granite work surfaces and integrated appliances.

In addition on the ground floor is the entrance hall, family room with vaulted ceiling, study area, utility room, two bedrooms, two bathrooms (both en-suite), boot room and cloakroom WC along with a detached office.

To the first floor is the principle bedroom suite with Juliette balcony, dressing room and large en-suite bathroom with free standing bath and walk-in double shower. There are two further bedrooms, two bathrooms (one en-suite), reception area and galleried landing.

Externally the property is approached via a set of electric gates which open to a resin bonded and stone flagged driveway providing ample parking. The farm boasts generous gardens and grounds extending to approximately 10.8 acres.







The formal garden has a stone flagged patio with water feature and walled border, large lawns with lake and woodland areas. The remaining acreage is separated into three paddocks. There is a large detached garage and tack room, three stables and various outbuildings including storage sheds and field shelters.

Alderley Edge village is within a few minutes' drive offering a good range of shopping, including Waitrose supermarket, boutiques and fine restaurants. The area has excellent schooling and The Edge is a well-known beauty spot with delightful walks. The motorway network system is within easy access, as is Manchester International Airport, local and commuter rail links to Manchester and London.

### Important Information

What 3 Words - ///times.assist.twinkling

Council Tax - G

EPC Rating - TBC

Heating: Oil Fired Central Heating

Services: Mains Electric & Water, Drainage via sewage treatment plant. The property also has solar panels.

Parking: Driveway & Garage

Tenure - Freehold

Flood Risk\*: Very low risk of flooding

Broadband\*\*: Ultrafast broadband available at the property

Mobile Coverage\*\*\*: Mobile coverage with main providers (EE, O2, Three & Vodafone), limited coverage indoors.

\* Information provided by GOV.UK

\*\*Information provided by Ofcom checker

The information isn't guaranteed. Andrew J Nowell take no responsibility for inaccuracies and advise potential buyers to do their own checks before committing to purchase.



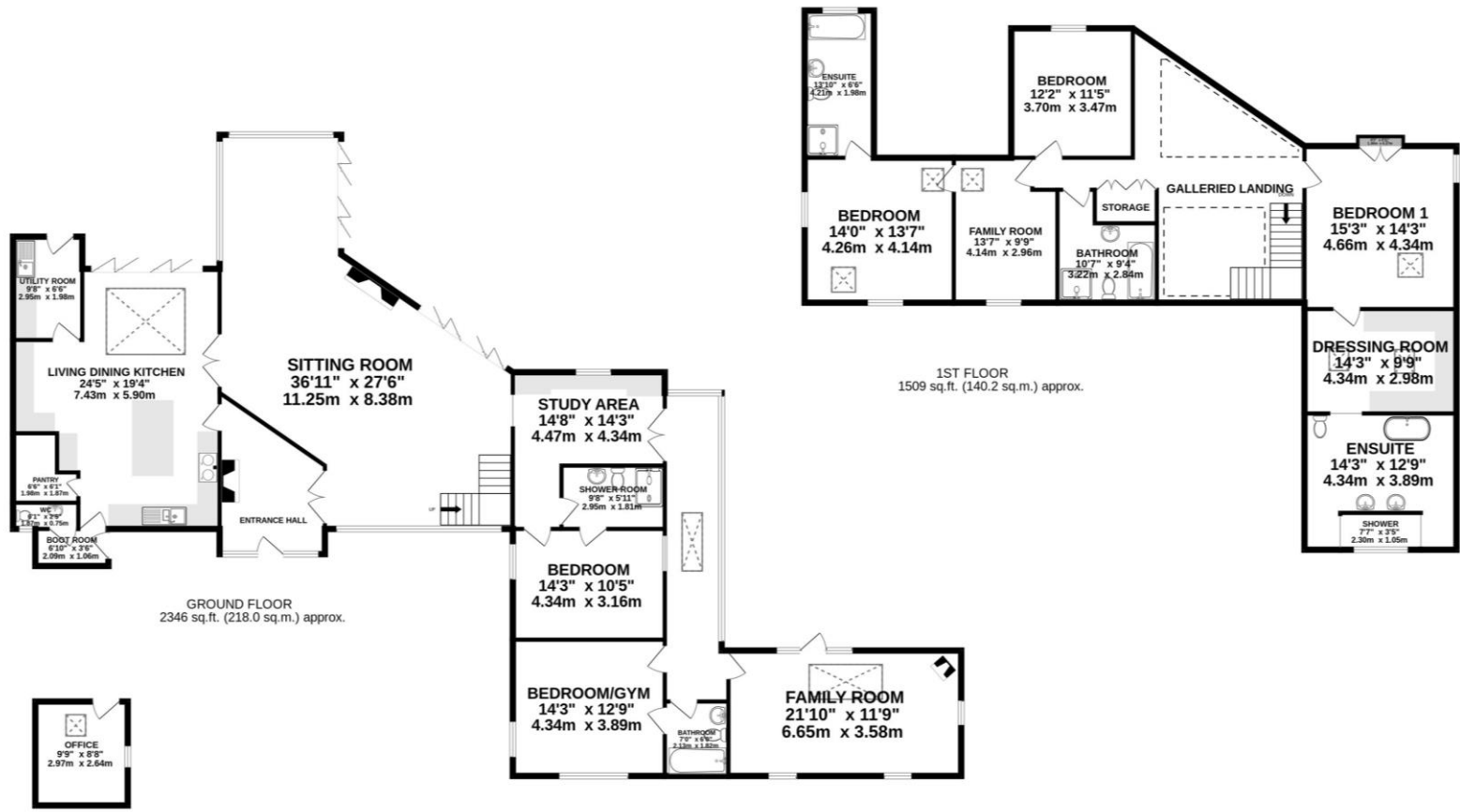

\*Not shown in actual position or orientation

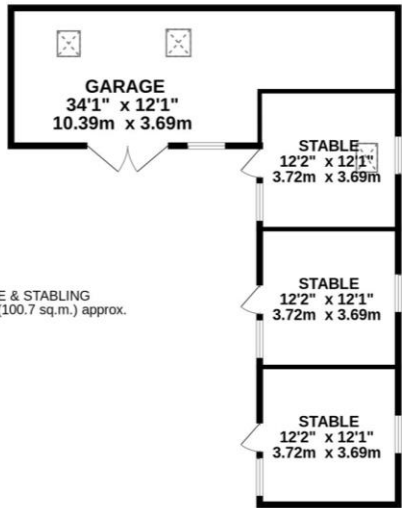
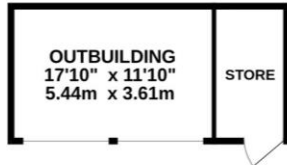

GARAGE & STABLING  
1084 sq.ft. (100.7 sq.m.) approx.

**TOTAL FLOOR AREA : 4940 sq.ft. (458.9 sq.m.) approx.**

Whilst every attempt has been made to ensure the accuracy of the floorplan contained here, measurements of doors, windows, rooms and any other items are approximate and no responsibility is taken for any error, omission or mis-statement. This plan is for illustrative purposes only and should be used as such by any prospective purchaser. The services, systems and appliances shown have not been tested and no guarantee as to their operability or efficiency can be given.  
Made with Metropix ©2024



8 London Road, Alderley Edge, Cheshire SK9 7JS  
Email: [mail@andrewjnowell.co.uk](mailto:mail@andrewjnowell.co.uk)

T 01625 585905  
[www.andrewjnowell.co.uk](http://www.andrewjnowell.co.uk)

**Andrew J Nowell  
& Company**

N.B. Andrew J. Nowell & Company for themselves and for the vendors or lessors of this property whose agents they are give notice that: 1. The particulars are set out as a general outline only for the guidance of intending purchasers or lessees and do not constitute nor constitute part of an offer or contract. 2. All descriptions, dimensions, references to condition or necessary permissions for use and occupation and other details are given without responsibility and any intending purchasers or tenants should not rely on them as statements or representations of fact but must satisfy themselves by inspection or otherwise as to the correctness of each of them. 3. No person in the employment of Andrew J. Nowell & Company has any authority to make or give any representation or warranty whatever in relation to this property.