



RETAIL UNIT TO LET

2000 sq.ft.

UNIT 2, SANDERSON ARCADE, MORPETH NE61 1NS

DEVELOPMENT BY:



EST. 1992

Dransfield

PROPERTIES LIMITED

KEY FEATURES

- Ground floor shop
- Prominent unit adjacent to the Bus Station
- Suitable for a variety of uses
- Available immediately
- Electric, water & mains drainage
- High footfall location
- Actively managed centre
- EPC Rating: B(37)



DESCRIPTION

The property comprises a ground floor double fronted retail unit, prominently positioned adjacent to Sanderson Arcade Bus Station. The 2,000 sq.ft. unit provides excellent retail space suitable for a variety of uses and benefits from it's own kitchen/staff area and toilets.

LEASE TERMS

Available on a term to be negotiated at £45,000 p.a. exclusive of VAT, service charge, building insurance and rates.

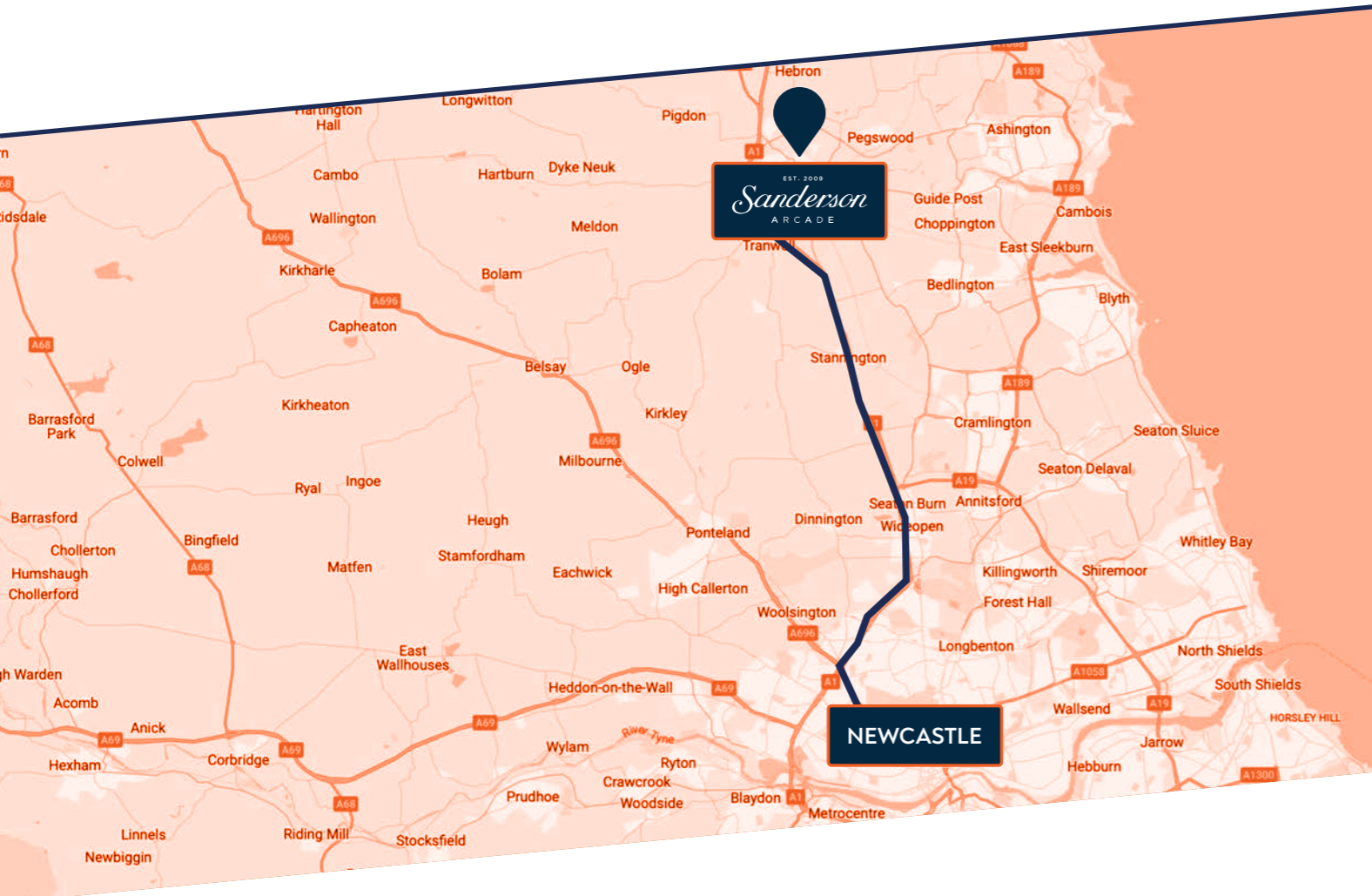

THE LOCATION

Sanderson Arcade is located within Morpeth, an affluent market town 15 miles of Newcastle. The shopping centre, a modern mixed use development is home to major retailers and also provides local businesses with high quality first floor office space.

Morpeth also provides excellent transport links with bus and train services to Newcastle and neighbouring towns and is a few minutes from the A1 Motorway.

EST. 2009
Sanderson
ARCADE

The scheme offers a variety of places to eat and drink, some notable businesses include:
Central Bean, Bar Luga & Morpeth Lader.

After a bite to eat, shoppers can browse through our retailers including **Fat Face, Jojo Maman Bebe, Phase Eight, Mountain Warehouse, Waterstones, Mint Velvet, Seasalt, Crew Clothing, Hobbs, The White Company, Oliver Bonas and The Works, opening May & June 2024.**

Sanderson Arcade is home to Snap Fitness, the 24 hr gym located above Sandersons which allows its' members to get their sweat on day or night.

The Town provides its' residents and visitors with many pubs and restaurants, two major supermarkets and a brand new state of the art leisure centre.

DEVELOPMENT BY:



EST. 1992

Dransfield

PROPERTIES LIMITED

FLOOR PLAN & INTERNAL PHOTOS

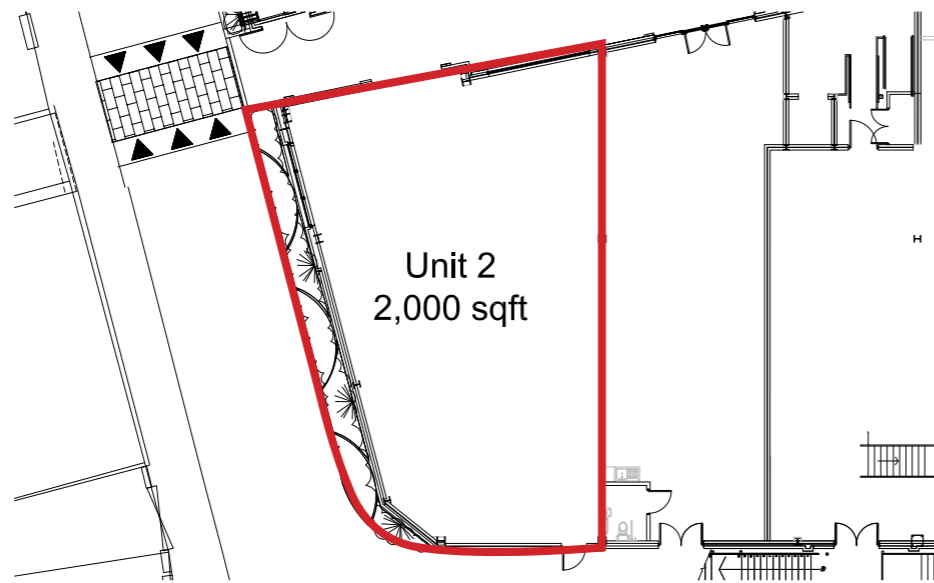

DEVELOPMENT BY:



EST. 1992
Dransfield

PROPERTIES LIMITED

SCHEME PLAN



Preliminary Issue



Sanderson Arcade in Numbers

15 miles north of Newcastle in the beautiful Market Town of Morpeth

56,000 people per week (average footfall)

350 space town centre car park and a bus interchange

230,788 people in a 20 minute drive and 808,174 in a 30 minute drive

Launched in 2009 by Joanna Lumley OBE – welcoming its 25 millionth customer in 2019

Northumberland in Bloom Gold Award Winner

Adjacent town centre development with Next, Pets at Home and Home Bargains

42% of the 10 minute drive time catchment falls into the three most affluent Acorn groups

next

pets at home

home bargains
TOP BRANDS - BOTTOM PRICES



CONTACT US: Dransfield

EST. 1992

PROPERTIES LIMITED

For further information about this property and to arrange a viewing contact:

Olly Jansen

Estates Surveyor at Dransfield Properties
01226 360644 or 07843 358335
olly.jansen@dransfield.co.uk

James Shepherd

Managing Director at Dransfield Properties
01226 360644 or 07789 817880
james.shepherd@dransfield.co.uk

www.dransfield.co.uk

