



# Magistrates House

Market Place, TW8

£1,900 per month  
(£438.46 per week)

An incredibly well presented and spacious 1 bedroom first floor apartment, set within the Old Magistrates Court dating back to 1850 in situated in heart of Brentford town centre. Furnished; EPC rating C

CHESTERTONS

# Magistrates House, TW8

Approximate gross internal area

53.60 sq m / 577 sq ft

Key :  
CH - Ceiling Height

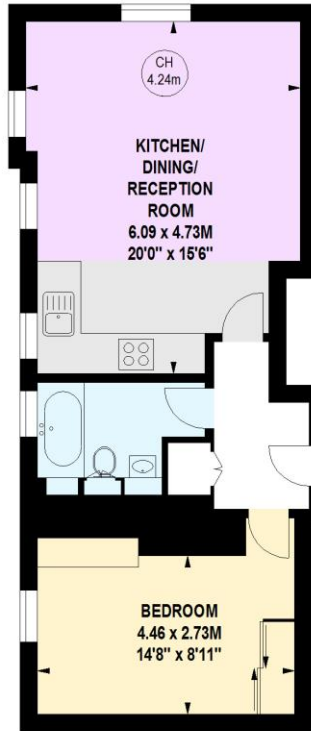

First Floor

This floor plan is a representation for guidance purposes only, not for valuation. Any figure is approximate and must not be relied on as a statement of fact. Copyright of Wyatt Dixon Homes



**Minimum Term:** 12 months  
**Deposit Required:** £2,192.31  
**Local Authority:** Hounslow Council  
**Council Tax Band:** D  
**EPC Rating:** C  
**Part Furnished**

Energy Efficiency Rating		Current	Potential
Very energy efficient - lower running costs			
(92+)	A		
(81-91)	B		
(69-80)	C	74	74
(55-68)	D		
(39-54)	E		
(21-38)	F		
(1-20)	G		
Not energy efficient - higher running costs			
England, Scotland & Wales		EU Directive 2002/91/EC	

## Chestertons Kew Lettings

306 Sandycombe Road  
 Kew  
 Richmond  
 Surrey  
 TW9 3NG  
 kew@chestertons.co.uk  
 020 8104 0340

Additional tenant charges apply (fees apply to non-AST tenancies only)

Tenancy Agreement Fee: £300

References per Tenant/Guarantor: £60

Inventory check (approx. £100 – £250 inc. VAT)

[chestertons.co.uk/property-to-rent/applicable-fees](http://chestertons.co.uk/property-to-rent/applicable-fees)

Chesterton Global Ltd trading as Chestertons for themselves and for the vendor of this property whose agents they are, give notice that (i) these particulars do not constitute any part of an offer or contract, (ii) all statements contained within these particulars are made without responsibility on the part of Chestertons or the vendor, (iii) whilst made in good faith, none of the statements contained within these particulars are to be relied upon as a statement or representation of fact, (iv) any intending purchasers must satisfy themselves by inspection or otherwise as to the correctness of each of the statements contained within these particulars, (v) the vendor does not make or give either Chestertons or any person in their employment any authority to make or give representation or warranty whatsoever in relation to this property. Wide angle lenses may be used. ©Copyright Chestertons | Chesterton Global Ltd | Registered Office 40 Connaught Street, Hyde Park, London W2 2AB Registered Company Number 05334580.



This paper is 100% recyclable