



4 Cwrt Brenin Mill Street, Pontypridd, CF37 2TS

£60,000

**** Walk To Town Centre & Bus/Train Stations ** Ground Floor Apartment ****

Ideally located for amenities, town centre with its many shops, cafes & pubs, park and bus/train stations. A converted, ground floor apartment comprising communal entrance, hallway, open plan lounge/kitchen, two bedrooms and bathroom.

The property is in need of some updating and improvement but offers excellent potential for owner occupation or investment.
No onward chain.

Communal Entrance

Entrance Hall

Entrance door, radiator, coved ceiling, storage cupboard with gas combination boiler.

Living/Kitchen

Living/Kitchen 20'3" x 14'9" (6.18 x 4.52)



Two double glazed windows to rear, base and wall cupboards, stainless steel sink unit, gas hob, and electric oven with extractor hood above, space for washing machine, breakfast bar, two radiator, coved ceiling.

Bedroom 1 12'4" x 11'4" (3.77 x 3.46)



Two double glazed windows to rear, radiator, coved ceiling.

Bedroom 2 10'0" x 7'3" (3.07 x 2.21)



Double glazed window to rear, radiator, coved ceiling.

Bathroom



Three piece suite comprising panelled bath with shower mixer taps, wc, wash hand basin, part tiled walls, radiator, coved ceiling.

Floor Plan

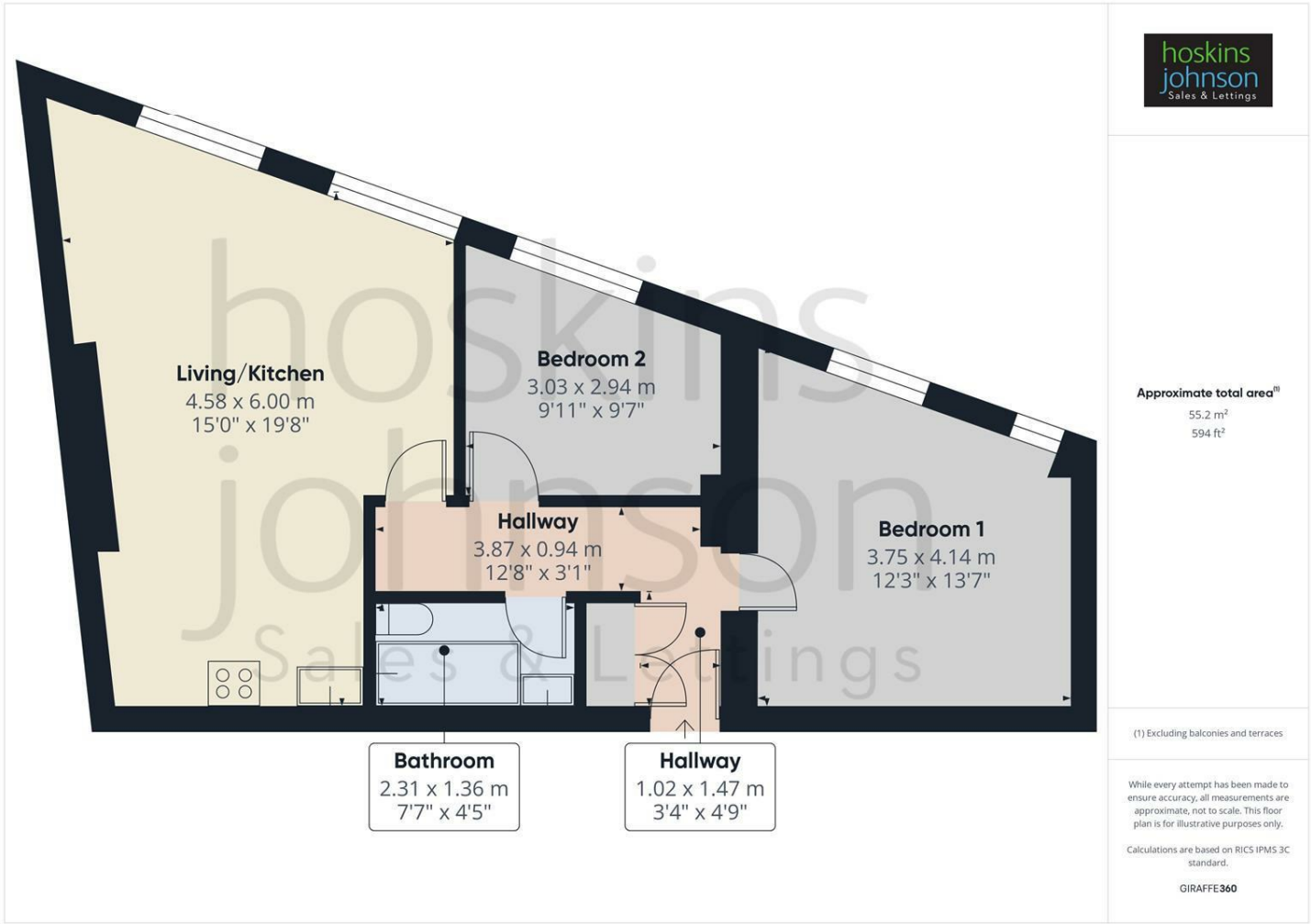

Area Map

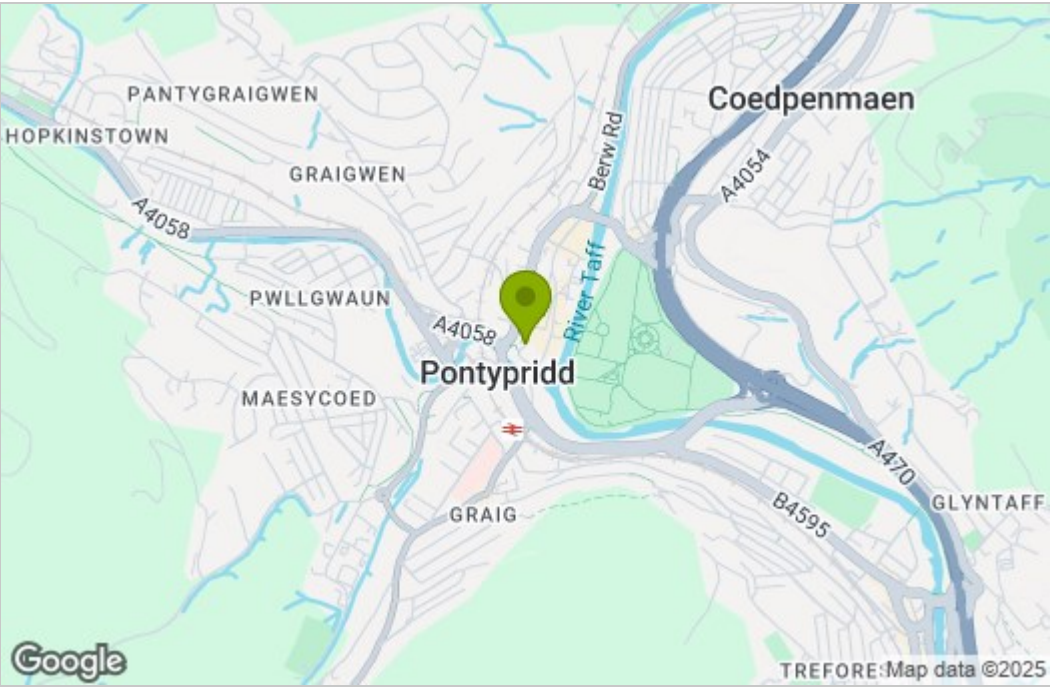

Energy Efficiency Graph

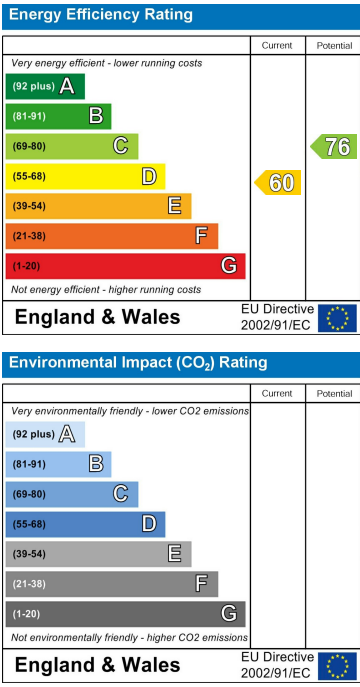

These particulars, whilst believed to be accurate are set out as a general outline only for guidance and do not constitute any part of an offer or contract. Intending purchasers should not rely on them as statements of representation of fact, but must satisfy themselves by inspection or otherwise as to their accuracy. No person in this firms employment has the authority to make or give any representation or warranty in respect of the property.