

FLAT 32 THE PINNACLE 57 ST PETERS ROAD BH1 2LH

£1,300 PCM

Welcome to The Pinnacle - this stunning apartment is nestled in the heart of Bournemouth town centre. Boasting an enviable location, this modern, unfurnished, two-bedroom, fourth floor apartment offers the perfect blend of modern comfort and convenience – within walking distance of local amenities, shops and beaches.

Utilise the inviting open-plan kitchen/lounge area, where the kitchen is fully equipped with integrated appliances including an electric oven/hob, washing machine, fridge freezer and dishwasher and the lounge space is spacious, light and airy with direct access to the balcony.

Featuring two generously proportioned double bedrooms, the master bedroom is complemented by an en-suite shower room.



MrGreen

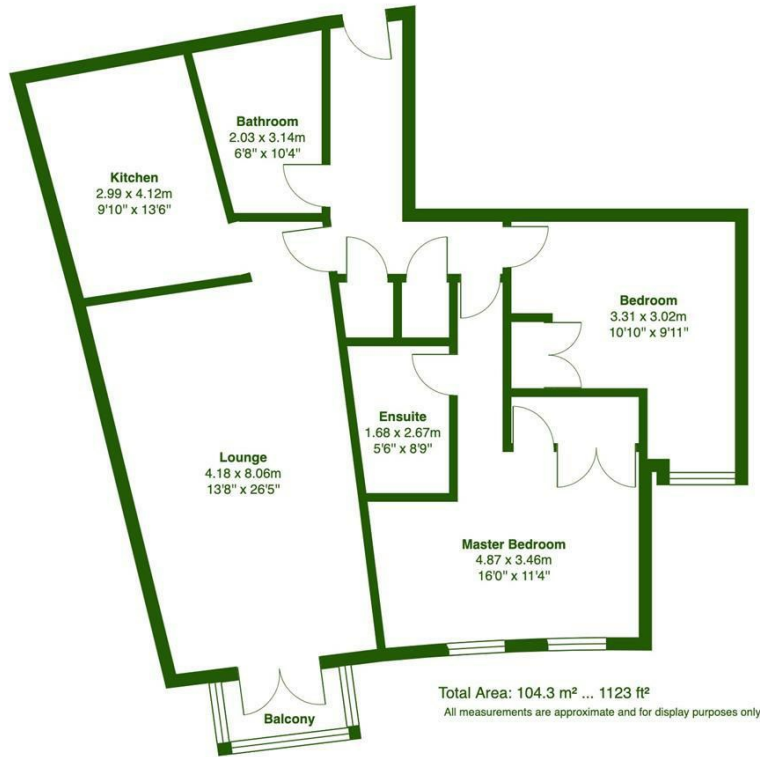

Energy Efficiency Rating		
	Current	Potential
Very energy efficient - lower running costs		
(92 plus) A		
(81-91) B		
(69-80) C	72	83
(55-68) D		
(39-54) E		
(21-38) F		
(1-20) G		
Not energy efficient - higher running costs		
England & Wales	EU Directive 2002/91/EC	

Agents Note: Whilst every care has been taken to prepare these particulars, they are for guidance purposes only. All measurements are approximate and are for general guidance purposes only and whilst every care has been taken to ensure their accuracy, they should not be relied upon and potential buyers/tenants are advised to recheck the measurements

Mr Green Lettings
35 Southbourne Grove
Southbourne
Bournemouth
Dorset
BH6 3QT

01202 835897
lettings@mrgreenhomes.co.uk
www.mrgreenhomes.co.uk



MrGreen