



23 BURTON ROAD
DORSET, BH13 6DT

£1,650 PCM

Welcome to Pinehurst Hall - Discover the epitome of modern luxury living in this exquisitely renovated two-bedroom apartment on the first floor. The apartment is fully furnished with high quality furnishings through-out and is located within the prestigious Branksome Park with quick and easy routes to Branksome Chine Beach and Westbourne Town Centre.

The property boasts two generously sized double bedrooms, with the master bedroom boasting the added luxury of an en-suite shower room which provides tenants with a walk-in shower, towel rail, basin and W/C. A newly fitted luxury kitchen is provided with all integrated appliances.

The lounge is of good size and is enhanced by its full-length sliding windows, offering a picturesque view of the beautifully landscaped communal gardens. The



MrGreen

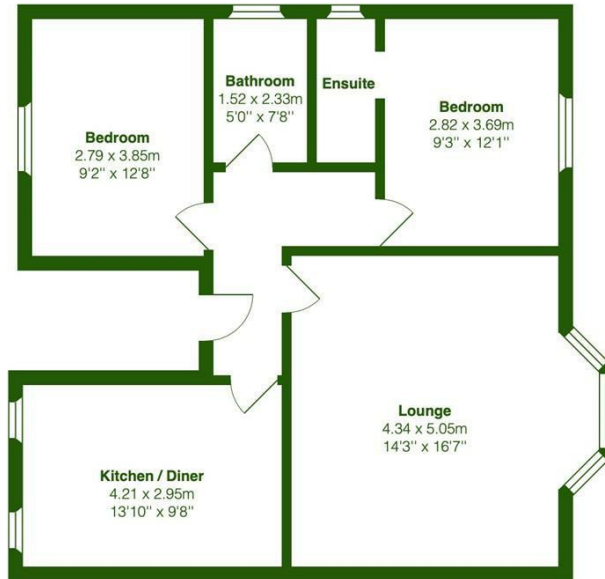

Total Area: 71.6 m² ... 771 ft²

All measurements are approximate and for display purposes only



Energy Efficiency Rating		Current	Potential
Very energy efficient - lower running costs			
(92 plus) A			
(81-91) B			
(69-80) C		74	79
(55-68) D			
(39-54) E			
(21-38) F			
(1-20) G			
Not energy efficient - higher running costs			
England & Wales		EU Directive 2002/91/EC	

Agents Note: Whilst every care has been taken to prepare these particulars, they are for guidance purposes only. All measurements are approximate and are for general guidance purposes only and whilst every care has been taken to ensure their accuracy, they should not be relied upon and potential buyers/tenants are advised to recheck the measurements

Mr Green Lettings
35 Southbourne Grove
Southbourne
Bournemouth
Dorset
BH6 3QT

01202 835897
lettings@mrgreenhomes.co.uk
www.mrgreenhomes.co.uk



MrGreen