



33 Park Street

, Burton-On-Trent, DE14 3SE

Guide price £120,000



Dwellings Estate Agents are delighted to present this terraced home to the market. Park Street boasts convenient proximity to Burton town centre, schools, and local amenities. Transportation links are nearby, such as the A38 & the train station.

The property is set over two floors and is a spacious family home that offers versatile living accommodation. The ground floor briefly comprises two spacious reception room and a fitted kitchen. Two well-proportioned bedrooms and a three-piece bathroom complete the first floor. Externally, to the rear, there is a well-maintained garden.

This home is perfect for any individual/couple/family looking to step onto the property ladder, as this would make an ideal First Time Buy or, in the alternative, a brilliant investment for any prospective Landlord.

Viewings are an absolute must to fully appreciate this beautiful home. Would you like to view this property? Simply click on the "Email Agent" button.



LIVING ROOM 12'0" x 10'9" (3.66m x 3.3m)

DINING ROOM 12'0" x 10'9" (3.66m x 3.3m)

KITCHEN 9'8" x 6'5" (2.97m x 1.97m)

BEDROOM ONE 11'9" x 10'9" (3.6m x 3.3m)

BEDROOM TWO 10'11" x 8'10" (3.35m x 2.7m)

BATHROOM 9'8" x 6'5" (2.97m x 1.97m)

Area Map

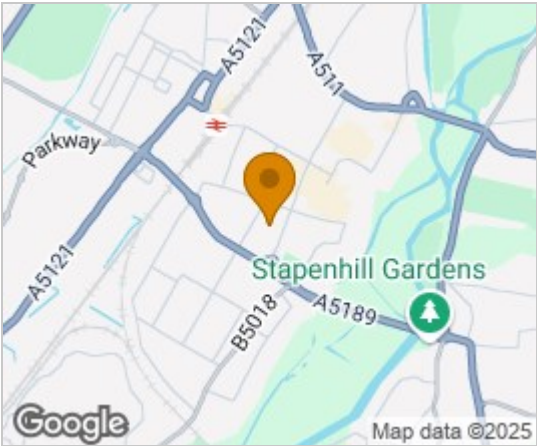

Floor Plans

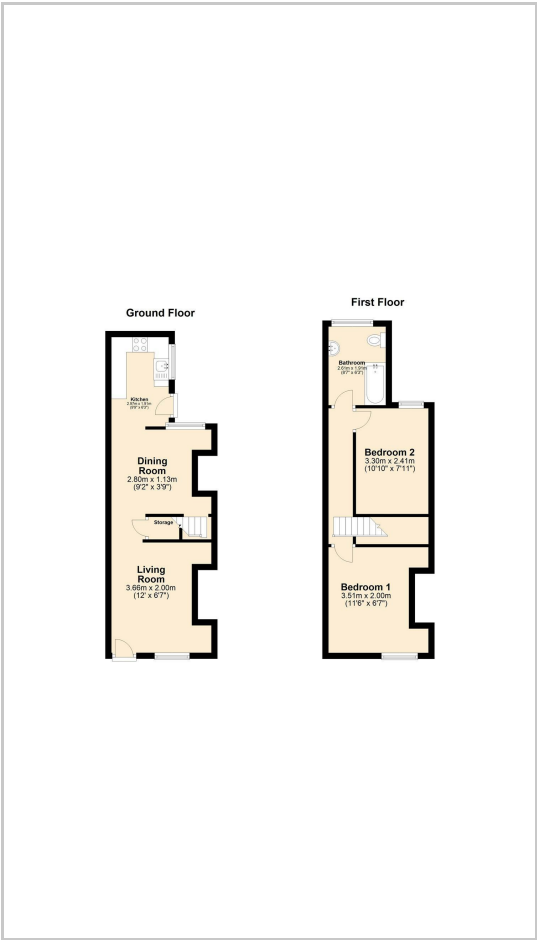

Energy Efficiency Graph

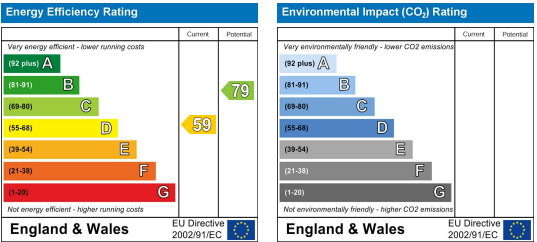

These particulars, whilst believed to be accurate are set out as a general outline only for guidance and do not constitute any part of an offer or contract. Intending purchasers should not rely on them as statements of representation of fact, but must satisfy themselves by inspection or otherwise as to their accuracy. No person in this firms employment has the authority to make or give any representation or warranty in respect of the property.