



6 Saxon Street

, Burton-On-Trent, DE15 9RL

Guide price £158,000



Dwellings Estate Agents are delighted to present this three-bedroom family home to the market. Located in the highly desirable area of Stapenhill, Saxon Street is situated close to local amenities and is in an ideal location for nearby schools. It is located a short drive away from Burton's Town Centre.

This accommodation has the benefit of uPVC double glazing and gas central heating throughout.

This property is well presented throughout. The property is set over two floors and is a spacious family home that offers versatile living accommodation. The ground floor briefly comprises a spacious lounge, a fitted kitchen, and a three-piece bathroom located to the rear of the property. The first-floor landing leads to two double bedrooms and a third single bedroom. Externally, there is a small front garden. To the rear, there is a good-sized garden.

This stunning home is perfect for any individual/couple/family looking to step onto the property ladder as this would make an ideal First Time Buy or, in the alternative, a brilliant investment for any prospective



LOUNGE 26'2" x 11'7" (8.00m x 3.55m)

KITCHEN 12'8" x 6'6" (3.87m x 2.00m)

BATHROOM 8'2" x 6'6" (2.50m x 2.00m)

LANDING

MASTER BEDROOM 6'6" x 11'7" (2.00m x 3.55m)

BEDROOM TWO 11'9" x 8'7" (3.60m x 2.63m)

BEDROOM THREE 8'6" x 6'6" (2.61m x 2.00m)

Area Map



Floor Plans

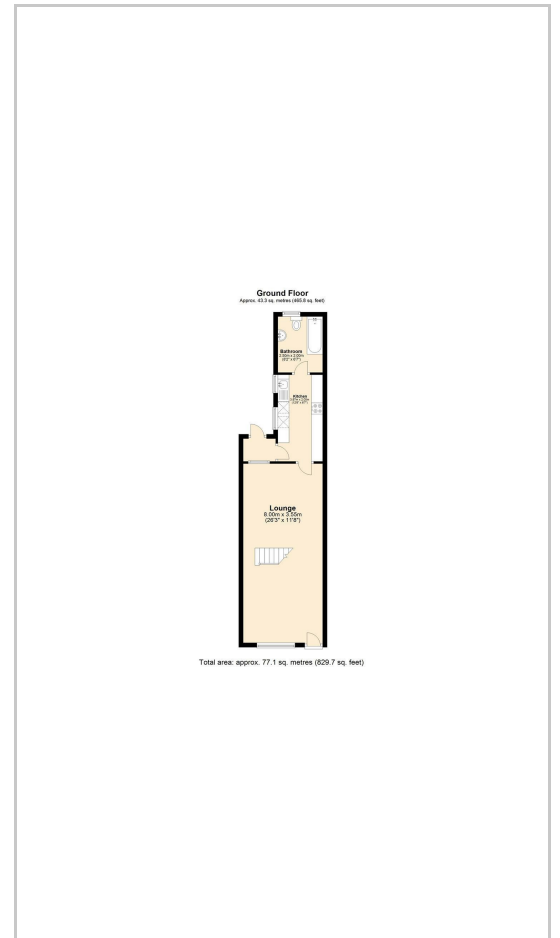

Energy Efficiency Graph

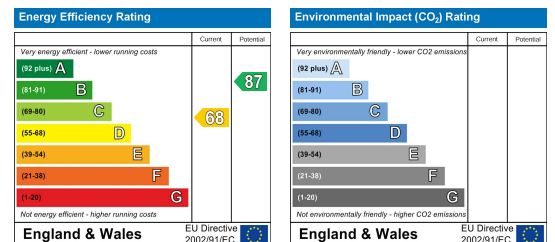

These particulars, whilst believed to be accurate are set out as a general outline only for guidance and do not constitute any part of an offer or contract. Intending purchasers should not rely on them as statements of representation of fact, but must satisfy themselves by inspection or otherwise as to their accuracy. No person in this firm's employment has the authority to make or give any representation or warranty in respect of the property.

Guild Street,, Burton on Trent, Staffordshire, DE14 1NA

Tel: 01283 890199 Email: hello@dwellingsestate.co.uk <https://www.dwellingsestate.co.uk>