



8 Beacon Close

Anslow, Burton-on-Trent, DE13 9UF

£205,000



Dwellings Estate Agents are delighted to present to the market this three-bedroom property situated in the highly sought-after Beamhill Heights development. Offering convenient access to local amenities and well-regarded schools, this property presents an attractive opportunity for prospective buyers.

This accommodation has the benefit of uPVC double glazing and central heating throughout.

Internally the property comprises of open plan kitchen/lounge/dining room, downstairs WC, three bedrooms and family bathroom. Externally the property comprises of allocated parking and an enclosed rear garden.

This stunning home is perfect for any individual/couple/family looking to step onto the property ladder, as this would make an ideal First Time Buy or, in the alternative, a brilliant investment for any prospective Landlord.



KITCHEN/DINNING/LIVING ROOM 21'11" x 8'9" (6.70m x 2.69)

WC 4'11" x 2'7" (1.51 x 0.81)

BEDROOM TWO 7'6" x 11'9" (2.30 x 3.60)

BEDROOM THREE 7'10" x 6'6" (2.40 x 2)

BATHROOM 5'10" x 5'5" (1.80 x 1.67)

LANDING 10'9" x 6'0" (3.30 x 1.83)

MASTER BEDROOM 19'9" x 8'6" (6.03 x 2.61)

CLOSET 5'6" x 2'11" (1.70 x 0.89)

Area Map



Floor Plans

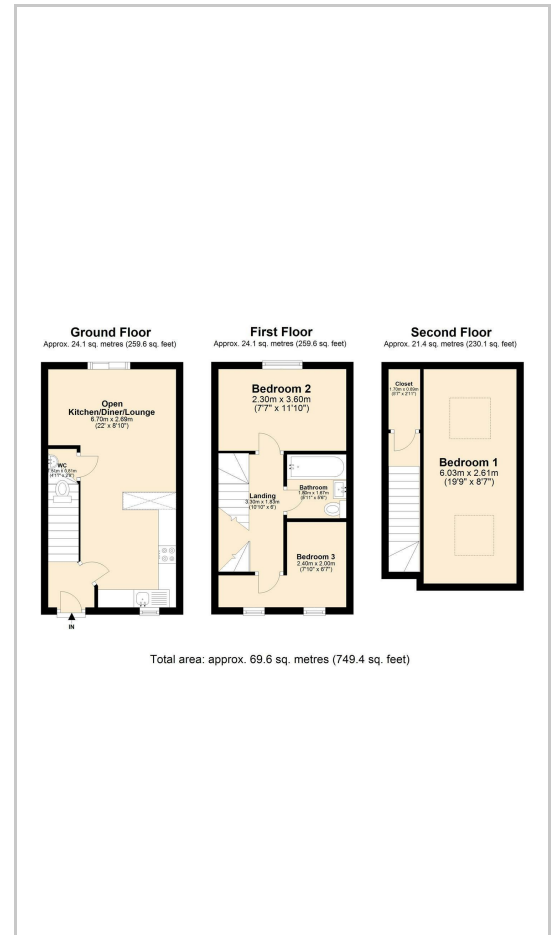

Energy Efficiency Graph

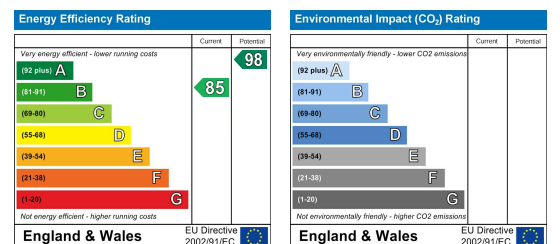

These particulars, whilst believed to be accurate are set out as a general outline only for guidance and do not constitute any part of an offer or contract. Intending purchasers should not rely on them as statements of representation of fact, but must satisfy themselves by inspection or otherwise as to their accuracy. No person in this firm's employment has the authority to make or give any representation or warranty in respect of the property.

Guild Street,, Burton on Trent, Staffordshire, DE14 1NA

Tel: 01283 890199 Email: hello@dwellingsestate.co.uk <https://www.dwellingsestate.co.uk>