



**GASCOIGNE
HALMAN**

59 NORTHWICH ROAD, CRANAGE

THE AREAS LEADING ESTATE AGENT



59 NORTHWICH ROAD, CRANAGE

£1,350,000.00

A most stunning modern detached dwelling set in its own grounds of over 4 acres (of which 2 acres is woodland), stables, stunning gardens, paddock and menage. No upward chain.

Northwich Road is one of the most popular locations between Holmes Chapel and Knutsford, with this particular property being no exception.

Not only does the property offer flexible living accommodation throughout, it is set in the most stunning of grounds.

Internally this modern home boasts two reception rooms, both opening to the orangery which overlooks the rear garden, off the dining room is a bright and modern kitchen with central island unit, pantry and utility room. To the front of this family home, a further two reception rooms have been used as a guest or dependent relative living room/bedroom, dressing room and en-suite - offering a variety of uses, these rooms could also be ideally used as a home office and play room.

With five generous bedrooms to the first floor, the master having a dressing area and a three piece shower room, while the main bathroom is also fitted with a modern white four piece suite which includes his and hers sink units.

It's the grounds of this home though that is simply stunning. A driveway to the front leads down the side of the house to give vehicle access to the menage, paddock and stables. This flat land leads to a 2 acre woodland where there is also a further brick building currently housing little goats.

This stunning home will no doubt appeal to a growing family with equestrian interests or those looking to embrace a smallholding lifestyle. The location is also a key strength, wonderfully accessible yet with a real sense of space and privacy.





Plot of approx 4.5 acres, of which 2 acre is woodland

Stunning detached family home

Flexible and versatile living accommodation

2 reception rooms and modern kitchen with island unit

Impressive orangery with Bi-folding doors to the garden

5 first floor bedrooms and two bathrooms (one en-suite)

Ground floor guest bedroom, dressing room and en-suite

Gravel driveway leading to the stables and menage

Brick stable block, menage and paddock

Lush grazing land with post and rail fencing

Bluebell woodland ideal for live stock



59 NORTHWICH ROAD, CRANAGE

DIRECTIONS

WA16 9LE - Northwich Road, Cranage

LOCATION

Cranage is a small Parish located between the villages of Holmes Chapel and Knutsford which provide for most day to day shopping requirements. The latter of which has many historical associations including the famous Tatton Park Country Estate. Close by there are some beautiful country walks and whilst on the fringe of Cheshire's open countryside, the property is by no means isolated and within easy reach of the North West motorway network and Manchester International Airport. There are rail stations at both Holmes Chapel and Knutsford which provide a regular commuter service to most commercial centres. For the sports person there are leisure centres in Knutsford and Holmes Chapel and at the private leisure complex at Cranage Hall. There are also a number of notable golf courses within easy reach. The area is well known for its excellent educational facilities and there are several good schools close by to suit children of most ages.

ENERGY PERFORMANCE RATING

EPC Rating C

TENURE

Freehold







LOCAL AUTHORITY

Cheshire East Council Tax Band G

SERVICES (NOT TESTED)

Services have not been tested and you are advised to make your own enquiries and/or inspections.

VIEWING

Viewing strictly by appointment through the Agents.



GROUND FLOOR
1572 sq.ft. (146.1 sq.m.) approx.

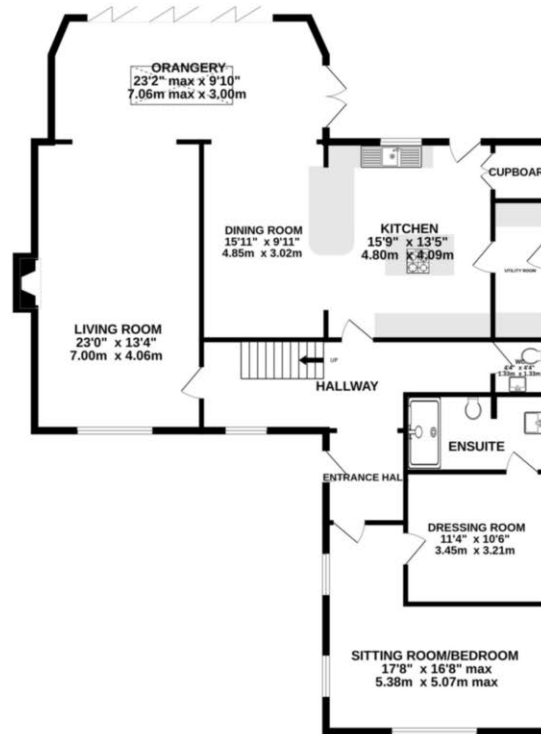

1ST FLOOR
1079 sq.ft. (100.3 sq.m.) approx.

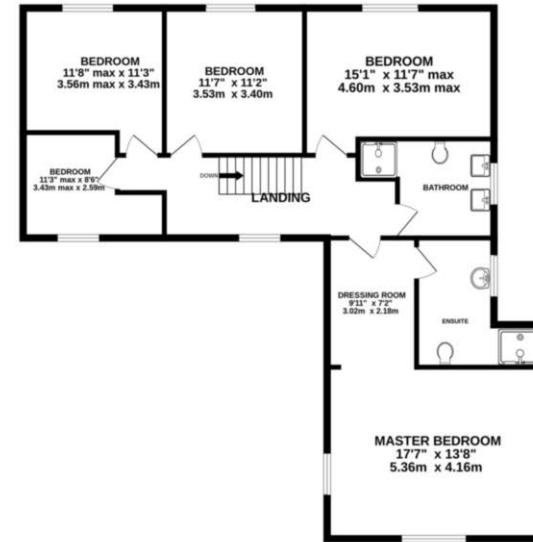

TOTAL FLOOR AREA : 2652 sq.ft. (246.3 sq.m.) approx.
Measurements are approximate. Not to scale. Illustrative purposes only
Made with Metropix ©2025

NOTICE Gascoigne Halman for themselves and for the vendors or lessors of this property whose agents they are give notice that: (i) the particulars are set out as a general outline only for the guidance of intending purchasers or lessees, and do not constitute, nor constitute part of, an offer or contract; (ii) all descriptions, dimensions, references to condition and necessary permissions for use and occupation, and other details are given in good faith and are believed to be correct but any intending purchasers or tenants should not rely on them as statements or representations of fact but must satisfy themselves by inspection or otherwise as to the correctness of each of them; (iii) no person in the employment of Gascoigne Halman has any authority to make or give any representation or warranty whatever in relation to this property.



HOLMES CHAPEL OFFICE

01477 417000

holmeschapel@gascoignehalman.co.uk
14 The Square, Holmes Chapel, CW4 7AB

**GASCOIGNE
HALMAN**