

home.

£560,000

Cliff Parade

Leigh-On-Sea, SS9 1BB

PROPERTY SUMMARY

** OFFERED CHAIN FREE **

Home of Leigh are very excited to offer for sale this wonderful two bedroom top floor penthouse apartment which is located in arguably one of Leigh On Sea's most sought after roads affording some magnificent views of the estuary out towards the Kent Coastline and Southend Pier.

The accommodation includes; entrance hall, a sizeable open plan lounge & dining room with access to a

2



1



1





south facing balcony and some beautiful estuary views, a separate kitchen with an array of integrated appliances, two double bedrooms - both with built-in wardrobes plus a bright and airy three piece bathroom suite.

Situated on Leigh-on-Sea's prominent and highly sought after Cliff Parade, this gorgeous apartment is perfectly positioned for all nearby amenities which includes the seafront and mainline railway station - serving London Fenchurch Street for commuters. Also within a short stroll are both Leigh's fashionable Broadway and Leigh Road with its array of bars, cafés, restaurants and popular boutiques.





GROUND FLOOR

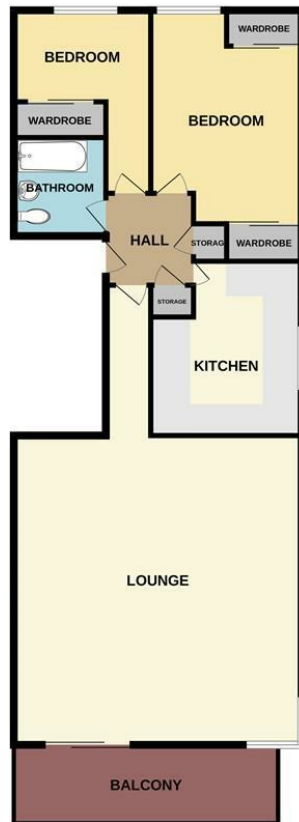

Made with Metropix ©2023

LOCAL AUTHORITY

TENURE

Share of Freehold

COUNCIL TAX BAND

F

VIEWINGS

By prior appointment only

Energy Efficiency Rating		
	Current	Potential
<i>Very energy efficient - lower running costs</i>		
(92 plus) A		
(81-91) B		
(69-80) C		
(55-68) D	56	56
(39-54) E		
(21-38) F		
(1-20) G		
<i>Not energy efficient - higher running costs</i>		
England & Wales	EU Directive 2002/91/EC	

Agents Note: Whilst every care has been taken to prepare these particulars, they are for guidance purposes only. All measurements are approximate and are for general guidance purposes only and whilst every care has been taken to ensure their accuracy, they should not be relied upon and potential buyers/tenants are advised to recheck the measurements

home.

OFFICE ADDRESS

The Old Bank
26 Broadway
Leigh on Sea
Essex
SS9 1AN

OFFICE DETAILS

info@homeofleigh.com
01702480033
homeofleigh.com