

Flat 5 Beech Court, Beccles Road, Worthing, West Sussex, BN11 4AJ

£140,000

Council Tax Band: A



We are pleased to bring to the market this large first floor studio flat nestled in a quiet conservation area of Worthing offering a fantastic opportunity for both investors and first-time buyers alike.

Situated on the first floor, this spacious apartment boasts a recently fitted kitchen, large studio room and bathroom.

Non-allocated parking adds to the convenience. The new 999-year lease on completion and low maintenance costs of £665.88 per annum provides peace of mind for the future, making this a secure investment. Currently rented at £600pcm with the potential to increase to the current market rate.

Whether you're a first-time buyer or an investor looking to expand your portfolio, this property has something for everyone.

This property is one of 5 for sale in this block.



22 South Farm Road, Worthing, West
Sussex, BN14 7AA
01903 532225
worthing@localagent.co.uk
www.openhouselocal.co.uk

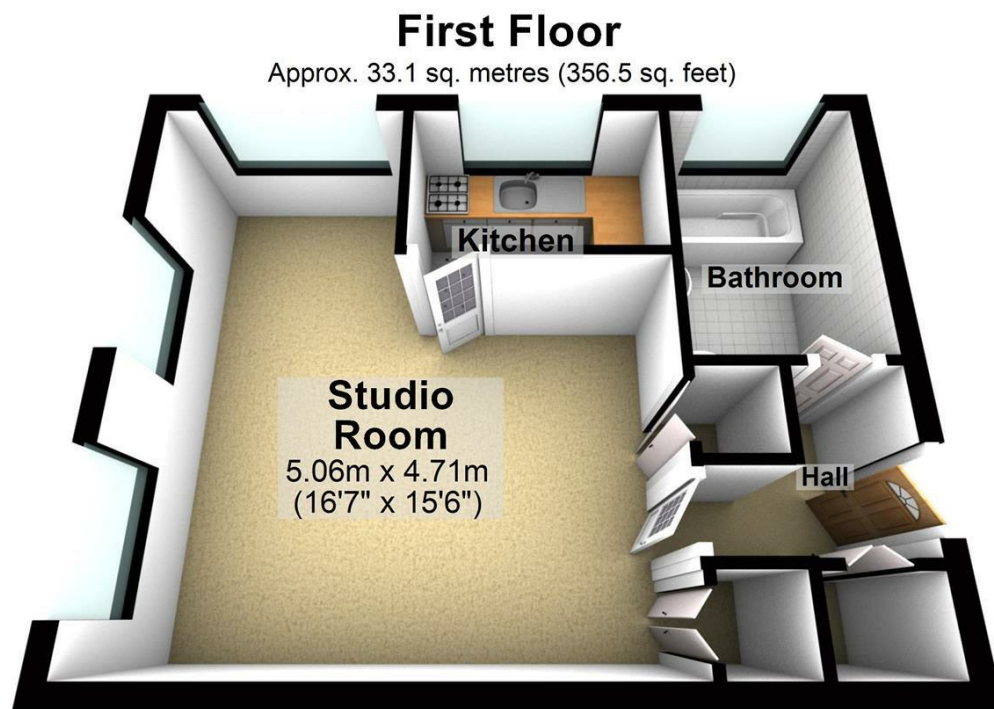

Total area: approx. 33.1 sq. metres (356.5 sq. feet)



Energy Efficiency Rating		
	Current	Potential
Very energy efficient - lower running costs		
(92 plus) A		
(81-91) B		
(69-80) C		
(55-68) D	56	74
(39-54) E		
(21-38) F		
(1-20) G		
Not energy efficient - higher running costs		
England & Wales	EU Directive 2002/91/EC	