

Flat 1 Beech Court, Beccles Rd, Worthing, West Sussex, BN11 4AJ

£140,000

Council Tax Band: A



We are delighted to bring to the market this large ground floor studio apartment situated in a quiet conservation area of Worthing. Boasting its own private entrance, this property offers a perfect blend of comfort and convenience.

As you step inside, you are greeted by a spacious studio layout that provides ample room for both living and sleeping areas. The large studio space is versatile and can be easily adapted to suit your lifestyle needs and benefits from plenty of storage space.

Ideal for both investors and first-time buyers, the new 999-year lease on completion and low maintenance costs of £665.88 per annum, adds to the appeal of this residence, providing long-term security and peace of mind.

The property also benefits from having private non-allocated parking available.

Currently rented at £725 per calendar month, this property also offers a great investment opportunity for those looking to expand their portfolio.

This property is one of 5 available in this block.



22 South Farm Road, Worthing, West  
Sussex, BN14 7AA  
01903 532225  
worthing@localagent.co.uk  
www.openhouselocal.co.uk

### Ground Floor

Approx. 33.8 sq. metres (363.9 sq. feet)

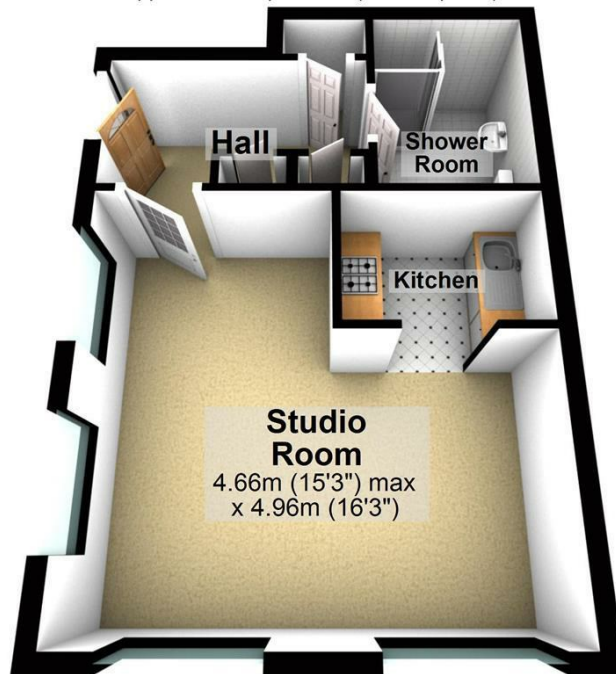

Total area: approx. 33.8 sq. metres (363.9 sq. feet)



Energy Efficiency Rating		
	Current	Potential
Very energy efficient - lower running costs		
(92 plus) <b>A</b>		
(81-91) <b>B</b>		
(69-80) <b>C</b>		
(55-68) <b>D</b>		
(39-54) <b>E</b>		
(21-38) <b>F</b>		
(1-20) <b>G</b>		
Not energy efficient - higher running costs		
	67	79
<b>England &amp; Wales</b>	EU Directive 2002/91/EC	