

Lane Ends, Oakworth, Yorkshire, BD22 7PR

Asking Price £149,995

Council Tax Band: A



Situated conveniently in the heart of Oakworth, this charming two bedroom cottage is a perfect opportunity for a variety of buyers looking for a perfect home or savvy investment. Benefitting from being close to local amenities, schools and transport links, viewings are advised to see all that this property has to offer.

One of the standout points of this home is the generous garden area to the rear, a sought after and rare feature in the village of Oakworth.

This property is also offered to the market with NO ONWARD CHAIN.

This property briefly comprises of:



Keighley

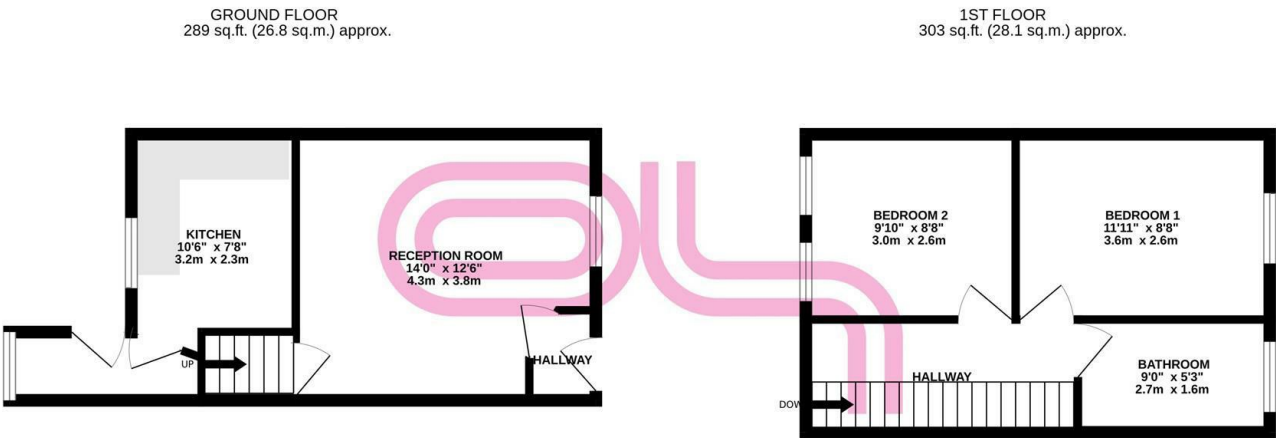

TOTAL FLOOR AREA : 592 sq.ft. (55.0 sq.m.) approx.
Whilst every attempt has been made to ensure the accuracy of the floorplan contained here, measurements of doors, windows, rooms and any other items are approximate and no responsibility is taken for any error, omission or mis-statement. This plan is for illustrative purposes only and should be used as such by any prospective purchaser. The services, systems and appliances shown have not been tested and no guarantee as to their operability or efficiency can be given.
Made with Metropix ©2025



Energy Efficiency Rating		
	Current	Potential
Very energy efficient - lower running costs		
(92 plus) A		
(81-91) B		86
(69-80) C		
(55-68) D	64	
(39-54) E		
(21-38) F		
(1-20) G		
Not energy efficient - higher running costs		
England & Wales	EU Directive 2002/91/EC	