

Hoyle Court Avenue, Baildon, Yorkshire, BD17 6ET

£695 Per Month

Council Tax Band:

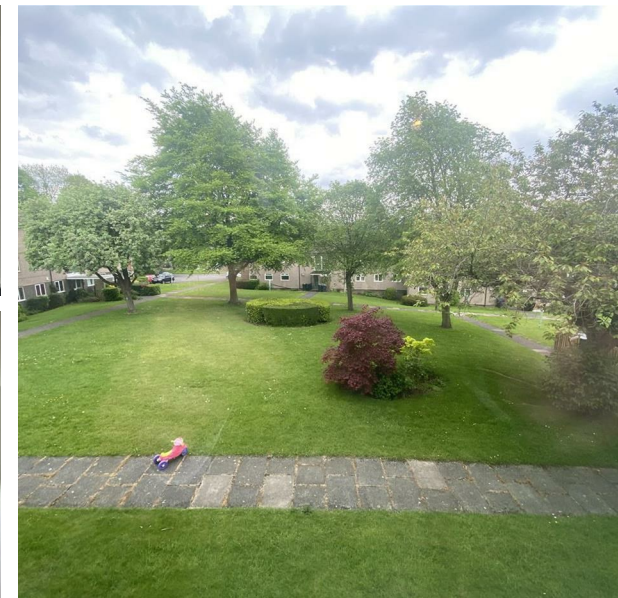

We are pleased to offer for rent this well presented 2 bedroom apartment in the popular area of Baildon. This spacious apartment is close to local amenities and public transport links.

Council tax band: B

The property briefly compromises of:

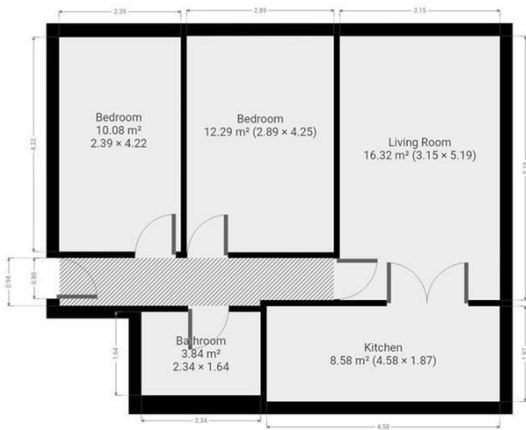

Keighley



Energy Efficiency Rating		
	Current	Potential
Very energy efficient - lower running costs		
(92 plus) A		
(81-91) B		
(69-80) C		78
(55-68) D	53	
(39-54) E		
(21-38) F		
(1-20) G		
Not energy efficient - higher running costs		
England & Wales	EU Directive 2002/91/EC	