

Woodworth Grove, Keighley, BD21 5EB

£185,000

Council Tax Band: C



Nestled in the charming Woodworth Grove of Keighley, this delightful three-bedroom house is a true gem waiting to be discovered. Situated in a peaceful cul-de-sac, this property offers the perfect blend of tranquility and convenience.

One of the standout features of this lovely home is the private parking, the large garden is a green oasis, providing ample space for outdoor activities, gardening, or simply unwinding in the fresh air.

Whether you're looking to start a family, upgrade to a larger space, or simply enjoy the benefits of a spacious home, this property ticks all the boxes. Don't miss the opportunity to make this house your own and create lasting memories in this wonderful community.

This property briefly comprises of:



Keighley

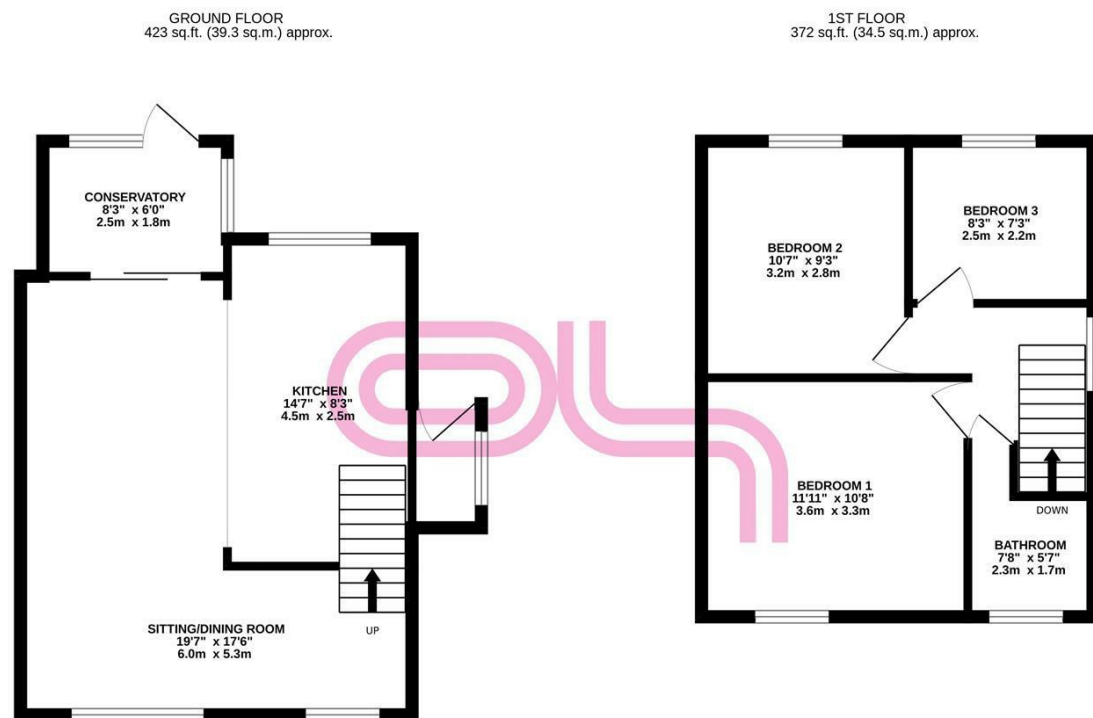

TOTAL FLOOR AREA: 795 sq.ft. (73.9 sq.m.) approx.

Whilst every attempt has been made to ensure the accuracy of the floorplan contained here, measurements of doors, windows, rooms and any other items are approximate and no responsibility is taken for any error, omission or mis-statement. This plan is for illustrative purposes only and should be used as such by any prospective purchaser. The services, systems and appliances shown have not been tested and no guarantee as to their operability or efficiency can be given.

Made with Metroplan ©2024

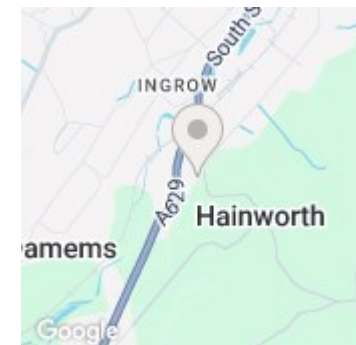

Energy Efficiency Rating		Current	Potential
Very energy efficient - lower running costs			
(92 plus) A			
(81-91) B			
(69-80) C			
(55-68) D			
(39-54) E			
(21-38) F			
(1-20) G			
Not energy efficient - higher running costs			
England & Wales	EU Directive 2002/91/EC		