

Goose Cote Way, Oakworth, Keighley, BD22 7NF

£199,950

Council Tax Band: C



We are pleased to offer to the market this well-maintained three bedroom semi-detached property that is located in the popular village of Oakworth. Situated close to local amenities, schools and transport links, this property would be perfect for a small family.

Viewings are advised to see all that this property has to offer.

This property briefly comprises of:



Keighley

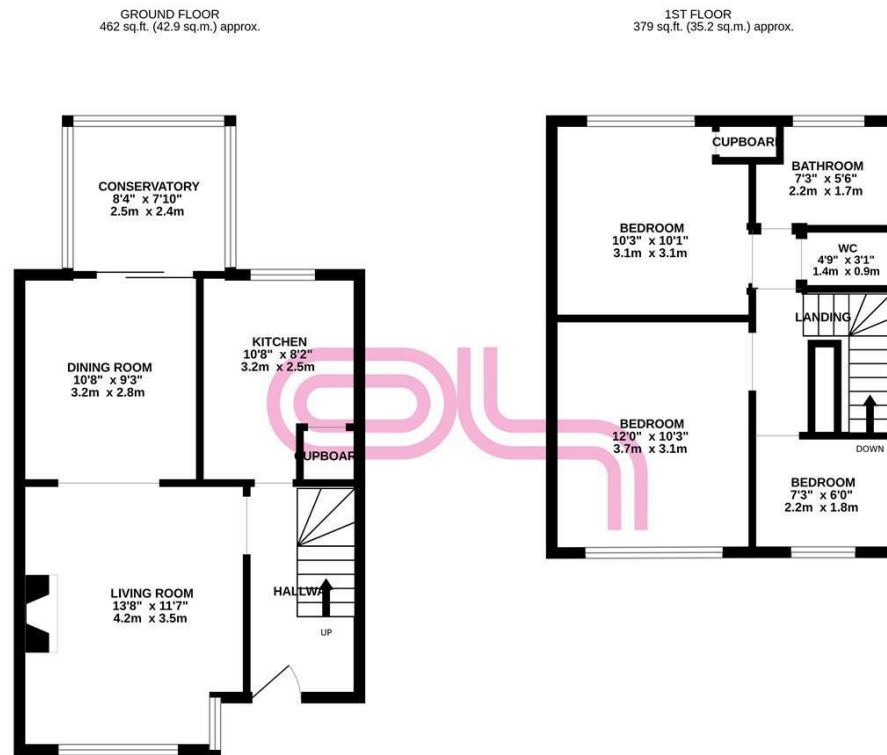

TOTAL FLOOR AREA: 841 sq.ft. (78.2 sq.m.) approx.

Whilst every attempt has been made to ensure the accuracy of the floorplan contained here, measurements of doors, windows, rooms and any other items are approximate and no responsibility is taken for any error, omission or mis-statement. This plan is for illustrative purposes only and should be used as such by any prospective purchaser. The services, systems and appliances shown have not been tested and no guarantee as to their operability or efficiency can be given.

Made with Metropix ©2024



Energy Efficiency Rating		
	Current	Potential
Very energy efficient - lower running costs		
(92 plus) <b>A</b>		
(81-91) <b>B</b>		
(69-80) <b>C</b>		
(55-68) <b>D</b>		
(39-54) <b>E</b>		
(21-38) <b>F</b>		
(1-20) <b>G</b>		
Not energy efficient - higher running costs		
<b>England &amp; Wales</b>	EU Directive 2002/91/EC	