



## Heene Road, Worthing



£325,000  
Leasehold

- Ground Floor Apartment
- Open Plan Lounge/Dining Room
- Bathroom and En-Suite
- EPC Rating - B (84)
- Council Tax Band - D
- Two Bedrooms
- Fitted Kitchen
- Communal Gardens
- Leasehold

Robert Luff and Co are delighted to offer to the market this beautifully presented ground floor over 55's apartment situated in Heene Road, close to town centre shops, restaurants, parks, the beach, bus routes and mainline station. Accommodation offers communal entrance hall, entrance hall, open plan lounge/dining area, fitted kitchen, two bedrooms one with en-suite and modern bathroom. Other benefits include allocated parking space, access to the communal gardens, private westerly aspect patio area.

T: 01903 331247 E: [info@robertluff.co.uk](mailto:info@robertluff.co.uk)  
[www.robertluff.co.uk](http://www.robertluff.co.uk)

**Robert  
Luff & Co**  
Sales | Lettings | Commercial





## Accommodation

### Communal Entrance Hall

Communal front door. Seating area. Front door leading to:

### Entrance Hall

Video telephone entry system. Spacious hallway. Underfloor heating. Thermostat. Dimmer switch. Door leading to:

### Utility Cupboard

Spacious cupboard with space and plumbing for washing machine. Storage shelf. Further storage area. Electric consumer unit.

### Open Plan Lounge/Dining Room 21'3 x 11'4 (6.48m x 3.45m)

L Shaped lounge area. Westerly aspect double-glazed sash style windows. Double-glazed french doors giving access to the westerly aspect patio. Thermostat. Underfloor heating. Throughway leading to:

### Kitchen 9'7 x 8'5 (2.92m x 2.57m)

A wide range of matching high gloss wall, base unit and pan drawers with contemporary glass handles. Worktop incorporating a one and half bowl stainless steel sink unit with mixer tap and drainer. Built in 'Bosch' oven. Integrated 'Bosch' ceramic four ring hob with extractor fan over. Glass splash backs. Fitted 'Bosch' microwave oven. Integrated fridge/freezer. Integrated dishwasher. Double-glazed window overlooking the rear garden. Tiled floor.

### Bedroom One 16'6 x 8'10 (5.03m x 2.69m)

Double-glazed south facing window. Thermostat. Underfloor heating. Mirror fronted sliding door wardrobe with space for hanging and shelves. Door leading to:

### En-Suite

Large walk in shower cubicle with fitted shower. Wash hand basin set into a vanity unit with mixer tap. Concealed system WC. Tiled splash backs. Tiled floor. Down lights. Heated towel rail.

### Bedroom Two 14 x 9'4 (4.27m x 2.84m)

Double-glazed window with southerly aspect. TV point. Thermostat. Underfloor heating. Large walk in cupboard housing 'Baxi' boiler. Further storage space.

### Bathroom

Panel enclosed bath with handles, mixer tap and shower attachment and glass shower screen. Concealed system WC. Wash hand basin set into vanity unit with mixer tap. Down lights. Heated towel rail. Tiled splash backs. Tiled floor.

### Outside

#### Private Patio Area

Marble tiled patio area with westerly aspect, nestled in the attractive communal gardens to the front of the building.

### Communal Gardens

Well manicured communal gardens. Allocated parking space.

### Tenure

Leasehold. 118 remaining on the lease. Ground rent £250 per annum. Maintenance approx £1300 every six months.



30 Guildbourne Centre, Worthing, West Sussex, BN11 1LZ

T: 01903 331247 E: [info@robertluff.co.uk](mailto:info@robertluff.co.uk)

[www.robertluff.co.uk](http://www.robertluff.co.uk)

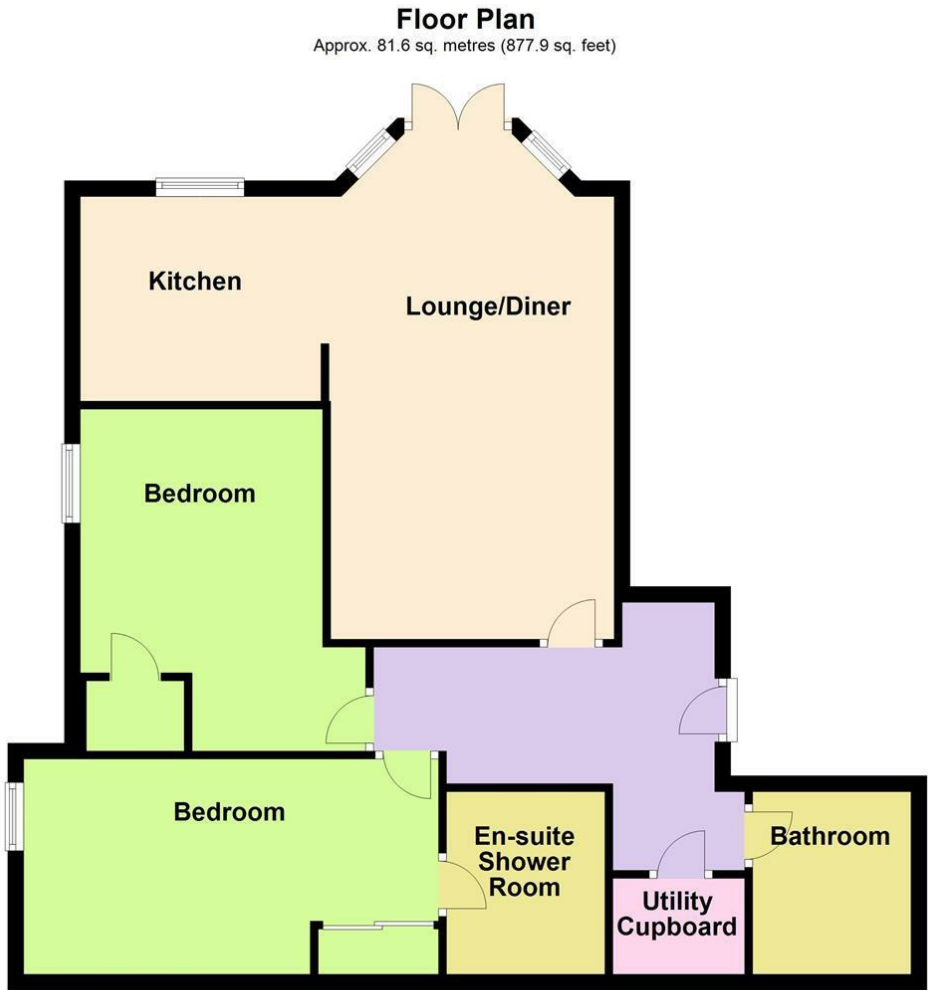

Energy Efficiency Rating	
Very energy efficient - lower running costs	CurrentPotential
(92 plus) A	
(81-91) B	8484
(69-80) C	
(55-68) D	
(39-54) E	
(21-38) F	
(1-20) G	
Not energy efficient - higher running costs	
England & Wales	EU Directive 2002/91/EC

Environmental Impact (CO <sub>2</sub> ) Rating	
Very environmentally friendly - lower CO <sub>2</sub> emissions	CurrentPotential
(92 plus) A	
(81-91) B	
(69-80) C	
(55-68) D	
(39-54) E	
(21-38) F	
(1-20) G	
Not environmentally friendly - higher CO <sub>2</sub> emissions	
England & Wales	EU Directive 2002/91/EC

The information provided about this property does not constitute or form any part of an offer or contract, nor may it be regarded as representations. All interested parties must verify accuracy and your solicitor must verify tenure/lease information, fixtures and fittings and, where the property has been extended/converted, planning/building regulation consents. All dimensions are approximate and quoted for guidance only as are floor plans which are not to scale and their accuracy cannot be confirmed. References to appliances and/or services does not imply that they are necessarily in working order or fit for the purpose.