

8A Balcombe Road, Peacehaven, BN10 7QZ

Leasehold

Asking Price £169,950



Are you looking for a first floor two double bedroom apartment with very low outgoings ?? This is a rare opportunity to acquire this spacious two bedroom first floor apartment with a service charge of only £300 per annum and a ground rent of only £10 per annum !! The apartment itself is in need of some modernisation but once complete would make a very spacious home or a profitable buy to let investment. You are granted access via a security communal entrance door into the communal entrance and a staircase leads to the first floor where the apartment is located. Upon entering the apartment you immediately go into the L shaped hallway which has a large built in cupboard . The two double bedrooms are at the rear and overlook the communal area, with the spacious lounge dining room and the kitchen are at the front affording a Southerly aspect, finishing off the accommodation is the family bathroom. To the rear of the building is ample communal parking.



206 South Coast Road  
Peacehaven  
East Sussex  
BN10 8JP  
01273 830 987  
bnsales@localagent.co.uk

www.openhousebrighton.co.uk

## Outgoings

Service Charge £300 per annum

## Communal Entrance hallway

## Apartment Entrance hallway

## Living Room

18'4" x 11'7" (5.60 x 3.55)

## Kitchen

11'7" x 9'9" (3.55 x 2.99)

## Bedroom 1

10'8" x 11'10" (3.27 x 3.61)

## Bedroom 2

6'6" x 9'6" (1.99 x 2.91)

## Bathroom

6'4" x 4'6" (1.94 x 1.38)

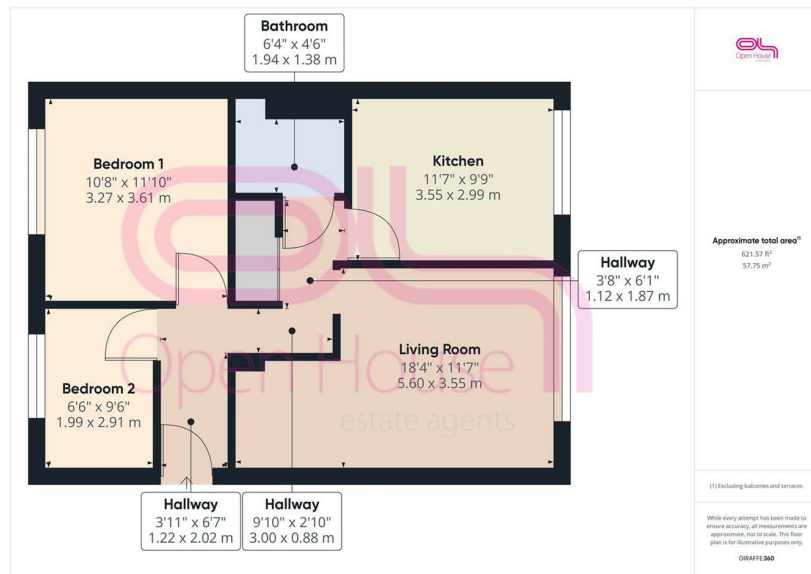

Energy Efficiency Rating		Environmental Impact (CO <sub>2</sub> ) Rating	
Current	Potential	Current	Potential
Very energy efficient - lower running costs		Very environmentally friendly - lower CO <sub>2</sub> emissions	
(92 plus) <b>A</b>		(92 plus) <b>A</b>	
(81-91) <b>B</b>		(81-91) <b>B</b>	
(69-80) <b>C</b>		(69-80) <b>C</b>	
(55-68) <b>D</b>		(55-68) <b>D</b>	
(39-54) <b>E</b>		(39-54) <b>E</b>	
(21-38) <b>F</b>		(21-38) <b>F</b>	
(1-20) <b>G</b>		(1-20) <b>G</b>	
Not energy efficient - higher running costs		Not environmentally friendly - higher CO <sub>2</sub> emissions	
England & Wales	EU Directive 2002/91/EC	England & Wales	EU Directive 2002/91/EC