



Radcliffe & Rust are delighted to offer, for sale, this Victorian terraced property. In need of general moderation throughout this is an ideal opportunity to put your own stamp on a period property located in the highly sought after area. The property has the added benefit of being sold with no onward chain so call or email us now to arrange your viewing.





Ground Floor

Approx. 46.9 sq. metres (505.3 sq. feet)

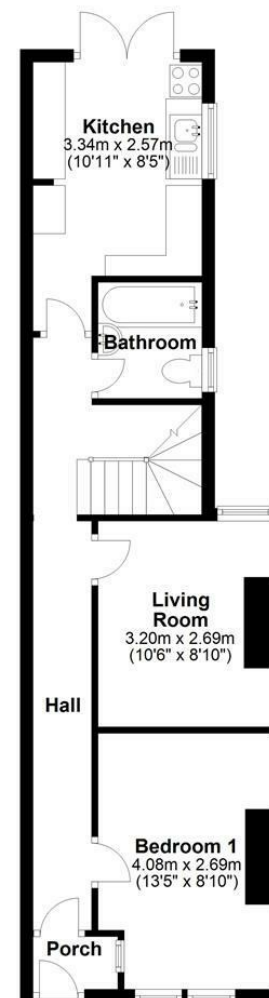

First Floor

Approx. 38.2 sq. metres (411.0 sq. feet)

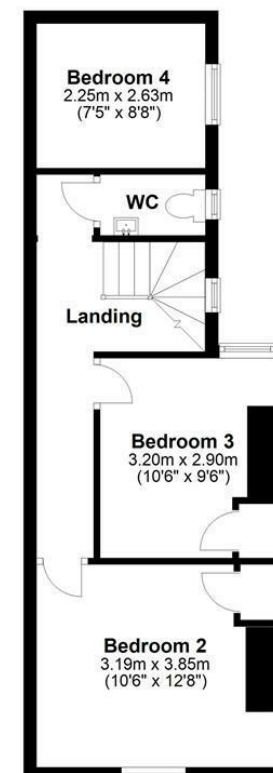

Total area: approx. 85.1 sq. metres (916.3 sq. feet)

Drawings are for guidance only
Plan produced using PlanUp.

Energy Efficiency Rating	
Current	Potential
Very energy efficient - lower running costs	
(92 plus) A	89
(81-91) B	
(69-80) C	
(55-68) D	69
(39-54) E	
(21-38) F	
(1-20) G	
Not energy efficient - higher running costs	
England & Wales	
EU Directive 2002/91/EC	

