



Walmer Gardens, Sittingbourne

PCM £1,350 PCM

Key Features

- **AVAILABLE NOW!!!!**
- **Three Bedroom Mid Terrace House**
- **Good Sized Lounge and Kitchen**
- **Refurbished throughout**
- **Close to Town Centre**
- **Council Tax Band B**
- **EPC D (64)**
- **Deposit - £1269**
- **Holding fee - £253**
- **CALL NOW TO VIEW!**

Property Summary

THREE BEDROOM MID TERRACE PROPERTY WITH ENCLOSED REAR GARDEN IN CONVENIENT CUL DE SAC CLOSE TO TOWN. Situated on a quiet walkway this well proportioned house features good sized living room, kitchen, three bedrooms and a family bathroom. Externally there is an enclosed rear garden to the rear. Walmer Gardens is situated in the catchment area for a variety of schools (both secondary and primary) and is close to the town centre, the mainline railway station providing regular services to London. Demand is expected to be high due to the location and size on offer and as such an early call is advised to avoid disappointment. CALL NOW TO VIEW!





GROUND FLOOR
315 sq.ft. (29.3 sq.m.) approx.

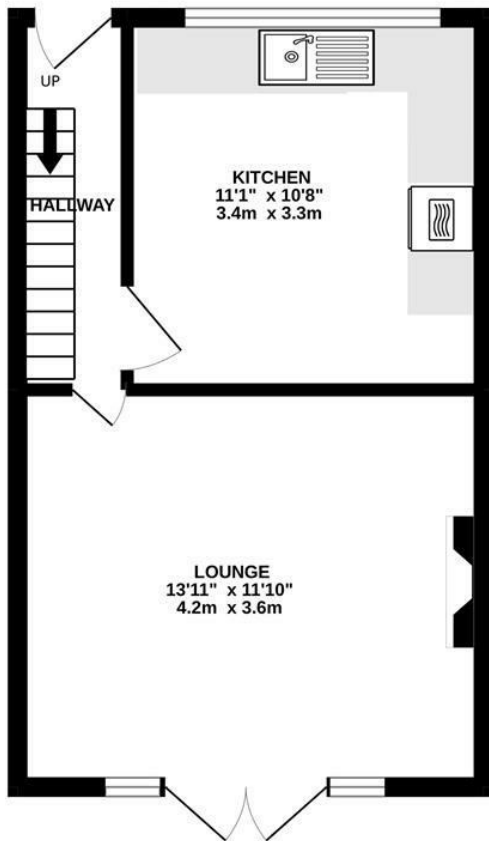

1ST FLOOR
295 sq.ft. (27.4 sq.m.) approx.

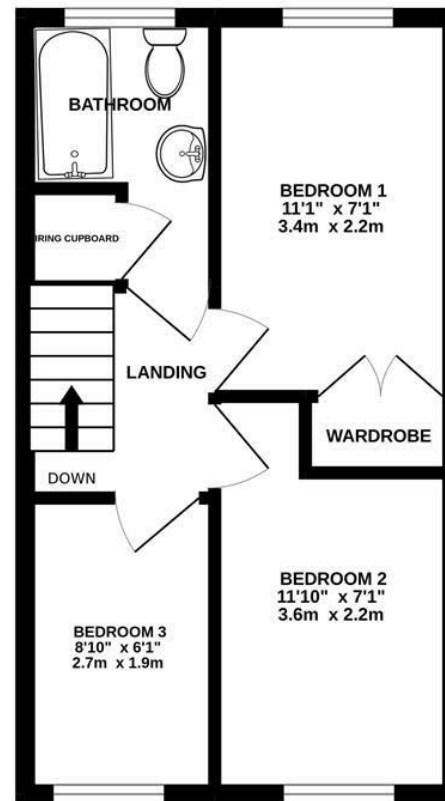

TOTAL FLOOR AREA : 610 sq.ft. (56.7 sq.m.) approx.

Whilst every attempt has been made to ensure the accuracy of the floorplan contained here, measurements of doors, windows, rooms and any other items are approximate and no responsibility is taken for any error, omission or mis-statement. This plan is for illustrative purposes only and should be used as such by any prospective purchaser. The services, systems and appliances shown have not been tested and no guarantee as to their operability or efficiency can be given.
Made with Metropix ©2022

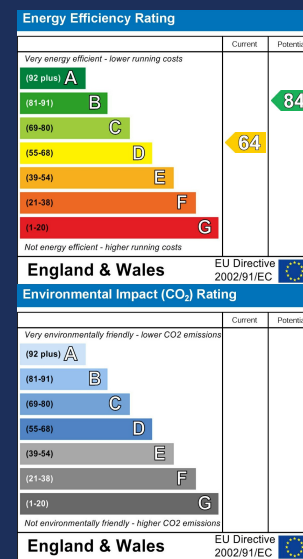

Lamborn & Hill have produced these details in good faith and believe they provide a fair and accurate description of the property being marketed. Following inspection and prior to financial commitment prospective buyers should satisfy themselves as to the property's suitability and make their own enquiries, relating to specific points of importance for example condition of items, permissions, approvals and regulations. The accuracy of these details are not guaranteed and they do not form part of any contract.