



Dyngley Close,
PCM £1,300 PCM

Key Features

- Available end of May
- 2 Bedroom Property
- Quiet Cul De Sac Location
- Allocated Parking for 1 Vehicle
- EPC Rating C (69)
- Call Now to View!
- Front & Rear Gardens

Property Summary

New to the market is this well presented two bedroom house on Dyngley Close. The property is available on a long term let and is ideal for a professional couple. There is a good sized living room and Kitchen/Breakfast room and upstairs there are two bedrooms and a shower room. Externally there is front & rear gardens, a garage en-bloc and allocated parking for 1 vehicle.



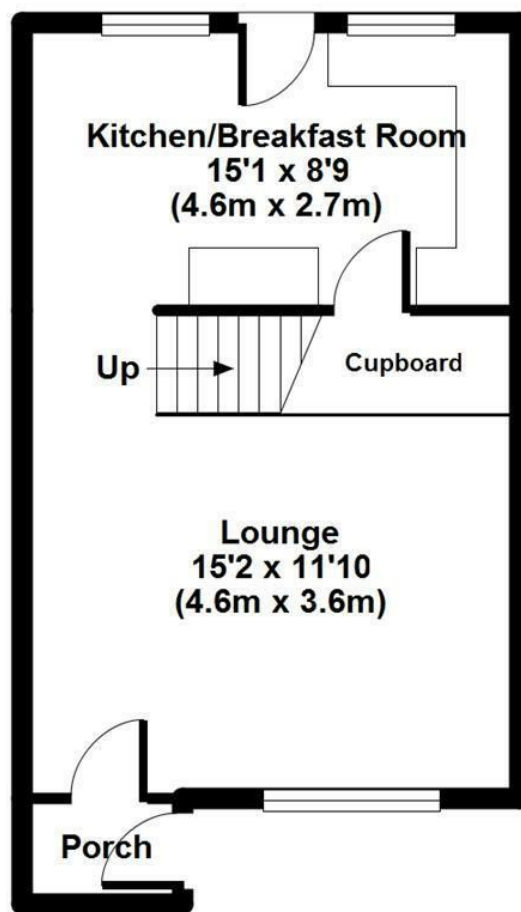

Ground Floor

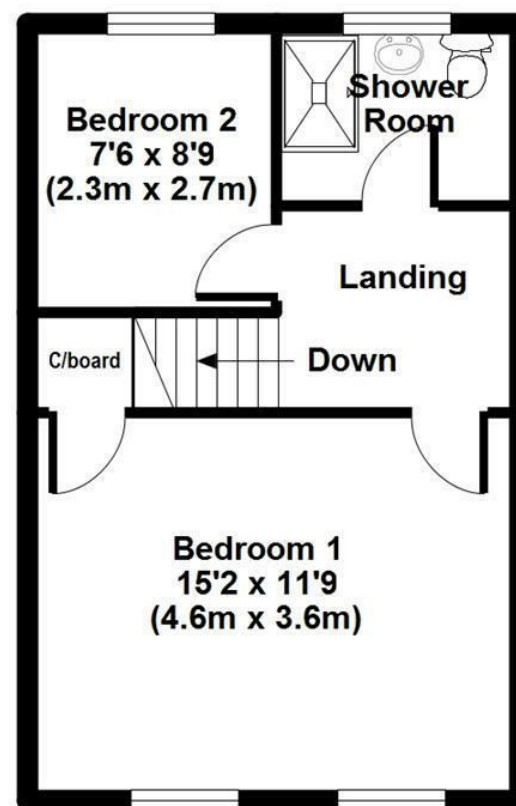

First Floor

APPROX GROSS INTERNAL FLOOR AREA: 728 sq. ft / 68 sq. m

Dyngley Close

FOR ILLUSTRATIVE PURPOSES ONLY. NOT TO SCALE

Whilst every attempt has been made to ensure the accuracy of the floor plan shown, all measurements, positioning, fixtures, features, fittings and any other data shown are an approximate interpretation for illustrative purposes only and are not to scale. No responsibility is taken for any error, omission, miss-statement or use of data shown.

The above statement applies to both 'The Floor Plan People' and the Estate Agent marketing this property.

(c) THE FLOOR PLAN PEOPLE unauthorised reproduction prohibited.

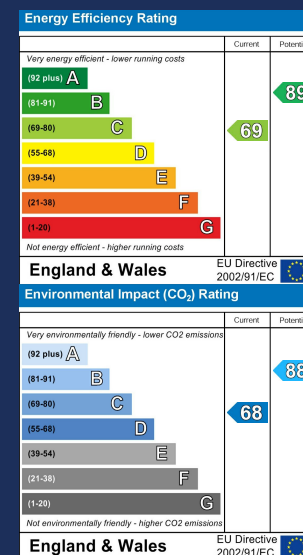

Lamborn & Hill have produced these details in good faith and believe they provide a fair and accurate description of the property being marketed. Following inspection and prior to financial commitment prospective buyers should satisfy themselves as to the property's suitability and make their own enquiries, relating to specific points of importance for example condition of items, permissions, approvals and regulations. The accuracy of these details are not guaranteed and they do not form part of any contract.

19-21 West Street, Sittingbourne, Kent, ME10 1AJ

T: 01795 293000

sittingbourne@lambornhill.com

www.lambornhill.com