



Vicarage Crescent, SW11
£599,950

Waterview

A bright and beautifully presented three double bedroom apartment set in the heart of Battersea overlooking The Thames in this secure gated development with parking.

Archer House is located on the riverside at Battersea, a stone's throw from the restaurants and cafés of Battersea Square.





Accommodation is made up of entrance hall leading to a bright and spacious reception room overlooking The Thames, three large double bedrooms, two with stunning river views. There is also a fitted kitchen, a bathroom and separate W.C.

The building is lift serviced, and has a beautiful private courtyard which is only accessible for residents

Features

Riverside Apartment
Three Double Bedrooms
Gated Development
Parking Available
Beautiful Views
Share of Freehold



Vicarage Crescent, Battersea, SW11

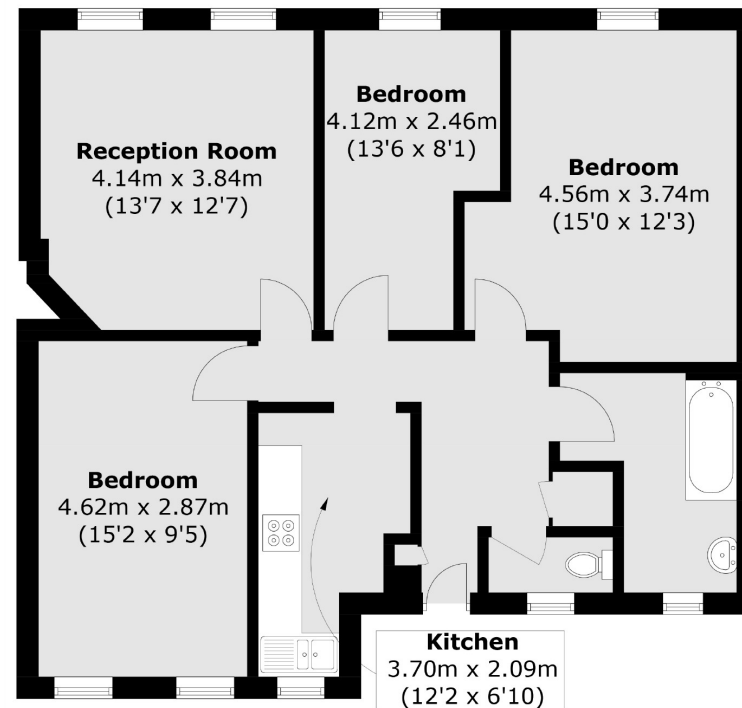

Total area (approx.): 78.3 sq. m (842.8 sq. ft)

Contact

To arrange a viewing call our office on the number below or visit our website.



Energy Rating: C. We aim to make our particulars both accurate and reliable. However they are not guaranteed; nor do they form part of an offer or contract. If you require clarification on any points then please contact us, especially if you're traveling some distance to view. Please note that appliances and heating systems have not been tested and therefore no warranties can be given as to their good working order.

