



Harry Zeital Way, E5

£490,000

A two bedroom apartment with unobstructed views of the River Lea and Walthamstow Marshes from every room. The property offers open plan living with floor to ceiling windows and large private balcony. The building has secure entry, lift access and secure bike storage. It is being sold chain free.

Dockside Court is located down a cul-de-sac on the edge of North Millfields and the River Lea. The apartment is just over half a mile to Clapton Overground Station and Chatsworth Road with its Sunday market and many shops and cafes.

Features

- Two Bedrooms
- Balcony with Canal Views
- Open Plan
- Lift Access
- Secure Entry
- Chain Free

Harry Zeital Way, London, E5

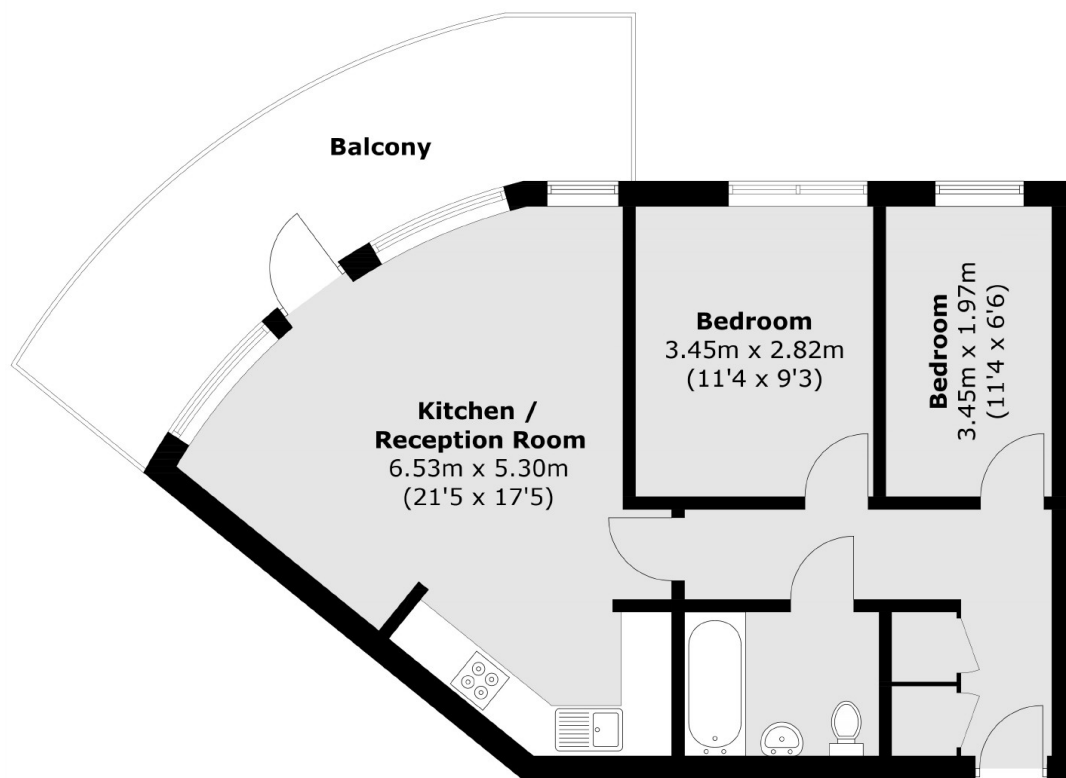

Total area (approx.): 56.2 sq. m (604.9 sq. ft)
Balcony area (approx.): 15.5 sq. m (166.8 sq. ft)