



Carlyle Court, SW10
£850,000

Waterview

A lovely, stylish raised-ground floor apartment comprising two double bedrooms and two bathrooms which has been recently refurbished in sleek, contemporary style. The property benefits from a generous reception and a striking, modern kitchen.

Chelsea Harbour is an iconic riverside development by The Thames located off Lots Road.





Accommodation is made up of entrance hallway through to a beautifully presented double reception room with double doors to private balcony and breakfast bar to kitchen. The stylish, well appointed kitchen has granite work tops. The principal bedroom has en-suite there is a further double bedroom and family bathroom. There is a secure underground parking space and the block benefits from lift service and an excellent concierge service.

Features

- Beautiful Apartment
- Two Double Bedrooms
- Two Bathrooms
- Private Balcony
- Secure Parking
- Excellent Concierge



Carlyle Court, Chelsea Harbour, SW10

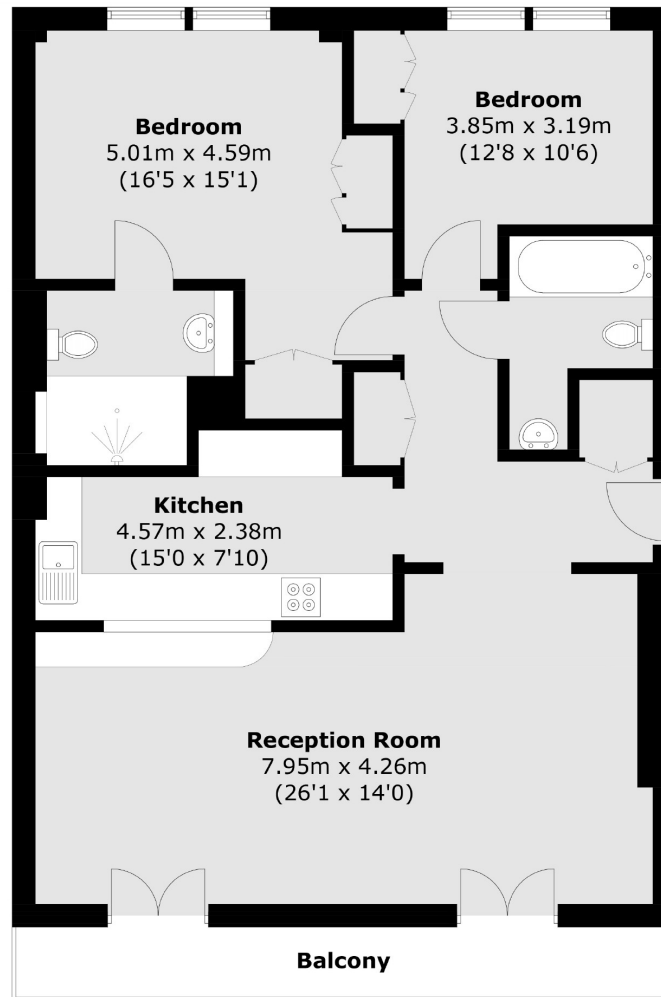

Total area (approx.): 89.9 sq. m (967.7 sq. ft)
Balcony: 7.6 sq. m (81.8 sq. ft)

Contact

To arrange a viewing call our office on the number below or visit our website.



Energy Rating: D. We aim to make our particulars both accurate and reliable. However they are not guaranteed; nor do they form part of an offer or contract. If you require clarification on any points then please contact us, especially if you're traveling some distance to view. Please note that appliances and heating systems have not been tested and therefore no warranties can be given as to their good working order.

