



£1,450 PCM

28 Aqua, Poole, Dorset, BH15 1LS

www.quayliving.co.uk



Quay Living are delighted to offer this Waterfront two bedroom apartment. Part of the contemporary Aqua development located directly fronting the inner Harbour area, this third floor apartment benefits from lovely views over the harbour towards the Purbeck Hills.

The property comprises of an open plan living and dining area, a separate modern kitchen with all integrated appliances, two balconies both with stunning views, two double bedrooms with an en-suite shower room to the master bedroom and also a family bathroom with shower over bath. Further benefits include allocated parking in a secure gated car park, lift access and video phone entry system.

This beautiful property is being offered on a furnished basis and is available from the 9th November!!

EPC - B

Council Tax - E

Please call or email Quay Living Estate Agents for you appointment to view!!





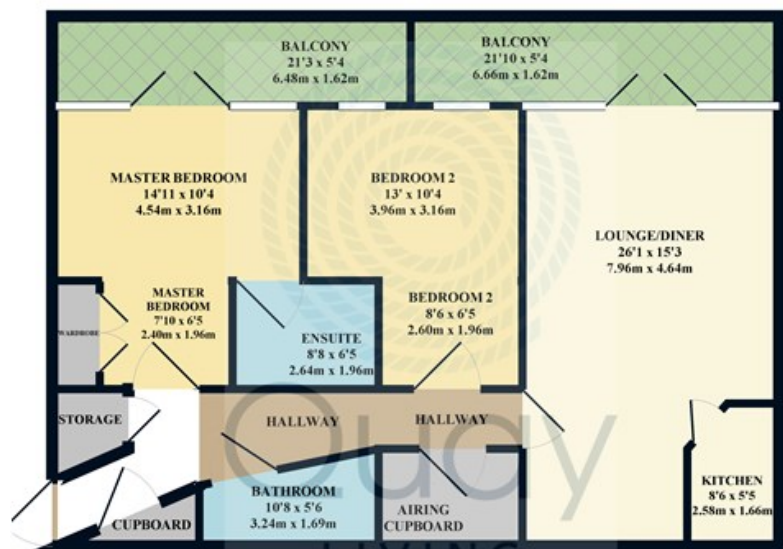

TOTAL APPROX. FLOOR AREA 1082 SQ.FT. (100.5 SQ.M.)
 Measurements are approximate. Not to scale. Illustrative purposes only.
 Made with Metropix ©2019

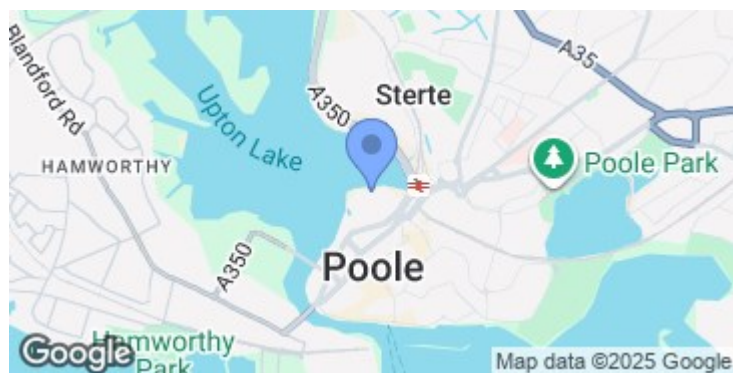

Energy Efficiency Rating		
	Current	Potential
Very energy efficient - lower running costs		
(92 plus) A		
(81-91) B		
(69-80) C		
(55-68) D		
(39-54) E		
(21-38) F		
(1-20) G		
Not energy efficient - higher running costs		
England & Wales	83	84
	EU Directive 2002/91/EC	



Agent Note: Whilst every care has been taken to prepare these sales particulars, they are for guidance purposes only. All representations including descriptions, dimensions and photos are given, in good faith and are believed to be correct, but any intending purchaser should not rely on them as statements or representations of fact but must satisfy themselves as to their correctness. Appliances and central heating systems have not been checked by Quay Living or their employees and we recommend that purchasers instruct a qualified person to check all appliances / service before legal commitment.



01202 683444
 Orchard Plaza, 41 High Street
 Poole, Dorset, BH15 1EG
www.quayliving.co.uk

