



Apartment

FLAT 5 SINCLAIR COURT PASCOE CLOSE, POOLE, BH14 0NU

Per Month

£1,350

FEATURES

- Two Bedroom Apartment
- Close to Ashley Cross
- Redecorated with New Carpeting Throughout
- New Bathroom Suite
- Front Facing Balcony
- Quiet Cul De Sac Location



2 Bedroom Apartment located in Poole

Quay Living are delighted to offer this first floor two-bedroom purpose-built apartment, situated within a quiet cul de sac and being within a few minutes' walk of Ashley Cross, boasting proximity of bus routes to Poole and Bournemouth plus Parkstone station.

The property has recently been redecorated and carpeted to include a new bathroom suite and offers light and spacious accommodation with UPVC double glazing, front facing balcony and garage.

The accommodation comprises of a large reception room with sunny aspect balcony, fitted kitchen and two good size bedrooms, family bathroom with bath and separate shower.

The property is available NOW on an unfurnished basis.

Call us on
01202 683 444
info@quayliving.co.uk
<https://www.quayliving.co.uk/>

Council Tax Band
C

FIRST FLOOR

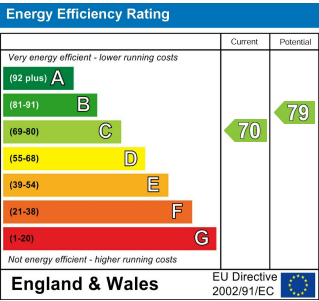
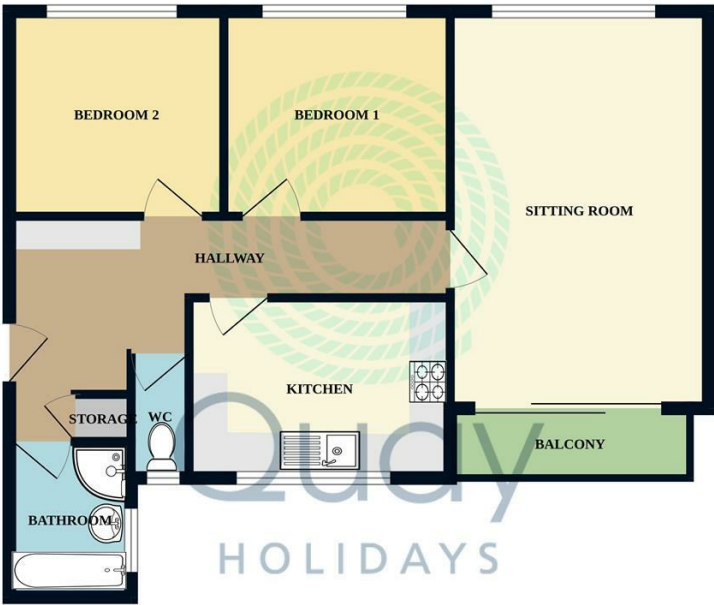

Agents Note: Whilst every care has been taken to prepare these particulars, they are for guidance purposes only. All measurements are approximate and are for general guidance purposes only and whilst every care has been taken to ensure their accuracy, they should not be relied upon and potential buyers are advised to recheck the measurements.



Measurements are approximate. Not to scale. Illustrative purposes only.
Made with Metreplex ©2025