



Redmayne Arnold & Harris
estate agents, letting agents & surveyors

rah.co.uk



TO LET



1 Woodhouse Farm, Cambridge Road, Impington, Cambridgeshire, CB24 9PU

£1,500 PCM

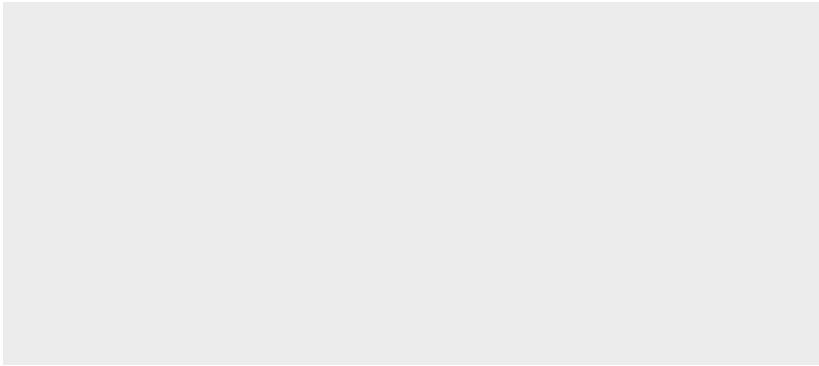

THE PROPERTY

A Victorian semi detached property situated on a private driveway off the Histon Road on the outskirts of the City of Cambridge. The property comprises entrance hall, living room, kitchen/breakfast room, three bedrooms and first floor bathroom. The property also benefits from off street parking for several cars.

EPC Rating - E
 Council Tax Band - C
 Minimum tenancy length 12 months.
 Deposit £1730
 Holding Deposit: £346

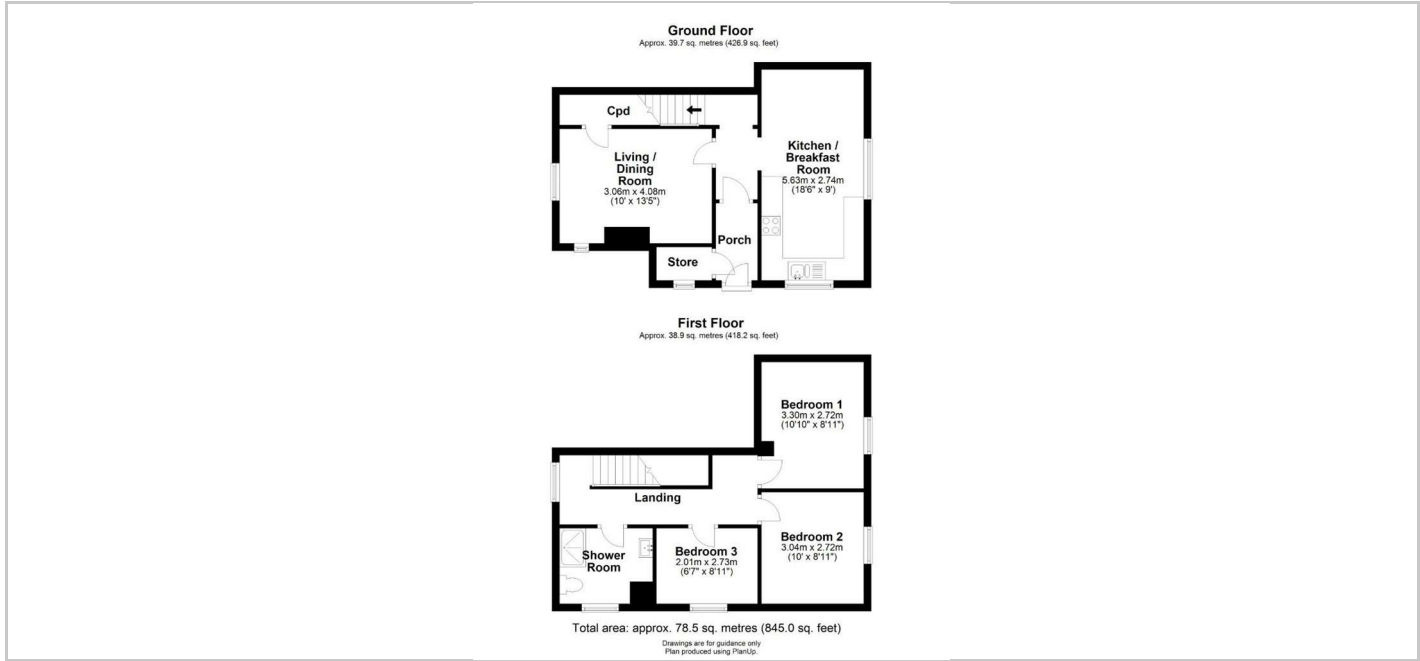

Directions

SITUATION

