



Redmayne Arnold & Harris
estate agents, letting agents & surveyors

rah.co.uk



TO LET



35 City Road, Cambridge, CB1 1DP

£2,200 PCM

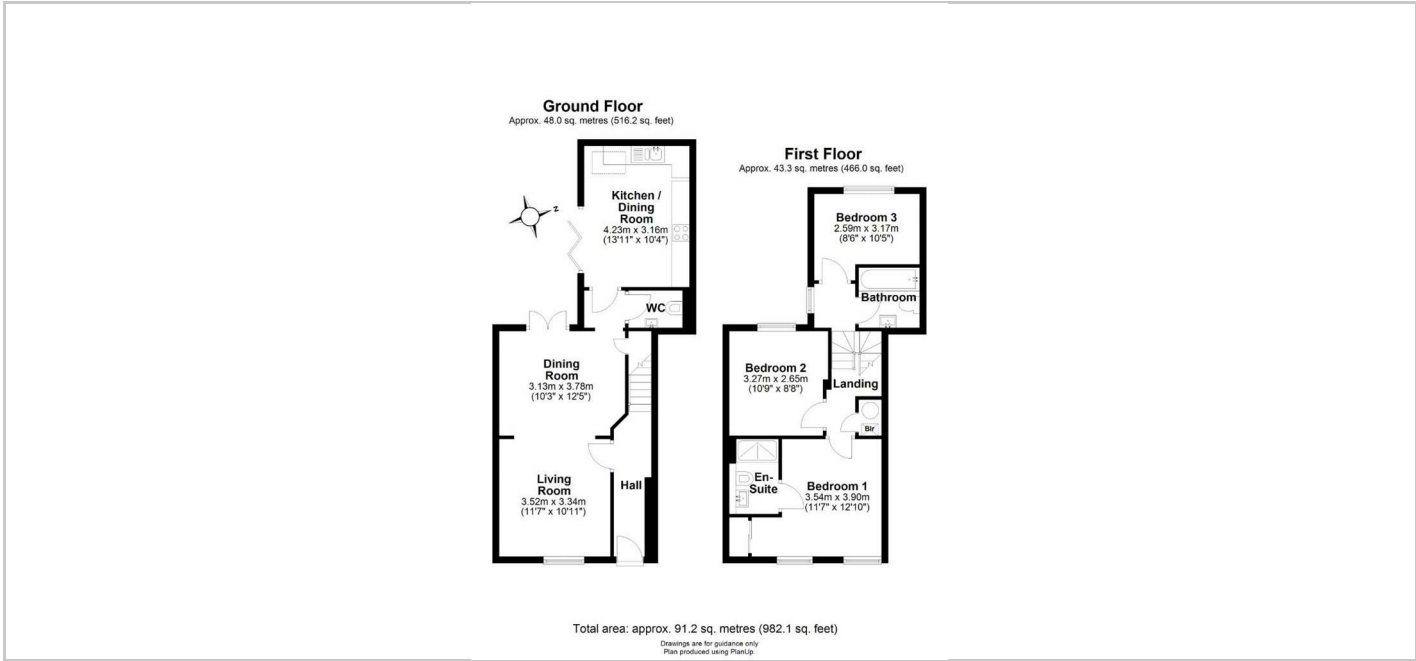

Directions

THE PROPERTY

A fantastically located 3 bed house in the heart of the city centre. Property comprises entrance hall, one ground floor double bedroom, kitchen with seating area, WC, two first floor double bedrooms and bathroom. Garden to rear of the property. This property is managed by RAH.

- EPC Rating: C
- Council tax band E.
- Deposit £2530
- Holding Deposit: £390
- Minimum 12 month tenancy

SITUATION

