



Redmayne Arnold & Harris
estate agents, letting agents & surveyors

rah.co.uk



TO LET



11 Wheelers, Great Shelford, Cambridge, CB22 5UD

£1,300 PCM

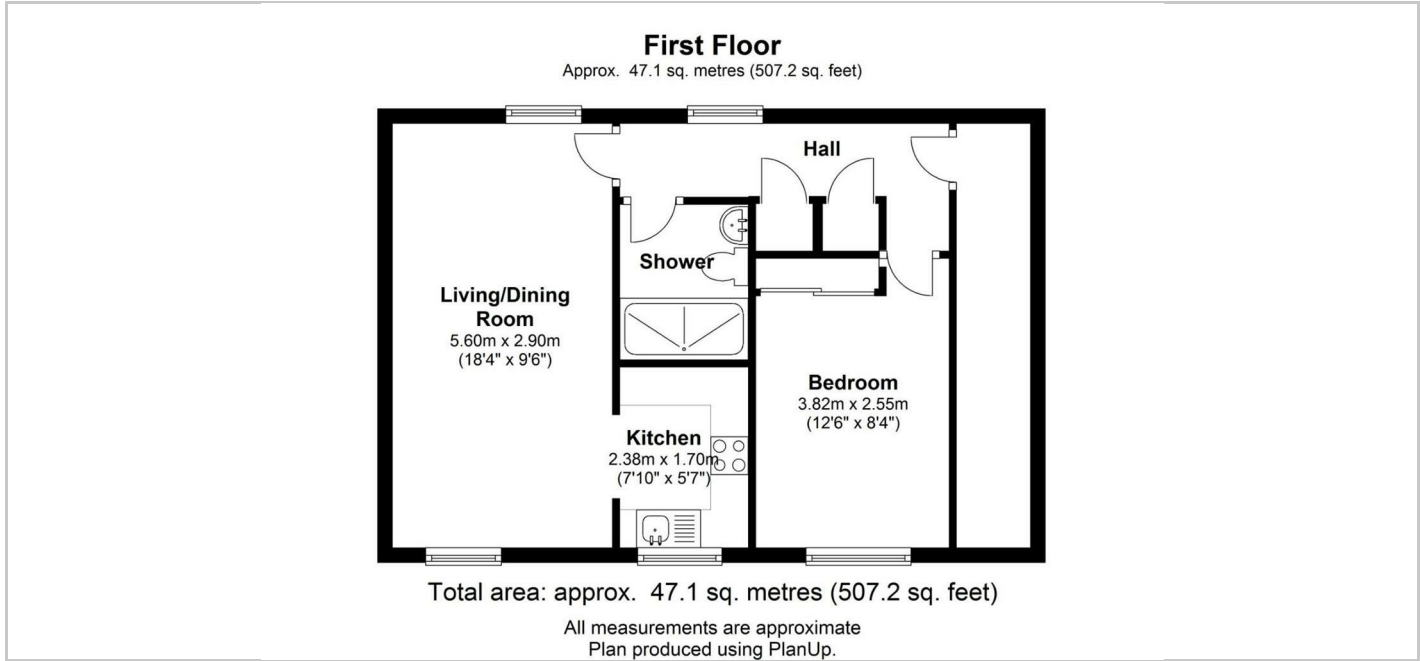
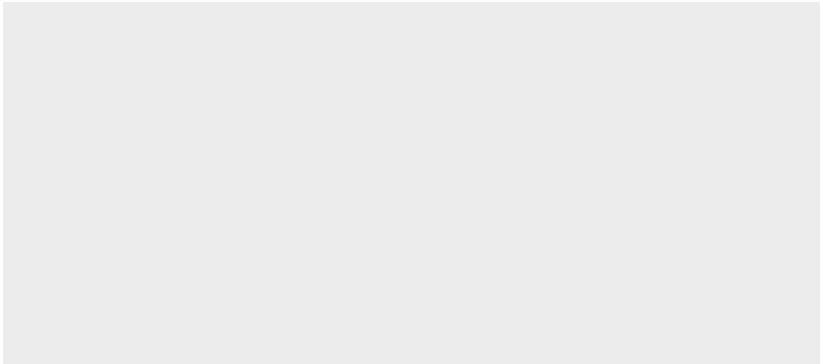

Directions

THE PROPERTY

A one bed, first floor furnished apartment within easy walking distance of Great Shelford railway station and conveniently located for access to the Shelford and Addenbrookes cycle way. The property has recently been refurbished and comprises entrance hall, living/dining room, kitchen, double bedroom with built-in wardrobes and shower room. The property will be managed by RAH.

- Council Tax Band - B.
- EPC Rating - D.
- Deposit £1500.
- Minimum tenancy length 12 months.
- Holding Deposit: £300

SITUATION

