



Redmayne Arnold & Harris  
estate agents, letting agents & surveyors

rah.co.uk



TO LET



161 Cherry Hinton Road, Cambridge, CB1 7BX

£1,750 PCM



### THE PROPERTY

A well-presented three bedroom mid-terraced house, which offers excellent access to Addenbrookes, railway station and local shops. The property comprises entrance hall, living room, dining room, kitchen and family bathroom. Upstairs are 2 double bedroom and a further single room at the rear. The property is managed by RAH.

- EPC Rating: E
- Council Tax Band: D
- Minimum 6 Month Tenancy
- Deposit: £2015
- Holding Deposit: £403

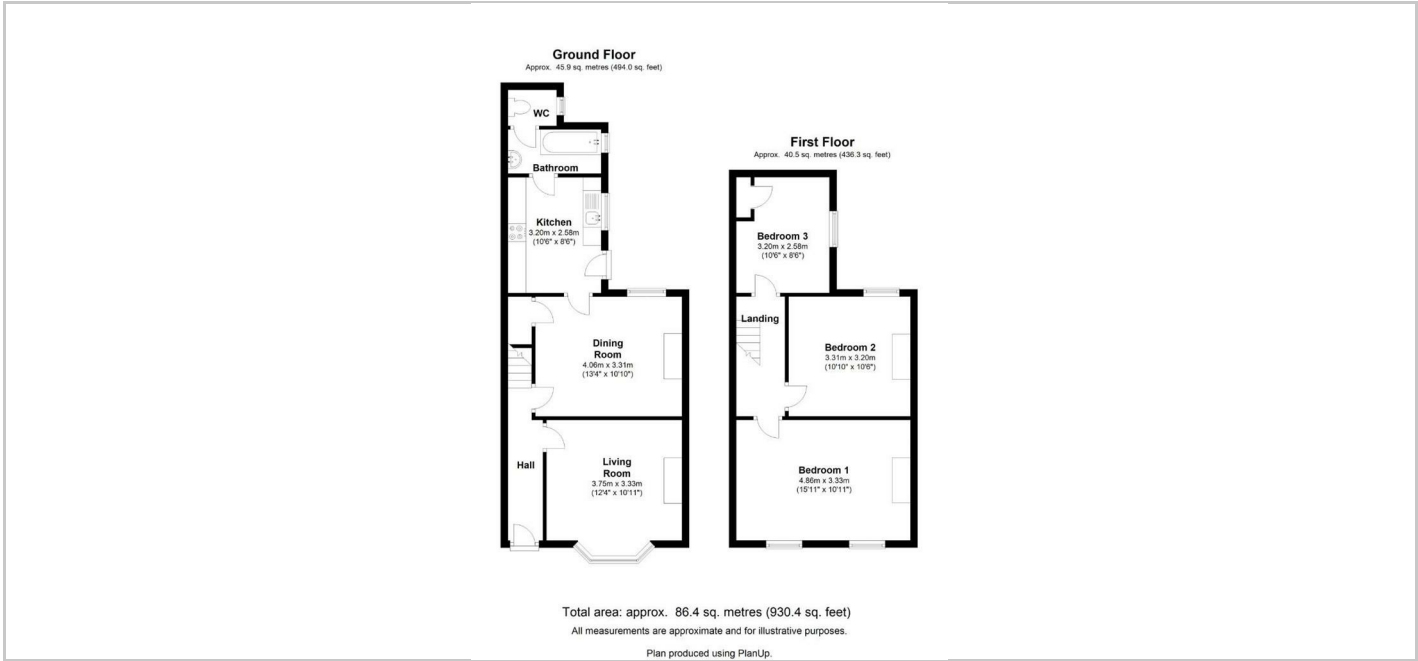

### SITUATION

### Directions

